

1000



120840

Bartscher GmbH
Franz-Kleine-Str. 28
D-33154 Salzkotten
Germany

Phone: +49 5258 971-0

Fax: +49 5258 971-120

Technical Support Hotline: +49 5258 971-197

www.bartscher.com



Version: 1.0

Date of preparation: 2023-09-21

Original instruction manual

1	Safety	2
1.1	Explanation of Signal Words	2
1.2	Safety instructions.....	3
1.3	Intended Use	5
1.4	Unintended Use	5
2	General information	6
2.1	Liability and Warranty	6
2.2	Copyright Protection	6
2.3	Declaration of Conformity	6
3	Transport, Packaging and Storage	7
3.1	Delivery Check.....	7
3.2	Packaging	7
3.3	Storage	7
4	Technical Data.....	8
4.1	Technical Specifications	8
4.2	Functions of the Appliance.....	8
4.3	List of Components of the Appliance	9
5	Installation and operation	10
5.1	Installation.....	10
5.2	Operation	12
6	Cleaning and Maintenance	16
6.1	Safety Instructions for Cleaning	16
6.2	Cleaning.....	16
6.3	Maintenance	17
7	Disposal.....	18



Read this instruction manual before using and keep it available at all times!

This instruction manual contains information about installation, operation and maintenance of the appliance and constitutes an important source of information and reference guide. The knowledge of all operational and safety instructions included in this manual is a prerequisite for safe and proper handling of the appliance. Additionally, accident prevention, occupational health and safety, and legal regulations in force in the area the appliance is used apply.

Before you start using the appliance, especially before turning it on, read this instruction manual in order to avoid personal injuries and property damages. Improper use may cause damage.

This instruction manual forms an integral part of the product and must be stored in an immediate vicinity of the appliance and be available at all times. The instruction manual should be transferred together with the appliance.

1 Safety

This appliance has been manufactured in accordance with technical standards currently in force. However, the appliance may be a source of hazards if used improperly or contrary to its intended purpose. All persons using the appliance must consider information included in this instruction manual and observe safety instructions.

1.1 Explanation of Signal Words

Important safety instructions and warning information are indicated in this instruction manual with appropriate signal words. You must strictly follow the instructions, to prevent accidents, personal injuries and property damages.



DANGER!

The signal word **DANGER** warns against hazards that lead to severe injuries or death if the hazards are not avoided.



WARNING!

The signal word **WARNING** warns against hazards that may lead to moderate or severe injuries or death if the hazards are not avoided.



CAUTION!

The signal word **CAUTION** warns against hazards that may lead to light or moderate injuries if the hazards are not avoided.

IMPORTANT!

The signal word **IMPORTANT** indicates possible property damages, which may occur if safety instructions are not observed.

NOTE!

The symbol **NOTE** indicates subsequent information and guidelines for the user on usage of the appliance.

1.2 Safety instructions

Electrical Current

- Too high a mains voltage or incorrect installation may cause electric shock.
- The appliance may be connected only if data on the rating plate correspond with the mains voltage.
- To avoid short-circuit, the appliance should be kept dry.
- If there are malfunctions during operation, disconnect the appliance from the power supply.
- Do not touch the appliance's plug with wet hands.
- Never take hold of the appliance if it has fallen into water. Immediately disconnect the appliance from the power supply.
- Any repairs or housing opening may be carried out by professionals and relevant workshops only.
- Do not transport the appliance, holding it by the power cord.
- Do not allow the power cord to come into contact with heat sources or sharp edges.
- Do not bend, pinch nor knot the power cord.

- Always completely unwind the power cord.
- Never place the appliance or other objects on the power cord.
- Always take hold of the plug to disconnect the appliance from the power supply.
- Check the power cord regularly for damage. Do not use the appliance if the power cord is damaged. If this cable is damaged, it must be replaced by customer service or a qualified electrician in order to avoid dangers.

Operating Personnel

- The appliance may only be operated by qualified personnel and trained specialist personnel.
- This appliance may not be operated by persons (including children) with limited physical, sensory or mental capabilities, nor by persons with limited experience and/or limited knowledge.
- Children should be supervised to ensure that they are not playing with or switching on the appliance.

Supervised Usage only

- Only supervised appliance may be used.
- Always remain in an immediate vicinity of the appliance.

Improper Use

- Unintended or prohibited use may cause damage to the appliance.
- The appliance may only be used when its technical condition is flawless and allows for safe operation.
- The appliance may only be used when all connections are executed according to rules of law in force.
- The appliance may only be used when it is clean.
- Use only original spare parts. Never attempt to repair the appliance on your own.
- Do not introduce any changes in the appliance nor modify it.

1.3 Intended Use

As described below, every use of the appliance for a purpose differing and/or diverging from its intended standard use, is prohibited and considered to be an unintended use.

The following is an intended use:

- Chopping meat and vegetables.

1.4 Unintended Use

An unintended use may lead to personal injuries or property damages caused by hazardous voltage, fire or high temperature. The appliance may only be used to perform tasks described in this instruction manual.

The following is an unintended use:

- Chopping unsuitable food products.

2 General information

2.1 Liability and Warranty

All information and instructions in this instruction manual account for legal regulations in force, current level of technical engineering knowledge as well as our expertise and experience, developed over the years. If special models or additional options are ordered, or state-of-the-art technical solutions were implemented, the actual scope of delivery of the appliance may, in some circumstances, differ from descriptions and numerous drawings in this instruction manual.

The manufacturer is not liable for any damages nor faults stemming from:

- failure to observe instructions,
- unintended use,
- technical alterations introduced by the user,
- usage of unapproved spare parts.

We reserve the right to introduce technical modifications to the product, intended for improvement of the appliance and its performance.

2.2 Copyright Protection

This instruction manual, and texts, drawings and images included in it, as well as its other components are copyright protected. It is prohibited to reproduce this instruction manual (including its excerpts), in any form and by any means, and to use and/or transfer its content to third parties without manufacturer's written permission. Violation of the above results in obligation to pay compensation. We reserve the right to claim further damages.

2.3 Declaration of Conformity

The appliance meets the currently applicable standards and guidelines of the European Union. We confirm the above in the EC Declaration of Conformity. We may provide relevant Declaration of Conformity upon request.

3 Transport, Packaging and Storage

3.1 Delivery Check

Immediately upon reception, check the delivery for completeness and possible shipping damage. In the case of visible transport damage refuse to accept the appliance or accept it conditionally. Mark and note the scope of damage in shipping documents/consignment list of the shipping company and lodge a complaint. Concealed damage must be reported immediately upon its discovery, as compensation claims may only be filed within applicable time limits.

If you find that parts or accessories missing, please contact our Customer Service Department.

3.2 Packaging

Do not dispose of the appliance cardboard box. It may be used to store the appliance when relocating or when shipping the appliance to our service point in the case of any damages.

The packaging and its elements are made of recyclable materials. Particularly, these are: plastic films and bags, cardboard box.

When disposing of the packaging, observe applicable domestic regulations. Recyclable packaging materials should be recycled.

EN

3.3 Storage

Leave the packaging closed until installation of the appliance; observe external indications concerning method of placing and storage. Store the packaging in the following conditions only:

- in closed rooms;
- in dry and dust-free surrounding;
- away from aggressive agents;
- in a location protected against sunlight;
- in a location protected against mechanical shocks.

In the case of extended storage (over three months), make sure you check the condition of the packaging and the parts regularly. If needed, replace the packaging with a new one.

4 Technical Data

4.1 Technical Specifications

Name:	Cutter 1000
Art. No.:	120840
Material:	stainless steel, plastic
Volume, in l:	6
Maximum rotational speed, in RPMs:	2.100
Diameter of filling shaft, in mm:	40
Dimensions of stainless steel bowl height in mm:	270 156
Blade design:	2 blades (double knife), stainless steel
Safety switch:	2
Connected load:	1,8 kW 220-240 V 50/60 Hz
Dimensions (W x D x H), in mm:	315 x 520 x 400
Weight, in kg:	18,4

We reserve the right to implement technical modifications.

Version / characteristics

- Speed control: stepless
- ON/OFF switch
- Easy cleaning
- Blade, pot and lid are dishwasher-safe

4.2 Functions of the Appliance

The cutter has been designed as an aid in food preparation. Thanks to the double knife, the cutter cuts vegetables or meat into the finest pieces in a very short time — ideal for soups, sauces, stuffing for pasties or tender roasts.

4.3 List of Components of the Appliance

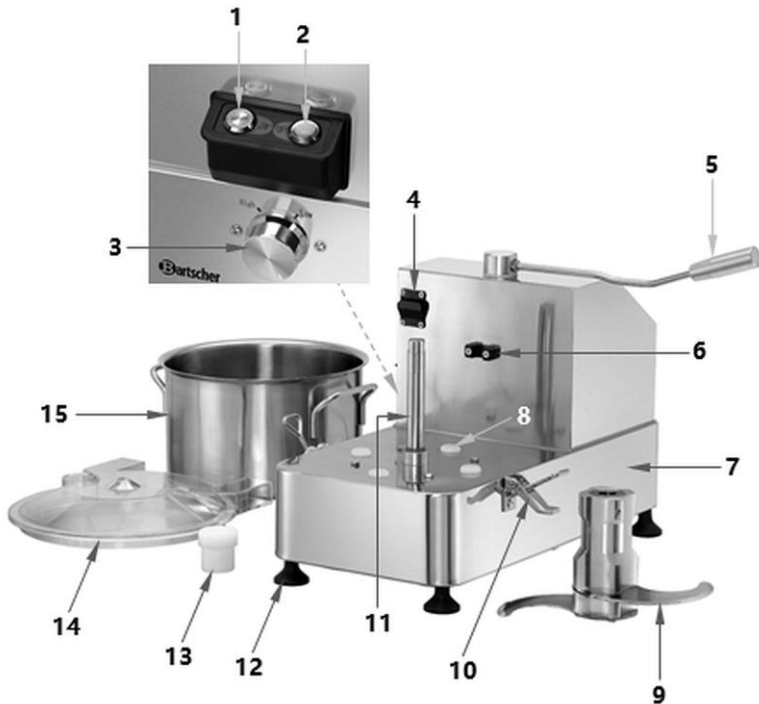

EN

Fig. 1

- | | |
|----------------------------|--|
| 1. Start button | 2. Stop button |
| 3. Speed controller | 4. Safety element in the lid |
| 5. Lever with micro-switch | 6. Bowl attachment |
| 7. Housing | 8. Rubber grommets for insulation protection |
| 9. Blade | 10. Stainless steel bowl safety lock (2 pcs) |
| 11. Blade drive shaft | 12. Rubber feet (4 pcs) |
| 13. Lid lock | 14. Plastic lid |
| 15. Stainless steel bowl | |

Safety Devices

Mechanical protection for plastic lid:

Micro-switch for plastic lid

When the plastic lid is not correctly applied, the appliance motor will not start.

Electrical protection:

Micro-switch in the lever

When the lever is not positioned in the centre of the plastic lid and, thus, does not press on the plastic lid, the motor does not start.

If the lever is removed from the plastic lid during operation, the operation of the appliance stops.

Relay

When power is restored after a power interruption, the appliance must be restarted by pressing the Start button.

5 Installation and operation

5.1 Installation



CAUTION!

Incorrect installation, positioning, operation, maintenance or misuse of the appliance may lead to personal injury or property damage.

Positioning and installation, as well as repairs may be performed by authorised technical service only and in compliance with the applicable national law.

NOTE!

The manufacturer disclaims all liability and provides no warranty for damages, which may be attributed to non-observance of regulations or incorrect installation.

Unpacking / Positioning

- Unpack the appliance, remove all external and internal packaging elements and shipment safeguards.



CAUTION!

Choking hazard!

Prevent children from accessing package materials, for instance: plastic bags and EPS.

- If the appliance is covered with a protective film, remove it. Remove the film slowly, so no glue residues are left. Remove any glue residues with the use of a suitable solvent.
- Be careful not to damage the rating plate and warning labels fixed on the appliance.
- **Never** place the appliance in humid or wet environment.
- Place the appliance in a way making the connections easily accessible, so that they may be quickly disconnected if such a need arises.
- The appliance should be placed on surfaces that are:
 - even, with sufficient bearing capacity, resistant to water, dry and resistant to high temperatures;
 - sufficiently large, and thus enabling usage of the appliance with no problems;
 - easily accessible;
 - well ventilated.
- Maintain sufficient clearance from table edges. The appliance might turn over and fall down.

EN

Power supply connection

- Verify if technical data of the appliance (see rating plate) correspond with the local electric power grid specification.
- Connect the appliance to a single, properly grounded mains socket with protective contact. Do not connect the appliance to a multi-socket.
- The power cord should be laid in a way preventing anyone from threading on it or tripping against it.

5.2 Operation

Before First Use

1. Before use, clean the appliance observing instructions in section 6 'Cleaning'.
2. Then dry the appliance thoroughly.

Appliance Assembly

1. Before commissioning, assemble the appliance observing the following instructions.

WARNING! Injury hazard!

The blade is very sharp!

Be very careful when attaching the blade.

Wear safety gloves resistant to cutting.



Fig. 2



Fig. 3

2. Place the stainless steel bowl on the lower housing of the appliance so that it is secured to the bowl attachment on the housing and to the blade drive shaft.
3. Fasten the stainless steel bowl with two securing locks on the left and right side.
4. Place the blade on the drive shaft in the stainless steel bowl.



Fig. 4

5. Place the plastic lid on the stainless steel bowl. Ensure that it fits correctly into the lid fixing on the appliance housing and on the stainless steel bowl.
6. Place the lid lock in the plastic lid.
7. Slide the lever onto the plastic lid.

Checking Readiness for Operation

1. Plug the appliance into a suitable single socket.
2. Press the 'I' switch and then the 'O' switch to check the operation of these buttons.
3. Check that the speed controller is working properly by rotating it to one of the settings.
4. Check safety devices of the appliance:
 - release the lever by rotating it counter-clockwise,
 - remove the plastic lid,
 - switch the appliance on using the switch. The motor should **not** start.

ATTENTION!

The cutter only works if the plastic lid is correctly placed on the stainless steel bowl and the lever is positioned in the middle of the plastic lid.

If either of these conditions is not met, the appliance will not operate.

Food Products Placing and Processing

ATTENTION!

Food products should only be placed with the motor switched off.

Rotate the speed controller with the marking down (OFF setting).

1. Prepare food products for processing. Before placing in the stainless steel bowl, large pieces should be cut into smaller pieces.
2. To undo the plastic lid, rotate the lever counter-clockwise.
3. Remove the plastic lid from the stainless steel bowl.
4. Now, place the required food products in the stainless steel bowl.

ATTENTION!

The stainless steel bowl can only be filled with food products up to the 'MAX' marking.

EN

5. Place the plastic lid correctly on the stainless steel bowl again.
6. Rotate the lever clockwise as far as it will go to press the plastic lid onto the stainless steel bowl.
7. Press the switch.



Fig. 5

- Depending on food products to be processed, use the speed controller to set the speed by rotating it to one of the settings, 'High' or 'Low'.



Fig. 6

ATTENTION!

Food products should not be processed at low speed for a long time.

After processing at low speed for a short time, rotate the speed controller to a higher setting.

- During food processing, if necessary, additional ingredients can be added to the stainless steel bowl through the lid opening. To this end, remove the lid lock.

ATTENTION!

If the appliance stops during food processing, press the red Stop button and disconnect the appliance from the mains power supply.

Remove the cause of the interruption (e.g., too many food products in the stainless steel bowl) and restart the appliance.

6 Cleaning and Maintenance

6.1 Safety Instructions for Cleaning

- Before cleaning, disconnect the appliance from the power supply.
- Leave the appliance to cool down completely.
- Make sure water does not enter the appliance. Do not immerse the appliance in water or other liquids during cleaning. Do not clean the appliance with a pressurized water jet.
- Do not use any sharp or pointed, nor metal implements (knife, fork, etc.). Sharp or pointed implements may damage the appliance, and when in contact with live parts, they may cause electric shock.
- For cleaning, do not use any scouring agents that contain solvents nor corrosive cleaning agents. They may damage the surface.

6.2 Cleaning

ATTENTION!

Hazard of injury inflicted by cutting edges of the blade!

Be very careful when removing and cleaning the blade.

Wear safety gloves resistant to cutting.

1. Clean the appliance thoroughly at the end of the working day and, if necessary, also between cycles.
2. Release the lever by rotating it counter-clockwise.
3. Remove the plastic lid from the stainless steel bowl.
4. Carefully pull the blade out of the stainless steel bowl by lifting it and pulling it away from the drive shaft.
5. Release the bowl safety locks and remove the bowl from the drive shaft.
6. Wash the plastic lid, lid lock, stainless steel bowl and blade thoroughly with warm water, a mild cleaning agent and a soft cloth or sponge. If needed, use plastic dish-washing brush.

NOTE!

The plastic lid, stainless steel bowl and blade are dishwasher-safe.

7. Then rinse the cleaned parts with fresh water.
8. Leave the cleaned parts to air dry or dry them with a lint-free cloth.
9. Wipe the appliance housing, the stainless steel bowl setting surface, the lever and the connection cable with a slightly damp cloth.

10. Then dry the appliance thoroughly.

6.3 Maintenance

Let the appliance to be inspected by professional technician at least once a year or as required.

The following maintenance work should be carried out regularly:

1. **Belt** does not need adjustments. The belt should be replaced every nine months. When time comes, contact the service company and order a new belt from your dealer.
2. Check the **feet** regularly; replace if damaged.
3. Check the **power cord** regularly. If damaged, have it replaced by a service company or a qualified electrician.
4. Check the **blade knives** regularly. If the blade is no longer sharp enough and does not cut food satisfactorily, replace it. To this end, contact the service company to order a replacement blade.

7 Disposal

Electrical Appliance

	<p>Electric appliances are marked with this symbol. Electrical appliances must be disposed of and recycled in a correct and environmentally friendly manner. You must not dispose of electric appliances with household waste. Disconnect the appliance from the power supply and remove power cord from the appliance.</p>
---	---

Electrical appliances should be returned to designated collection points.