

**V150**



**137100**

Bartscher GmbH  
Franz-Kleine-Str. 28  
D-33154 Salzkotten  
Germany

Phone: +49 5258 971-0  
Fax: +49 5258 971-120  
**Service hotline:** +49 5258 971-197  
[www.bartscher.com](http://www.bartscher.com)



Version: 1.0

Date of preparation: 2024-11-08

---

## Original instruction manual

1	Safety .....	2
1.1	Explanation of Signal Words .....	2
1.2	Safety instructions.....	3
1.3	Intended Use .....	6
1.4	Unintended Use .....	6
2	General information .....	7
2.1	Liability and Warranty .....	7
2.2	Copyright Protection .....	7
2.3	Declaration of Conformity .....	7
3	Transport, Packaging and Storage .....	8
3.1	Delivery Check.....	8
3.2	Packaging .....	8
3.3	Storage .....	8
4	Technical Data.....	9
4.1	Technical Specifications .....	9
4.2	Functions of the Appliance.....	10
4.3	List of Components of the Appliance .....	11
5	Installation and operation .....	12
5.1	Installation.....	12
5.2	Operation .....	14
6	Cleaning .....	16
6.1	Safety Instructions for Cleaning .....	16
6.2	Cleaning.....	16
7	Possible Malfunctions.....	17
8	Disposal.....	18



**Read these instruction manual before using the appliance and keep it available at all times!**

This instruction manual contains information about installation, operation and maintenance of the appliance and constitutes an important source of information and reference guide. The knowledge of all operational and safety instructions included in this manual is a prerequisite for safe and proper handling of the appliance.

Read this instruction manual before you use the appliance and particularly before you start the appliance to prevent injury or damage. Incorrect use may cause damage.

All important information contained in the operating instructions must be available to the appropriate staff at all time. The operator shall be responsible for their availability.

In addition to the operating instructions, you must comply with the general, legal and other applicable regulations for occupational safety and environmental protection.

EN

## 1 Safety

This appliance has been manufactured in accordance with technical standards currently in force. However, the appliance may be a source of hazards if used improperly or contrary to its intended purpose. All persons using the appliance must consider information included in this instruction manual and observe safety instructions.

### 1.1 Explanation of Signal Words

Important safety instructions and warning information are indicated in this instruction manual with appropriate signal words. You must strictly follow the instructions, to prevent accidents, personal injuries and property damages.



**DANGER!**

The signal word **DANGER** warns against hazards that lead to severe injuries or death if the hazards are not avoided.



### **WARNING!**

The signal word **WARNING** warns against hazards that may lead to moderate or severe injuries or death if the hazards are not avoided.



### **CAUTION!**

The signal word **CAUTION** warns against hazards that may lead to light or moderate injuries if the hazards are not avoided.

### **IMPORTANT!**

The signal word **IMPORTANT** indicates possible property damages, which may occur if safety instructions are not observed.

### **NOTE!**

The symbol **NOTE** indicates subsequent information and guidelines for the user on usage of the appliance.

## 1.2 Safety instructions

### Electrical Current

- Too high a mains voltage or incorrect installation may cause electric shock.
- The appliance may be connected only if data on the rating plate correspond with the mains voltage.
- To avoid short-circuit, the appliance should be kept dry.
- If there are malfunctions during operation, disconnect the appliance from the power supply.
- Do not touch the appliance's plug with wet hands.
- Never take hold of the appliance if it has fallen into water. Immediately disconnect the appliance from the power supply.
- Any repairs or housing opening may be carried out by professionals and relevant workshops only.
- Do not transport the appliance, holding it by the power cord.
- Do not allow the power cord to come into contact with heat sources or sharp edges.
- Do not bend, pinch nor knot the power cord.

- Always completely unwind the power cord.
- Never place the appliance or other objects on the power cord.
- Always take hold of the plug to disconnect the appliance from the power supply.
- Check the power cord regularly for damage. Do not use the appliance if the power cord is damaged. If this cable is damaged, it must be replaced by customer service or a qualified electrician in order to avoid dangers.

### Flammable Materials

- Never subject the appliance to contact with high temperature sources, e.g.: oven, furnace, open flame, heat generating devices, etc.
- To avoid fire hazard, clean the appliance regularly.
- Do not cover the appliance with, e.g., aluminium foil or cloths.
- Use the appliance only with materials designated to this end and with correct temperature settings. Materials, groceries and left-overs remaining in the appliance may catch fire.
- Never use the appliance near flammable or inflammable materials, e.g.: petrol, spirit, alcohol, etc. High temperature triggers evaporation of these materials, and, as a result of contact with sources of ignition, an explosion may occur.
- In case of fire, disconnect the appliance from the power supply before attempting suitable fire-extinguishing actions.
- Never attempt to extinguish fire with water if the appliance is connected to the power supply. Following extinction of fire, ensure sufficient fresh air inflow.

## Safety

---

### Hot Surfaces

- Surfaces of the appliance become hot during operation. Burning hazard! High temperature remains for some time after switching the appliance off.
- Do not touch any hot surfaces of the appliance. Use the provided handling elements and holders.
- You may transport and clean the appliance after it cools down entirely.
- It is prohibited to sprinkle hot surfaces with cold water or flammable liquids.

### Operating personnel

- This appliance is not intended to be used by persons (including children) with limited physical, sensory or mental capabilities, nor by persons with limited experience and/or limited knowledge.
- Children should be supervised to ensure that they are not playing with or switching the appliance on.

### Supervised Usage only

- Only supervised appliance may be used.
- Always remain in an immediate vicinity of the appliance.

EN

### Improper Use

- Unintended or prohibited use may cause damage to the appliance.
- The appliance may only be used when its technical condition is flawless and allows for safe operation.
- The appliance may only be used when all connections are executed according to rules of law in force.
- The appliance may only be used when it is clean.
- Use only original spare parts. Never attempt to repair the appliance on your own.
- Do not introduce any changes in the appliance nor modify it.

## 1.3 Intended Use

This appliance is only intended for use described in the operating instructions, with the supplied and approved components.

Any other use is considered against the intended purpose. The manufacturer shall not be liable for any damage due to unintended use. In such cases the responsible party shall only be the user/operator.

The following is an intended purpose:

- Popcorn production.

## 1.4 Unintended Use

An unintended use may lead to personal injuries or property damages caused by hazardous voltage, fire or high temperature. The appliance may only be used to perform tasks described in this instruction manual.



## 2 General information

### 2.1 Liability and Warranty

The appliance was built in accordance with the current state of the art and recognized technical safety principles. Nevertheless, during its use, there may be a threat to the health and life of the user or bystanders, or the danger of damage to the device or other assets. Warranty and liability claims for personal injury/property damage as well as defects at work are excluded if they can be attributed to one or more of the following causes:

- Use against the intended purpose
- Failure to follow/disregard the instructions and all related information
- Unauthorized structural or technical changes to the device
- Engaging insufficiently trained and insufficiently qualified personnel
- Operation with defective or incorrectly installed safety and protective devices
- Inadequate maintenance or cleaning
- Faults not fixed
- Use of prohibited media, cleaning agents, etc.
- Use of unauthorised spare parts
- Errors in operation or other misuse
- Disasters caused by foreign objects or force majeure
- Destruction of the type plate and stickers relevant for operation and safety

### 2.2 Copyright Protection

This instruction manual, and texts, drawings and images included in it, as well as its other components are copyright protected. It is prohibited to reproduce this instruction manual (including its excerpts), in any form and by any means, and to use and/or transfer its content to third parties without manufacturer's written permission. Violation of the above results in obligation to pay compensation. We reserve the right to claim further damages.

### 2.3 Declaration of Conformity

The appliance meets the currently applicable standards and guidelines of the European Union. We confirm the above in the EC Declaration of Conformity. We may provide relevant Declaration of Conformity upon request.

## 3 Transport, Packaging and Storage

### 3.1 Delivery Check

Immediately upon reception, check the delivery for completeness and possible shipping damage. In the case of visible transport damage refuse to accept the appliance or accept it conditionally. Mark and note the scope of damage in shipping documents/consignment list of the shipping company and lodge a complaint.

Concealed damage must be reported immediately upon its discovery, as compensation claims may only be filed within applicable time limits.

If you find that parts or accessories missing, please contact our Customer Service Department.

### 3.2 Packaging

Do not dispose of the appliance cardboard box. It may be used to store the appliance when relocating or when shipping the appliance to our service point in the case of any damages.

The packaging and its elements are made of recyclable materials. Particularly, these are: plastic films and bags, cardboard box.

When disposing of the packaging, observe applicable domestic regulations. Recyclable packaging materials should be recycled.

### 3.3 Storage

Leave the packaging closed until installation of the appliance; observe external indications concerning method of placing and storage. Store the packaging in the following conditions only:

- in closed rooms;
- in dry and dust-free surrounding;
- away from aggressive agents;
- in a location protected against sunlight;
- in a location protected against mechanical shocks.

In the case of extended storage (over three months), make sure you check the condition of the packaging and the parts regularly. If needed, replace the packaging with a new one.

## 4 Technical Data

### 4.1 Technical Specifications

<b>Name:</b>	<b>Popcorn machine V150</b>
Art. No.:	137100
Material:	painted aluminium   glass   plexiglas
Pot material:	non-stick coating on inside   stainless steel on the outside
Max. pot capacity, popcorn grains in g:	227
Max. capacity / hour, in kg:	1,5
Production time / operating cycle in sec.:	300
Dimensions of popcorn compartment (W x D) in mm:	485 x 390 x 505
Temperature range, max., in °C:	150
Number of crumb drawers:	1
Connected load:	1,5 kW   220-240 V   50-60 Hz
Dimensions (W x D x H), in mm:	518 x 418 x 672
Weight, in kg:	18,6

We reserve the right to implement technical modifications.

## Version / Characteristics

- Pot:
  - rotary
  - removable
- Pot control: heating element and agitator activated by rocker switch
- Design of the popcorn compartment bottom:
  - stainless steel
  - removable
- Heated popcorn compartment: bottom (rocker switch)
- Popcorn removal flap: operator side
- Internal lighting
- Door type:
  - double door
  - magnet lock door
- Crumb tray, removable
- Safety thermostat
- Control: rocker switch
- The set includes: 1 scoop

EN

## 4.2 Functions of the Appliance

The popcorn machine with a capacity of 1.5 kg/hour and a production time/cycle of 300 seconds is designed for professional use — at fairs, in cinemas or during similar events. Plus, it is, both, uncomplicated to operate and easy to clean.

## 4.3 List of Components of the Appliance

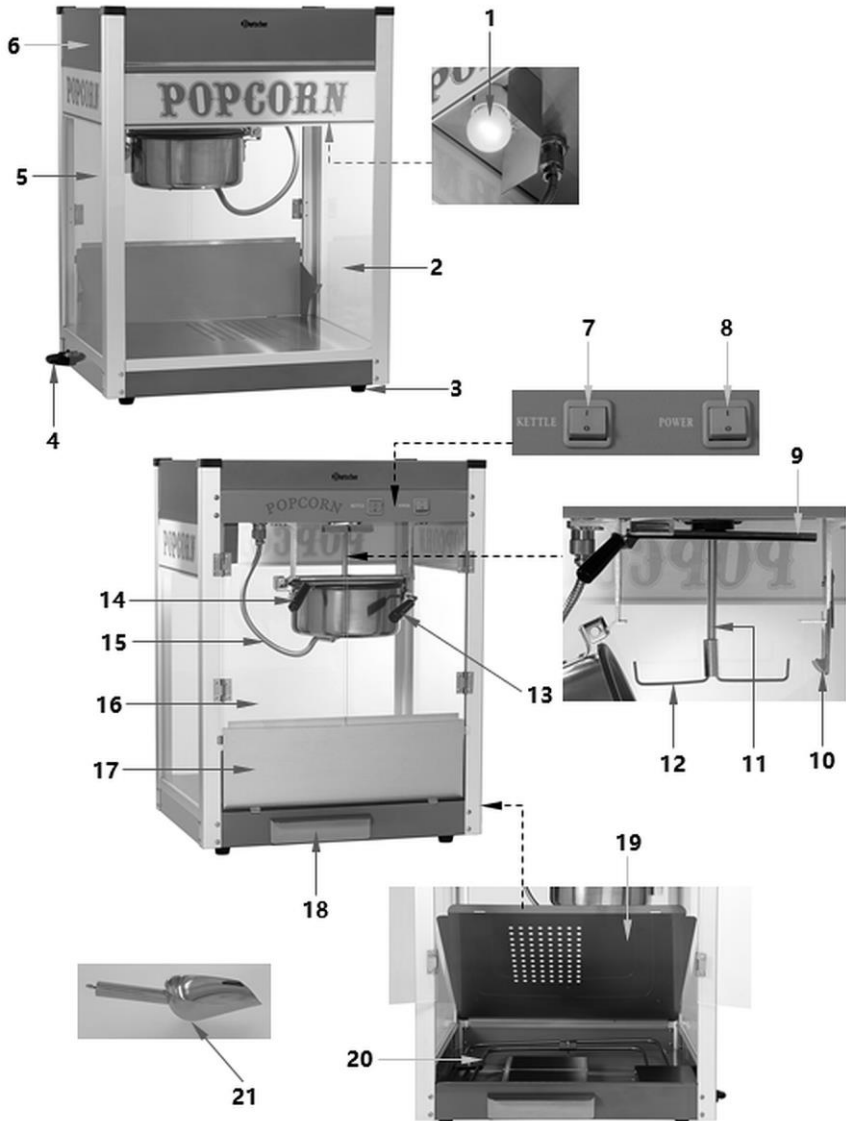

Fig. 1

### Key to Fig. 1

- |   |                                  |
|---|----------------------------------|
| 1. Internal lighting                            | 2. Front glass pane              |
| 3. Foot (4 pcs)                                 | 4. Power cord                    |
| 5. Side glass pane (2 pcs)                      | 6. Housing                       |
| 7. Heating element & agitator ('Kettle') switch | 8. 'Power' ON/OFF switch         |
| 9. Lid  | 10. Pot hanger                   |
| 11. Agitator drive system / lid guide rod       | 12. Mixing rod                   |
| 13. Pot with handle                             | 14. Lid handle                   |
| 15. Pot cord connection                         | 16. Double door with magnet lock |
| 17. Popcorn flap                                | 18. Crumb drawer                 |
| 19. Bottom panel, removable                     | 20. Heating element              |
| 21. Scoop                                       |                                  |

## 5 Installation and operation

### 5.1 Installation



#### CAUTION!

**Incorrect installation, positioning, operation, maintenance or misuse of the appliance may lead to personal injury or property damage.**

Positioning and installation, as well as repairs may be performed by authorised technical service only and in compliance with the applicable national law.

#### NOTE!

**The manufacturer disclaims all liability and provides no warranty for damages, which may be attributed to non-observance of regulations or incorrect installation.**

### Unpacking / Positioning

- Unpack the appliance, remove all external and internal packaging elements and shipment safeguards.



### CAUTION!

#### Choking hazard!

Prevent children from accessing packaging materials, for instance: plastic bags and EPS elements.

- If the appliance is covered with a protective film, remove it. Remove the film slowly, so no glue residues are left. Remove any glue residues with the use of a suitable solvent.
- Be careful not to damage the rating plate and warning labels affixed to the appliance.
- **Never** place the appliance in humid or wet environment.
- Place the appliance in a way making the connections easily accessible, so that they may be quickly disconnected if such a need arises.
- When selecting the installation site, please consider the following items:
  - The mounting surface must be even, sufficiently load-bearing, waterproof, dry and resistant to high temperatures.
  - Make sure that the designated escape routes are clear.
  - Ensure a stable position.
  - Allow sufficient space for work, maintenance and cleaning.
  - Leave the supply and exhaust air vents, if any, free.
  - Comply with applicable technical and building regulations.
- Maintain sufficient clearance from table edges. The appliance might turn over and fall down.
- Leave at least 10 cm clearance from flammable walls and items.

#### Power supply connection

- Verify if technical data of the appliance (see rating plate) correspond with the local electric power grid specification.
- Connect the appliance to a single, properly grounded mains socket with protective contact. Do not connect the appliance to a multi-socket.
- The power cord should be laid in a way preventing anyone from threading on it or tripping against it.

## 5.2 Operation

### Appliance Preparation

1. Before starting-up, clean the appliance and its equipment inside and outside observing instructions in section '**Cleaning**'.
2. Dry all cleaned elements and surfaces thoroughly.
3. Ensure that all elements removed for cleaning are reattached or placed in the unit.

### Popcorn Production

1. Plug the appliance into a suitable single socket.



Fig. 2

2. Place 50 g of coconut oil, 2–3 tablespoons of sugar and 150 g of corn grains in the pot (adjust the proportions of ingredients to taste).
3. Set both switches (Power + Kettle) to the ON '**I**' position.
4. Using the handle, slide the lid onto the pot.
5. Close the double door on the operator side.

### **WARNING!**

#### **Risk of burns from hot splashing fat!**

Never lift the pot lid while the popcorn is 'popping'.

After 2–4 minutes corn grains start to 'burst'. When no additional noises can be heard, the process is complete and the popcorn is ready.

### **WARNING!**

#### **Hot surface!**

#### **The pot heats up strongly during operation.**

Never touch the pot. Always use the handle of the pot for unhooking/hanging and tilting.



## Installation and operation



Fig. 3

6. Use the handle to move the lid upwards.
7. Detach the pot (turn the handle clockwise).
8. Pour out the popcorn by tilting the pot. The finished popcorn falls off the bottom panel.
9. Wipe the pot with a paper towel so that no residue remains inside.

10. To produce more popcorn, reattach the pot on the hanger.
11. Return all the ingredients to the pot and repeat the process described above until the required amount of popcorn is produced.

## Dispensing and Serving the Popcorn



Fig. 4

1. Fully open the double door to tilt the popcorn flap. Once tilted, the double door can be closed again and the popcorn dispensed.
2. Remove the finished popcorn with the supplied scoop and fill the corresponding containers with it.
3. Serve the popcorn.

### Switching the Appliance OFF

1. If the appliance is no longer to be used, switch it off by switching both switches (Kettle + Power) to the 'O' position.
2. Disconnect the appliance from the mains socket (pull the plug out).

## 6 Cleaning

### 6.1 Safety Instructions for Cleaning

- Before cleaning, disconnect the appliance from the power supply.
- Leave the appliance to cool down completely.
- Make sure water does not enter the appliance. Do not immerse the appliance in water or other liquids during cleaning. Do not clean the appliance with a pressurized water jet.
- Do not use any sharp or pointed, nor metal implements (knife, fork, etc.). Sharp or pointed implements may damage the appliance, and when in contact with live parts, they may cause electric shock.
- For cleaning, do not use any scouring agents that contain solvents nor corrosive cleaning agents. They may damage the surface.

EN

### 6.2 Cleaning

1. Clean the appliance after each use.
2. Remove the crumb drawer from the appliance and empty it.
3. Open the double door.
4. Remove the bottom panel and popcorn flap from the appliance.
5. Disconnect the cord feed to the pot.
6. Detach the pot, releasing it from its suspension by tilting it with the help of the handle.
7. Loosen the cotter on the left pin and then remove the pin; this is how the pot can be removed from the hanger.
8. Slide the agitator sleeve upwards and remove the agitator from the drive rod.
9. Pull the guide rod cover down.
10. Clean all removed parts with warm water, a soft cloth and a mild detergent.
11. Rinse cleaned elements in fresh water.
12. Clean the glass surfaces inside and outside, as well as the housing with a soft, damp cloth.
13. Dry all the cleaned elements and surfaces completely with a soft cloth.

## Possible Malfunctions

14. Reattach the removed parts to the appliance.

## 7 Possible Malfunctions

The table below contains descriptions of possible causes and solutions to malfunctions or errors during operation of the appliance. The works may only be performed by suitably qualified technical personnel.

When malfunction cannot be removed, contact the technical service. In such a case, provide article number, model and serial number. You will find this information on the rating plate.

<b>Error</b>	<b>Possible Cause</b>	<b>Solution</b>
Lighting does not switch on	Appliance is not connected to the power supply	Connect the appliance to the power supply
	No electric power supply	Check electric power supply. Otherwise, contact the service company
	Damaged bulb	Replace the bulb
Appliance does not heat up	Power supply to the heating element interrupted	Contact the service company
	Damaged heating element	Contact the service company
	Cable connection to pot defective	Contact the service company
Temperature too high or too low	Thermostat broken	Contact the service company

## 8 Disposal

### Electrical Appliance



Electric appliances are marked with this symbol. Electrical appliances must be disposed of and recycled in a correct and environmentally friendly manner. You must not dispose of electric appliances with household waste. Disconnect the appliance from the power supply and remove power cord from the appliance.

Electrical appliances should be returned to designated collection points.