

86L



700678G

Bartscher GmbH
Franz-Kleine-Str. 28
D-33154 Salzkotten
Germany

Phone: +49 5258 971-0

Fax: +49 5258 971-120

Technical Support Hotline: +49 5258 971-197

www.bartscher.com



Version: 3.0

Date of preparation: 2024-08-29

Original instruction manual

1	Safety	2
1.1	Explanation of Signal Words	2
1.2	Safety instructions.....	3
1.3	Intended Use	6
1.4	Unintended Use	6
2	General information	7
2.1	Liability and Warranty	7
2.2	Copyright Protection	7
2.3	Declaration of Conformity	7
3	Transport, Packaging and Storage	8
3.1	Delivery Check.....	8
3.2	Packaging	8
3.3	Storage	8
4	Technical Data.....	9
4.1	Technical Specifications	9
4.2	Functions of the Appliance.....	10
4.3	List of Components of the Appliance	11
5	Installation and operation	12
5.1	Installation.....	12
5.2	Operation	14
6	Cleaning and Maintenance	17
6.1	Safety Instructions for Cleaning	17
6.2	Cleaning.....	18
6.3	Maintenance	18
7	Possible Malfunctions.....	19
8	Disposal.....	22



Read these instruction manual before using the appliance and keep it available at all times!

This instruction manual contains information about installation, operation and maintenance of the appliance and constitutes an important source of information and reference guide. The knowledge of all operational and safety instructions included in this manual is a prerequisite for safe and proper handling of the appliance.

Read this instruction manual before you use the appliance and particularly before you start the appliance to prevent injury or damage. Incorrect use may cause damage.

All important information contained in the operating instructions must be available to the appropriate staff at all time. The operator shall be responsible for their availability.

In addition to the operating instructions, you must comply with the general, legal and other applicable regulations for occupational safety and environmental protection.

EN

1 Safety

This appliance has been manufactured in accordance with technical standards currently in force. However, the appliance may be a source of hazards if used improperly or contrary to its intended purpose. All persons using the appliance must consider information included in this instruction manual and observe safety instructions.

1.1 Explanation of Signal Words

Important safety instructions and warning information are indicated in this instruction manual with appropriate signal words. You must strictly follow the instructions, to prevent accidents, personal injuries and property damages.



DANGER!

The signal word **DANGER** warns against hazards that lead to severe injuries or death if the hazards are not avoided.



WARNING!

The signal word **WARNING** warns against hazards that may lead to moderate or severe injuries or death if the hazards are not avoided.



CAUTION!

The signal word **CAUTION** warns against hazards that may lead to light or moderate injuries if the hazards are not avoided.

IMPORTANT!

The signal word **IMPORTANT** indicates possible property damages, which may occur if safety instructions are not observed.

NOTE!

The symbol **NOTE** indicates subsequent information and guidelines for the user on usage of the appliance.

1.2 Safety instructions

Electrical Current

- Too high a mains voltage or incorrect installation may cause electric shock.
- The appliance may be connected only if data on the rating plate correspond with the mains voltage.
- To avoid short-circuit, the appliance should be kept dry.
- If there are malfunctions during operation, disconnect the appliance from the power supply.
- Do not touch the appliance's plug with wet hands.
- Never take hold of the appliance if it has fallen into water. Immediately disconnect the appliance from the power supply.
- Any repairs or housing opening may be carried out by professionals and relevant workshops only.
- Do not transport the appliance, holding it by the power cord.
- Do not allow the power cord to come into contact with heat sources or sharp edges.
- Do not bend, pinch nor knot the power cord.

- Always completely unwind the power cord.
- Never place the appliance or other objects on the power cord.
- Always take hold of the plug to disconnect the appliance from the power supply.
- Check the power cord regularly for damage. Do not use the appliance if the power cord is damaged. If this cable is damaged, it must be replaced by customer service or a qualified electrician in order to avoid dangers.

Fire hazard / flammable materials hazard / explosion hazard!

- Do not use any electric devices in the appliance.
- Do not store nor use petrol or other flammable liquids and gases in the vicinity of this or any other appliance. Those gases may cause fire or explosion hazard.
- Do not put into the appliance any explosive materials, like sprays filled with flammable propellants. Contents of containers filled with flammable gases and liquids may leak in low temperatures, and the contents may catch fire from sparks generated by an electric appliance. Explosion hazard!
- In the case of coolant leakage, pull the plug from the socket. Remove all sources of ignition in the vicinity, ventilate room and contact technical service. Avoid coolant getting in contact with eyes, as it may cause serious eye damage.
- Never use any flammable liquids for cleaning the appliance or its parts. Gases released may cause fire or explosion hazard.
- In the case of fire, disconnect the appliance from the power supply before attempting adequate fire-extinguishing actions.
- Never attempt to extinguish fire with water if the appliance is connected to the power supply. Following extinction of fire, ensure sufficient fresh air inflow.
- Defrosting process may not be sped up with mechanical means or heat energy sources (candles or heaters) nor with any other means. Vapour produced may cause short-circuit and too high temperatures may damage the appliance.
- All ventilation slots should not be obstructed during operation.
- Never attempt to damage cooling installation of the appliance.

Operator's responsibility

The operator is responsible for complying with the currently applicable laws, regulations, ordinances and existing national regulations on accident prevention, environmental protection, as well as the internal operation, operating and safety instructions that apply at the respective installation site.

Obligations of the operator:

- Operate the appliance and its components only in a technical condition that does not raise any objections, with functional protective and safety elements.
- Prepare risk assessment at work positions.
- Provide instruction and regular staff training. Pay special attention to and observe the section concerning safety and any safety hints.
- Provide suitable personal protective equipment (PPE)
- Observe the intervals of maintenance and cleaning.
- Document training/instructions, replacement of components.

Operating Personnel

- The device can be used by children of 8 years old and older, as well as by people with reduced physical, sensory or mental abilities and those with limited experience/knowledge as long as they are under supervision or have been instructed on safe use of the device and possible risks. Children should not play with the device.
- Children aged 3 to 8 may load and unload the refrigerator.

Improper Use

- Unintended or prohibited use may cause damage to the appliance.
- The appliance may only be used when its technical condition is flawless and allows for safe operation.
- The appliance may only be used when all connections are executed according to rules of law in force.
- The appliance may only be used when it is clean.
- Use only original spare parts. Never attempt to repair the appliance on your own.
- Do not introduce any changes in the appliance nor modify it.
- Do not drill hole in the appliance nor install any objects on it.
- Do not place any heavy objects on the appliance.

1.3 Intended Use

This appliance is only intended for use described in the operating instructions, with the supplied and approved components.

Any other use is considered against the intended purpose. The manufacturer shall not be liable for any damage due to unintended use. In such cases the responsible party shall only be the user/operator

The following is an intended purpose

- Cooling of beverages and food products.

The appliance is intended for operation in maximum ambient temperature of 32°C and relative humidity of 65%.

This appliance is intended for use in households and similar places, e.g.:

- in employee canteens in shops, offices, and similar areas;
- on farms;
- by customers in hotels, motels, and other typical accommodation establishments;
- in lodging-houses.

EN

1.4 Unintended Use

An unintended use may lead to personal injuries or property damages caused by hazardous voltage, fire or high temperature. The appliance may only be used to perform tasks described in this instruction manual.

The following is an unintended use:

- Storing flammable or explosive objects and liquids, such as ether, petroleum or adhesives.
- Storing explosive materials, like sprays filled with flammable propellants.
- Storing pharmaceutical products or preserved blood.
- Storing live pets.

2 General information

2.1 Liability and Warranty

The appliance was built in accordance with the current state of the art and recognized technical safety principles. Nevertheless, during its use, there may be a threat to the health and life of the user or bystanders, or the danger of damage to the device or other assets. Warranty and liability claims for personal injury/property damage as well as defects at work are excluded if they can be attributed to one or more of the following causes:

- Use against the intended purpose
- Failure to follow/disregard the instructions and all related information
- Unauthorized structural or technical changes to the device
- Engaging insufficiently trained and insufficiently qualified personnel
- Operation with defective or incorrectly installed safety and protective devices
- Inadequate maintenance or cleaning
- Faults not fixed
- Use of prohibited media, cleaning agents, etc.
- Use of unauthorised spare parts
- Errors in operation or other misuse
- Disasters caused by foreign objects or force majeure
- Destruction of the type plate and stickers relevant for operation and safety

The warranty period for this appliance is 24 months, counted from the purchase date.

2.2 Copyright Protection

This instruction manual, and texts, drawings and images included in it, as well as its other components are copyright protected. It is prohibited to reproduce this instruction manual (including its excerpts), in any form and by any means, and to use and/or transfer its content to third parties without manufacturer's written permission. Violation of the above results in obligation to pay compensation. We reserve the right to claim further damages.

2.3 Declaration of Conformity

The appliance meets the currently applicable standards and guidelines of the European Union. We confirm the above in the EC Declaration of Conformity. We may provide relevant Declaration of Conformity upon request.

3 Transport, Packaging and Storage

3.1 Delivery Check

Immediately upon reception, check the delivery for completeness and possible shipping damage. In the case of visible transport damage refuse to accept the appliance or accept it conditionally. Mark and note the scope of damage in shipping documents/consignment list of the shipping company and lodge a complaint.

Concealed damage must be reported immediately upon its discovery, as compensation claims may only be filed within applicable time limits.

If you find that parts or accessories missing, please contact our Customer Service Department.

3.2 Packaging

Do not dispose of the appliance cardboard box. It may be used to store the appliance when relocating or when shipping the appliance to our service point in the case of any damages.

The packaging and its elements are made of recyclable materials. Particularly, these are: plastic films and bags, cardboard box.

When disposing of the packaging, observe applicable domestic regulations. Recyclable packaging materials should be recycled.

3.3 Storage

Leave the packaging closed until installation of the appliance; observe external indications concerning method of placing and storage. Store the packaging in the following conditions only:

- in closed rooms;
- in dry and dust-free surrounding;
- away from aggressive agents;
- in a location protected against sunlight;
- in a location protected against mechanical shocks.

In the case of extended storage (over three months), make sure you check the condition of the packaging and the parts regularly. If needed, replace the packaging with a new one.

4 Technical Data

4.1 Technical Specifications

Name:	Mini cooler 86L
Art. No.:	700678G
Material:	plastic, glass
Display area material:	plastic ABS
Display area dimensions (W x D), in mm:	345 x 310
Volume in litres:	86
Temperature range, min.–max., in °C:	2 - 12
Coolant:	R600a
Climate class:	4
Energy efficiency class:	C (EU Nr. 2019/2018)
Energy consumption, in kWh/year:	1184
Number of doors:	2
Number of shelves:	3
Shelf dimensions (W x D), in mm:	355 x 345
Connected load:	0,18 kW 220-240 V 50 Hz
Dimensions (W x D x H), in mm:	425 x 425 x 980
Weight, in kg:	36,5

EN

We reserve the right to implement technical modifications.

More information on the appliance is available in our website www.bartscher.com or, pursuant to the Regulation (EU) 2019/2018, in our product data base at <https://energy-label.ec.europa.eu/>. Enter article number for a given model.

Version / Characteristics

- Cooling: circulating air
- Temperature control: digital
- Control: key
- Digital display
- ON/OFF switch
- Automatic defrost function
- Internal lighting
 - LED
 - top
 - switched on separately
- Front pane: cased / framed
- Door type: leaf door, convex
- Door position: both sides
- Door hinge: right-hand side, no possibility of changing
- Type of glazing: double glazing
- Safety glass: no
- Type of shelves:
 - grate, chromed with plastic coating
 - adjustable height
- Internal usable height: variable
- Features: air control sheet panel, prevents glass from fogging up

EN

4.2 Functions of the Appliance

The mini cooler, with convex leaf doors on the front and back, is ideal for use in buffet zones. Thanks to height-adjustable racks, the mini cooler allows flexible use of individual levels. Thanks to circulation of cold air inside the appliance, beverages and food products are chilled to the required temperature and kept cool. LED lighting enables optimum presentation of beverages and food products.

4.3 List of Components of the Appliance

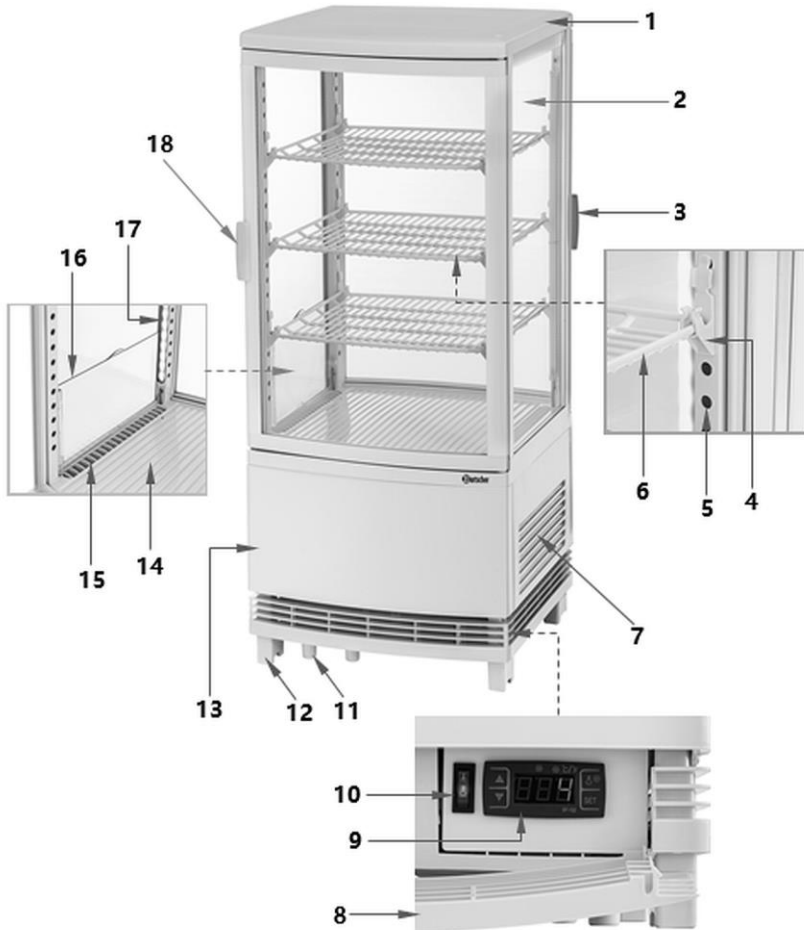

EN

Fig. 1

Description to Fig. 1

- | | |
|---|---|
| 1. Top cover | 2. Glass side panel (2 pcs) |
| 3. Glass door with handle located at the back | 4. Shelf bracket |
| 5. Guide rails | 6. Shelves (3 or 4 pcs) |
| 7. Ventilation openings | 8. Front cover |
| 9. Digital temperature controller | 10. ON/OFF switch with integrated power indicator light (red) |
| 11. Support | 12. Feet (4 pcs) |
| 13. Housing | 14. Bottom display area |
| 15. Internal ventilation openings | 16. Air control plate |
| 17. LED lighting | 18. Glass door with handle located at the front |

5 Installation and operation

5.1 Installation

EN

Unpacking / Positioning

- Unpack the appliance, remove all external and internal packaging elements and shipment safeguards.



CAUTION!

Choking hazard!

Prevent children from accessing packaging materials, for instance: plastic bags and EPS elements.

- If the appliance is covered with a protective film, remove it. Remove the film slowly, so no glue residues are left. Remove any glue residues with the use of a suitable solvent.
- Be careful not to damage the rating plate and warning labels affixed to the appliance.
- **Never** place the appliance in humid or wet environment.
- Place the appliance in a way making the connections easily accessible, so that they may be quickly disconnected if such a need arises.
- When selecting the installation site, please consider the following items:

Installation and operation

- The mounting surface must be even, sufficiently load-bearing, waterproof, dry and resistant to high temperatures.
 - Make sure that the designated escape routes are clear.
 - Ensure a stable position.
 - Allow sufficient space for work, maintenance and cleaning.
 - Leave the supply and exhaust air vents, if any, free.
 - Comply with applicable technical and building regulations.
- Do not place the appliance in direct sunlight or in the vicinity of heat sources (cooker, radiator, heating devices, etc.). Heat sources may negatively affect power consumption, and restrict functions of the appliance, too.
 - Place the appliance so that sufficient air circulation is ensured. Do not block nor cover ventilation openings in the rear wall of the appliance.
 - Leave at least 10 cm clearance from walls and other objects.
 - In order to avoid damage to the compressor, do not tilt the appliance more than 45° when positioning or transporting it.
 - If the appliance is to be relocated, follow the instructions below:
 - switch the appliance off;
 - disconnect the plug from the socket;
 - take out contents of the appliance;
 - tape firmly all loose elements in the internal chamber and tape the door;
 - the appliance may only be transported in vertical position.

Power supply connection

- Verify if technical data of the appliance (see rating plate) correspond with the local electric power grid specification.
- Connect the appliance to a single, properly grounded mains socket with protective contact. Do not connect the appliance to a multi-socket.
- The power cord should be laid in a way preventing anyone from threading on it or tripping against it.
- Prior to first use, the appliance should be installed and left standing upright for at least 2 hours, before it is connected to power supply.
- After a power failure or when the plug is removed from the socket, do not reconnect the appliance to power supply for at least 5 minutes.

5.2 Operation

Tips for the User

- Shelves may be positioned at various heights. Arrange them adequately to the size of beverage and food product containers, so that the inner space of the appliance is used optimally.
- Beverages and food products in suitable containers should be arranged on the shelves so that proper distances between them allow for sufficient air circulation inside the appliance. Insufficient distances hinder the cooling effect.
- Do not place warm food dishes in the appliance; cool them down to ambient temperature first.
- To limit loss of cold air minimize the opening time of door during operation.
- If possible, in the event of a sudden power failure, avoid opening doors in order to avoid loss of cool air.

Appliance Preparation and Start-Up

1. Prior to first operation, clean the appliance and its equipment observing instructions in section **6 'Cleaning'**.
2. To end with, dry the appliance and accessories thoroughly.
3. At a required height, place supports on guide rails and insert shelves.
4. Close the appliance door.
5. Connect the appliance to a single grounded socket.
6. Switch the appliance on with the ON/OFF switch (behind the front tilted cover).

The power supply connection is indicated by the red indicator light.

The appliance will be cooled down to the factory pre-set temperature.

The digital display shows current temperature inside the appliance. The LED cooling indicator will come on, and it will be lit throughout the entire cooling process.

7. Beverages and food products should be placed in the appliance only when it reaches the right temperature.
8. If needed, the temperature may be altered with digital temperature control regulator keys.

Installation and operation

Control Elements, Indicators

The ON/OFF switch and the digital temperature controller are behind the tilted cover of the front section of the appliance. To switch the appliance on or introduce settings, as well as check current temperature, tilt the cover.

Digital temperature control / button functions

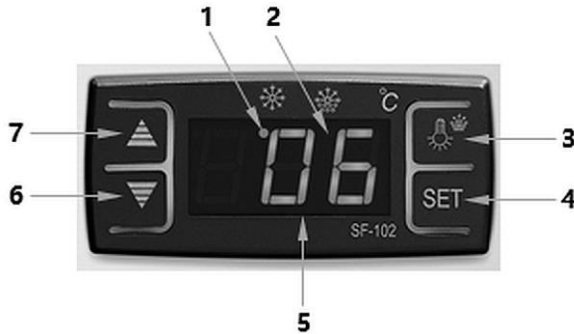

1. LCD cooling indicator
2. LCD defrosting indicator
3. Lighting / defrosting button
4. SET function button
5. Digital display
6. Temperature decrease button
7. Temperature increase button

EN

LCD indicators



LCD cooling indicator

This indicator is lit over cooling process; it remains off as long as the cooling temperature remains at constant level, and blinks during switch on delay.



LCD defrosting indicator

This indicator is lit over defrosting process; goes off when the defrosting process is completed, and flashes during defrost delay.



Temperature Setting

The optimum temperature setting is factory default and it equals the operating temperature of 0–12°C inside the mini cooler.

To change the temperature settings, perform the following steps:

1. Press the **SET** key, to display the set temperature.

The set value is displayed and it starts blinking a moment later.

2. If needed, press the  or  key to change the displayed value.
3. Press the **SET** key again to save the setting and return to displaying temperature of the cooling compartment.



NOTE!

If no other key is pressed within 10 second, the temperature of the cooling chamber will be shown in the digital display.

Switching the Internal LED Lighting ON/OFF

The appliance is equipped with internal LED lighting, which is arranged vertically in corners of the appliance internal chamber.

The internal LED lighting may be switched on and off any time.

1. Press the  key briefly to switch the LED lighting on.
2. Press the  key briefly again to switch the internal LED lighting off.

Automatic Defrosting

The appliance defrosts automatically 4 times over a 24-hour period.

Initiation of Manual Defrosting/Finishing Defrosting Process

If cooling efficiency drops, e.g. after a prolonged period opening door, manual defrosting is required.

1. Press the  key and hold it pressed for 6 seconds, to initiate defrosting or finish this process.

The defrosting LCD indicator light is lit.

2. Press the  key and hold it pressed for 6 seconds, to finish the defrosting process.

The defrosting LCD indicator light goes off.

Switching the Appliance Off

1. If the appliance is not to be used any more, it should be switched off with the ON/OFF switch located behind the cover in the bottom front section.
2. Disconnect the appliance from the mains socket (pull the plug out).

6 Cleaning and Maintenance

The operator must ensure that the device and its safety components are kept in good condition. Control and safety systems should be checked for their effectiveness.

Maintenance, cleaning and repairs must only be carried out by suitably trained and specialised personnel.

If the safety devices need to be removed for maintenance, cleaning and repair, they should be reinstalled immediately after completion and their function should be checked.

All maintenance and cleaning work must be carried out in accordance with the operating instructions at the specified intervals.

6.1 Safety Instructions for Cleaning

- Before cleaning, disconnect the appliance from the power supply.
- Leave the appliance to cool down completely.
- Make sure water does not enter the appliance. Do not immerse the appliance in water or other liquids during cleaning. Do not clean the appliance with a pressurized water jet.
- Do not use any sharp or pointed, nor metal implements (knife, fork, etc.). Sharp or pointed implements may damage the appliance, and when in contact with live parts, they may cause electric shock.
- For cleaning, do not use any scouring agents that contain solvents nor corrosive cleaning agents. They may damage the surface.

6.2 Cleaning

1. At the end of a working day clean the appliance thoroughly.
2. Remove all objects from the appliance.
3. Remove all shelves from the appliance.
4. Clean the shelves with warm water and soft cloth or sponge. Use mild cleaning agent if required.
5. Rinse the shelves with clean water and dry thoroughly with soft cloth.

NOTE!

Never use hot water to clean the appliance.

6. Clean the appliance inside with warm water and soft, moistened cloth. Use mild cleaning agent if required.
7. Wipe the washed surfaces with a cloth moistened in clean water.
8. Wipe the appliance housing and glass doors with frame with a soft, moistened cloth.
9. Finally, dry thoroughly all washed surfaces.
10. Leave the doors open for the appliance to dry completely.

EN

6.3 Maintenance

We recommend having the appliance serviced at least twice a year by an authorised service centre, and to conclude a service contract if necessary.

7 Possible Malfunctions

The table below contains descriptions of possible causes and solutions to malfunctions or errors during operation of the appliance. The works may only be performed by suitably qualified technical personnel.

When malfunction cannot be removed, contact the technical service. In such a case, provide article number, model and serial number. You will find this information on the rating plate.

Error	Possible Cause	Solution
No cooling	The plug is not properly connected to a socket	Remove the plug and insert it properly in a socket
	Electric power supply safety fuse damaged	Check the fuse, connect the appliance to another socket
	No power supply	Check the electric power supply
	Loss of coolant	Contact the service company
	Damaged temperature controller	Contact the service company

Error	Possible Cause	Solution
Insufficient cooling efficiency	Direct sunlight or heat sources in immediate vicinity	Move the appliance away from heat sources
	Poor air circulation around the appliance	Keep sufficient clearance from walls or other objects
	Door is not closed properly or it has been opened for too long	Close the door tightly; limit the door opening time to minimum
	Damaged or deformed door seal	Contact the service company
	Too little clearance between objects inside the appliance or too many objects in the appliance	Provide for sufficient clearance between objects inside the appliance; remove the excess of objects
	Covered air inlet and/or air outlet	Make sure the air inlet and/or air outlet is free
Compressor does not switch automatically off	The appliance is overfilled	Remove the excess of objects
	Door is opened for too long	Limit the opening time of doors to minimum
Appliance operates loudly	Appliance is not placed on an even surface	Place the appliance on an even surface
	Appliance touches walls or other objects	Keep sufficient clearance from walls or other objects

Possible Malfunctions

The following phenomena are not malfunctions:

Various sounds that are generated by the appliance during operation are a normal phenomenon and do not indicate any malfunctions:

- Splashing, bubbling and hums are generated by the coolant that circulates the system.
- Short, louder whirring/hooting or clicking sounds may be heard when the compressor of the appliance starts for the pre-set temperature of the appliance internal chamber be restored.

Spare Parts

Spare parts for the purpose of repairing this appliance, as stipulated in Annex II to the REGULATION (EU) 2019/2018, are available for at least eight years, counted from the date of introduction of the last appliance of this model to market.

8 Disposal

Electrical Appliance

	<p>Electric appliances are marked with this symbol. Electrical appliances must be disposed of and recycled in a correct and environmentally friendly manner. You must not dispose of electric appliances with household waste. Disconnect the appliance from the power supply and remove power cord from the appliance.</p>
---	---

Electrical appliances should be returned to designated collection points.

Coolant

The propellant used in the appliance is flammable. It should be utilised pursuant to national regulations in force.