

W150



100083

Bartscher GmbH
Franz-Kleine-Str. 28
D-33154 Salzkotten
Germany

Phone: +49 5258 971-0

Fax: +49 5258 971-120

Technical Support Hotline: +49 5258 971-197

www.bartscher.com



Version: 3.0

Date of preparation: 2024-04-30

Original instruction manual

1	Safety	2
1.1	Explanation of Signal Words	2
1.2	Safety instructions.....	3
1.3	Intended Use	6
1.4	Unintended Use	6
2	General information	7
2.1	Liability and Warranty	7
2.2	Copyright Protection	7
2.3	Declaration of Conformity	7
3	Transport, Packaging and Storage	8
3.1	Delivery Check.....	8
3.2	Packaging	8
3.3	Storage	8
4	Technical Data.....	9
4.1	Technical Specifications	9
4.2	List of Components of the Appliance	10
4.3	Functions of the Appliance.....	11
5	Installation and operation	11
5.1	Installation.....	11
5.2	Operation	12
6	Cleaning and Descaling.....	15
6.1	Safety Instructions for Cleaning	15
6.2	Cleaning.....	15
6.3	Descaling.....	15
7	Possible Malfunctions.....	16
8	Disposal.....	18



Read this instruction manual before using and keep it available at all times!

This instruction manual contains information about installation, operation and maintenance of the appliance and constitutes an important source of information and reference guide. The knowledge of all operational and safety instructions included in this manual is a prerequisite for safe and proper handling of the appliance. Additionally, accident prevention, occupational health and safety, and legal regulations in force in the area the appliance is used apply.

Before you start using the appliance, especially before turning it on, read this instruction manual in order to avoid personal injuries and property damages. Improper use may cause damage.

This instruction manual forms an integral part of the product and must be stored in an immediate vicinity of the appliance and be available at all times. The instruction manual should be transferred together with the appliance.

1 Safety

This appliance has been manufactured in accordance with technical standards currently in force. However, the appliance may be a source of hazards if used improperly or contrary to its intended purpose. All persons using the appliance must consider information included in this instruction manual and observe safety instructions.

1.1 Explanation of Signal Words

Important safety instructions and warning information are indicated in this instruction manual with appropriate signal words. You must strictly follow the instructions, to prevent accidents, personal injuries and property damages.



DANGER!

The signal word **DANGER** warns against hazards that lead to severe injuries or death if the hazards are not avoided.



WARNING!

The signal word **WARNING** warns against hazards that may lead to moderate or severe injuries or death if the hazards are not avoided.



CAUTION!

The signal word **CAUTION** warns against hazards that may lead to light or moderate injuries if the hazards are not avoided.

IMPORTANT!

The signal word **IMPORTANT** indicates possible property damages, which may occur if safety instructions are not observed.

NOTE!

The symbol **NOTE** indicates subsequent information and guidelines for the user on usage of the appliance.

1.2 Safety instructions

Electrical Current

- Too high a mains voltage or incorrect installation may cause electric shock.
- The appliance may be connected only if data on the rating plate correspond with the mains voltage.
- To avoid short-circuit, the appliance should be kept dry.
- If there are malfunctions during operation, disconnect the appliance from the power supply.
- Do not touch the appliance's plug with wet hands.
- Never take hold of the appliance if it has fallen into water. Immediately disconnect the appliance from the power supply.
- Any repairs or housing opening may be carried out by professionals and relevant workshops only.
- Do not transport the appliance, holding it by the power cord.
- Do not allow the power cord to come into contact with heat sources or sharp edges.
- Do not bend, pinch nor knot the power cord.

- Always completely unwind the power cord.
- Never place the appliance or other objects on the power cord.
- Always take hold of the plug to disconnect the appliance from the power supply.
- Check the power cord regularly for damage. Do not use the appliance if the power cord is damaged. If this cable is damaged, it must be replaced by customer service or a qualified electrician in order to avoid dangers.

Fire hazard / flammable materials hazard / explosion hazard!

- Do not use any electric devices in the appliance.
- Do not store nor use petrol or other flammable liquids and gases in the vicinity of this or any other appliance. Those gases may cause fire or explosion hazard.
- Do not put into the appliance any explosive materials, like sprays filled with flammable propellants. Contents of containers filled with flammable gases and liquids may leak in low temperatures, and the contents may catch fire from sparks generated by an electric appliance. Explosion hazard!
- In the case of coolant leakage, pull the plug from the socket. Remove all sources of ignition in the vicinity, ventilate room and contact technical service. Avoid coolant getting in contact with eyes, as it may cause serious eye damage.
- Never use any flammable liquids for cleaning the appliance or its parts. Gases released may cause fire or explosion hazard.
- In the case of fire, disconnect the appliance from the power supply before attempting adequate fire-extinguishing actions.
- Never attempt to extinguish fire with water if the appliance is connected to the power supply. Following extinction of fire, ensure sufficient fresh air inflow.
- Defrosting process may not be sped up with mechanical means or heat energy sources (candles or heaters) nor with any other means. Vapour produced may cause short-circuit and too high temperatures may damage the appliance.
- All ventilation slots should not be obstructed during operation.
- Never attempt to damage cooling installation of the appliance.

Safety

Operating Personnel

- The device can be used by children of 8 years old and older, as well as by people with reduced physical, sensory or mental abilities and those with limited experience/knowledge as long as they are under supervision or have been instructed on safe use of the device and possible risks. Children should not play with the device.
- Cleaning and user maintenance may not be performed by children.

Improper Use

- Unintended or prohibited use may cause damage to the appliance.
- The appliance may only be used when its technical condition is flawless and allows for safe operation.
- The appliance may only be used when all connections are executed according to rules of law in force.
- The appliance may only be used when it is clean.
- Use only original spare parts. Never attempt to repair the appliance on your own.
- Do not introduce any changes in the appliance nor modify it.
- Do not drill hole in the appliance nor install any objects on it.
- Do not place any heavy objects on the appliance.

1.3 Intended Use

As described below, every use of the appliance for a purpose differing and/or diverging from its intended standard use, is prohibited and considered to be an unintended use.

The following is an intended use:

- Ice cube preparation.

This appliance is intended for use in households and similar places, e.g.:

- in employee canteens in shops, offices, and similar areas;
- on farms;
- by customers in hotels, motels, and other typical accommodation establishments;
- in lodging-houses.

1.4 Unintended Use

An unintended use may lead to personal injuries or property damages caused by hazardous voltage, fire or high temperature. The appliance may only be used to perform tasks described in this instruction manual.

2 General information

2.1 Liability and Warranty

All information and instructions in this instruction manual account for legal regulations in force, current level of technical engineering knowledge as well as our expertise and experience, developed over the years. If special models or additional options are ordered, or state-of-the-art technical solutions were implemented, the actual scope of delivery of the appliance may, in some circumstances, differ from descriptions and numerous drawings in this instruction manual.

The manufacturer is not liable for any damages nor faults stemming from:

- failure to observe instructions,
- unintended use,
- technical alterations introduced by the user,
- usage of unapproved spare parts.

We reserve the right to introduce technical modifications to the product, intended for improvement of the appliance and its performance.

2.2 Copyright Protection

This instruction manual, and texts, drawings and images included in it, as well as its other components are copyright protected. It is prohibited to reproduce this instruction manual (including its excerpts), in any form and by any means, and to use and/or transfer its content to third parties without manufacturer's written permission. Violation of the above results in obligation to pay compensation. We reserve the right to claim further damages.

EN

2.3 Declaration of Conformity

The appliance meets the currently applicable standards and guidelines of the European Union. We confirm the above in the EC Declaration of Conformity. We may provide relevant Declaration of Conformity upon request.

3 Transport, Packaging and Storage

3.1 Delivery Check

Immediately upon reception, check the delivery for completeness and possible shipping damage. In the case of visible transport damage refuse to accept the appliance or accept it conditionally. Mark and note the scope of damage in shipping documents/consignment list of the shipping company and lodge a complaint.

Concealed damage must be reported immediately upon its discovery, as compensation claims may only be filed within applicable time limits.

If you find that parts or accessories missing, please contact our Customer Service Department.

3.2 Packaging

Do not dispose of the appliance cardboard box. It may be used to store the appliance when relocating or when shipping the appliance to our service point in the case of any damages.

The packaging and its elements are made of recyclable materials. Particularly, these are: plastic films and bags, cardboard box.

When disposing of the packaging, observe applicable domestic regulations. Recyclable packaging materials should be recycled.

3.3 Storage

Leave the packaging closed until installation of the appliance; observe external indications concerning method of placing and storage. Store the packaging in the following conditions only:

- in closed rooms;
- in dry and dust-free surrounding;
- away from aggressive agents;
- in a location protected against sunlight;
- in a location protected against mechanical shocks.

In the case of extended storage (over three months), make sure you check the condition of the packaging and the parts regularly. If needed, replace the packaging with a new one.

4 Technical Data

4.1 Technical Specifications

Name:	Ice-cube maker W150
Art. No.:	100083
Material:	Plastic
Tank volume, in litres:	2,3
Output / work cycle, pcs.:	24
Max. output, in kg /h:	15 / 24
Storage container capacity, in kg:	1,0
Coolant / amount in kg:	R600a / 0,035
Climate class:	ST
Power supply:	0,24 kW 220-240 V 50 Hz
Dimensions (W x D x H) in mm:	280 x 380 x 345
Weight in kg:	10,4

We reserve the right to implement technical modifications!

Version / characteristics

- Ice cube design: cube, clear
- Water tank yield: up to 360 ice cubes
- Water outlet: underside
- Fill level sensor
- Production method: vertical evaporator system
- Cooling: compressor
- Control: button, electronic
- ON/OFF switch
- Indicator lights:
 - ON/OFF
 - storage tank full
 - refill tank
- The set includes: 1 ice shovel

4.2 List of Components of the Appliance

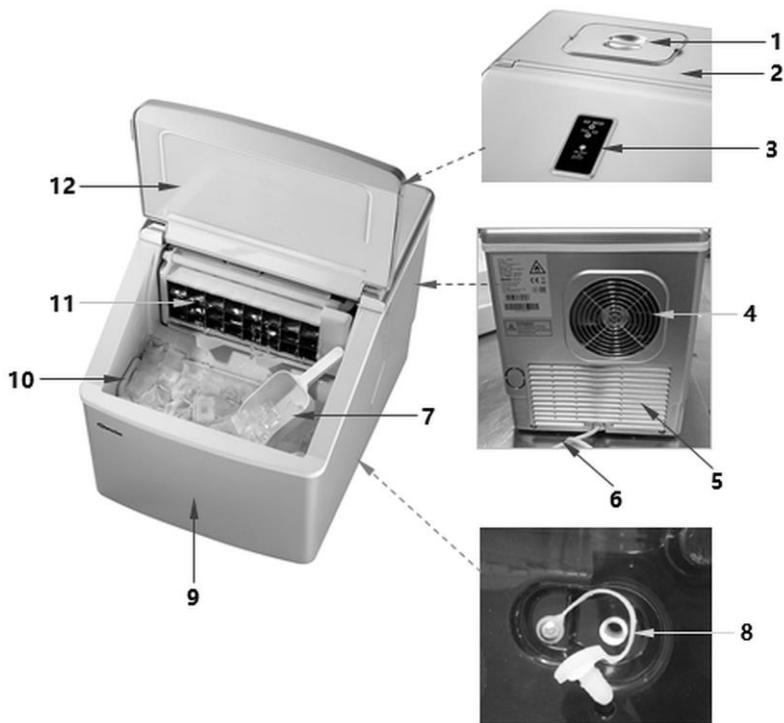

Fig. 1

1. Water tank lid
2. Water tank
3. Control panel
4. Fan with a grate
5. Ventilation openings
6. Power cord
7. Ice shovel
8. Water drain with a cap
9. Housing
10. Storage container
11. Ice chute
12. Storage container lid

4.3 Functions of the Appliance

The ice-cube maker is designed for production of cube form ice cubes (clear). It may output up to 15 kg of ice cubes within 24 hours.

5 Installation and operation

5.1 Installation

Unpacking / Positioning

- Unpack the appliance, remove all external and internal packaging elements and shipment safeguards.



CAUTION!

Choking hazard!

Prevent children from accessing package materials, for instance: plastic bags and EPS.

- If the appliance is covered with a protective film, remove it. Remove the film slowly, so no glue residues are left. Remove any glue residues with the use of a suitable solvent.
- Be careful not to damage the rating plate and warning labels fixed on the appliance.
- **Never** place the appliance in humid or wet environment.
- Place the appliance in a way making the connections easily accessible, so that they may be quickly disconnected if such a need arises.
- The appliance should be placed on surfaces that are:
 - even, with sufficient bearing capacity, resistant to water, dry and resistant to high temperatures;
 - sufficiently large, and thus enabling usage of the appliance with no problems;
 - easily accessible;
 - well ventilated.
- Do not position the appliance in high humidity locations. Air relative humidity should not exceed 70%.
- Do not place the appliance in direct sunlight or in the vicinity of heat sources (cooker, radiator, heating devices, etc.). Heat sources may negatively affect power consumption, and restrict functions of the appliance, too.

- In order to avoid damage to the compressor, do not tilt the appliance more than 45° when positioning or transporting it.
- Keep minimum distance from walls and objects; maintain clearance of 15 cm at both sides and at the rear, and 20 cm over the appliance.
- The appliance should be installed only in rooms, in which ambient temperature falls in the range of 10°C – 32 °C.

Power supply connection

- Verify if technical data of the appliance (see rating plate) correspond with the local electric power grid specification.
- Connect the appliance to a single, properly grounded mains socket with protective contact. Do not connect the appliance to a multi-socket.
- The power cord should be laid in a way preventing anyone from threading on it or tripping against it.
- If in winter the appliance is brought from the outside to a room, leave it for a few hours to heat up and reach the room temperature before switching it on.
- Before connecting the appliance to the power supply, wait 1 hour for the coolant to stabilize.
- After a power failure or when the plug is removed from the socket, reconnect the appliance to the power supply after 5 minutes at the earliest.

EN

5.2 Operation

Appliance Preparation

1. Before the first use, clean the appliance and its accessories observing the instructions in section **6 'Cleaning'**.
2. To end with, dry the appliance and accessories thoroughly.
3. Insert the storage tank.
4. Remove the water tank lid.
5. Fill the water tank with fresh drinking water.

ATTENTION!

Do not fill with water the tank underneath the storage container.

6. Make sure the water level does not exceed the 'FULL' marking.
7. Place the lid on the water tank.

Control Panel

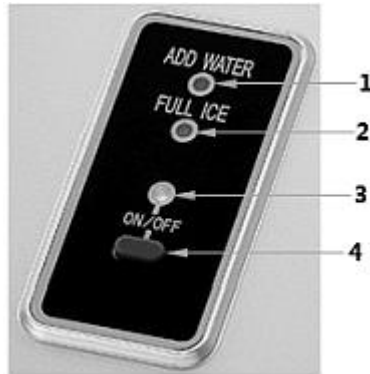

Fig. 2

1. Water tank indicator light
2. Storage container indicator light
3. ON/OFF indicator light
4. ON/OFF switch

EN

Switching On

1. Connect the appliance to a single grounded socket.
2. Switch the appliance on with the ON/OFF switch.

The ice cubes production process is started. Depending on the ambient temperature, the production cycle lasts approx. 15–20 minutes.

3. To change the size of the ice cubes, press and hold the ON/OFF switch for 5 seconds.

The ice cube production cycle is approx. 3 minutes longer and thus the ice cubes become a little bit thicker.

4. Make sure you check the water level in the bottom tank underneath the storage container regularly during operation of the appliance.

If there is not enough water to carry out the ice cubes production cycle, the appliance automatically drains water from the large water tank to the bottom tank to continue ice cubes production.

If there is not enough water in both bottom and large water tank, the appliance automatically stops and the 'ADD WATER' indicator light is lit.

5. Switch the appliance off with the ON/OFF switch.

6. Fill the water tank with fresh drinking water, up to 'FULL' marking.
7. Wait a short while and run the production process, using ON/OFF switch to this end.

CAUTION!

To provide for proper hygiene, exchange the water in water tank every 24 hours.

The appliance automatically stops the production process when the storage container is full.

The 'FULL ICE' indicator light is lit.

8. Open the storage container lid and use the ice shovel to take the ice cubes out of the storage container.

When the ice cubes are removed, the production of ice is continued.

CAUTION!

Due to hygienic reasons, ice cubes produced during the first production process should be disposed of; do not use them to cool beverages nor food products.

EN

9. When the appliance is not to be used any more, it should be switched off with the ON/OFF switch.
10. Remove the water drain cap on the underside of the appliance and drain water from the water tank.

NOTE!

If the appliance will not be used for a prolonged time, drain the water from both the main and bottom water tank, using to this end the water drain on the underside of the appliance.

If the appliance is to be operated again after a longer break, conduct 2–3 ice cubes production cycles using fresh water in order to remove bacteria. Ice cubes produced in the process should be disposed of.

6 Cleaning and Descaling

6.1 Safety Instructions for Cleaning

- Before cleaning, disconnect the appliance from the power supply.
- Leave the appliance to cool down completely.
- Make sure water does not enter the appliance. Do not immerse the appliance in water or other liquids during cleaning. Do not clean the appliance with a pressurized water jet.
- Do not use any sharp or pointed, nor metal implements (knife, fork, etc.). Sharp or pointed implements may damage the appliance, and when in contact with live parts, they may cause electric shock.
- For cleaning, do not use any scouring agents that contain solvents nor corrosive cleaning agents. They may damage the surface.

6.2 Cleaning

1. At the end of a working day, clean the appliance thoroughly.
2. Remove the storage container.
3. Wash the storage container in warm water.
4. Remove the water drain cap on the underside of the appliance to drain water.
5. Clean the appliance inside and outside with warm water and a mild cleaning agent.
6. Rinse in fresh water.
7. Re-attach the cap on the water drain.
8. After cleaning, dry and polish the surface with a soft and dry cloth.

6.3 Descaling

Inappropriate water may lead to scale deposit in the water tank of the appliance. These deposits may negatively affect the operation of the appliance. For this reason, the appliance should be regularly descaled.

1. For descaling purposes, use a solution of water and vinegar or commercially available descaling agent. Follow the product manufacturer's instructions.
2. Fill the water tank with the solution.
3. Run the production cycle.
4. Remove the water drain cap on the underside of the appliance.
5. Drain water from the water tank through the water drain.

- Using fresh water, conduct 1–2 more production cycles, to remove all residues of descaling solution.

CAUTION!

Dispose of the produced ice cubes; do not use them for cooling beverages not food products!

- Once again drain water from the water tank.
- Re-attach the cap on the water drain.

7 Possible Malfunctions

The table below contains descriptions of possible causes and solutions to malfunctions or errors during operation of the appliance. When malfunction cannot be removed, contact the technical service.

In such a case, provide article number, model name and serial number. These data may be found in the rating plate.

Error	Possible Cause	Solution
The 'Add Water' indicator light is lit.	No water.	Stop the appliance. Fill the water tank with fresh drinking water, up to the 'FULL' marking. Press the ON/OFF switch to restart the appliance.
The 'FULL ICE' indicator light is lit.	There is too much ice in the storage container.	Take the ice out of the storage container.

Possible Malfunctions

Error	Possible Cause	Solution
The water tank is filled, but the 'ADD WATER' indicator light is lit.	Water is not pure, or there are foreign objects in it.	Fill with fresh drinking water.
	The filter in the bottom tank underneath the storage container is clogged.	Clean the water filter.
Water flows out of the water drain at the rear wall of the appliance.	The water drain is obstructed.	Clean the water drain.
The appliance does not start the ice production.	The water is not pure enough.	Fill with fresh drinking water.
	The wall of the bottom tank underneath the storage container is dirty.	Clean the bottom tank.
Ice cubes are brittle.	Ambient temperature too high.	Press and hold the ON/OFF switch for 5 seconds. The ice cubes production cycle will be extended.
Ice cubes are not being produced.	The ambient temperature or water temperature in the bottom tank is too high.	The appliance should be used in an environment with ambient temperature up to 32 °C and with cold water in the water tank.
	Coolant is leaking.	Contact the service company.
	A tube obstructed in the cooling system.	Contact the service company.

The following phenomena are not malfunctions:

- During normal operation, a sound of water flowing is heard. This is a sound of coolant flowing through the installation.

8 Disposal

Electrical Appliance

	<p>Electric appliances are marked with this symbol. Electrical appliances must be disposed of and recycled in a correct and environmentally friendly manner. You must not dispose of electric appliances with household waste. Disconnect the appliance from the power supply and remove power cord from the appliance.</p>
---	---

Electrical appliances should be returned to designated collection points.

Coolant

The propellant used in the appliance is flammable. It should be utilised pursuant to national regulations in force.