

2120



135022

Bartscher GmbH
Franz-Kleine-Str. 28
D-33154 Salzkotten
Germany

Phone: +49 5258 971-0
Fax: +49 5258 971-120
Service hotline: +49 5258 971-197
www.bartscher.com



Version: 1.0

Date of preparation: 2023-03-31

Original instruction manual

1	Safety	2
1.1	Explanation of Signal Words	2
1.2	Safety instructions.....	3
1.3	Intended Use	6
1.4	Unintended Use	6
2	General information	7
2.1	Liability and Warranty	7
2.2	Copyright Protection	7
2.3	Declaration of Conformity	7
3	Transport, Packaging and Storage	8
3.1	Delivery Check.....	8
3.2	Packaging	8
3.3	Storage	8
4	Technical Data.....	9
4.1	Technical Specifications	9
4.2	Functions of the Appliance.....	10
4.3	List of Components of the Appliance	11
5	Installation and operation	13
5.1	Installation.....	13
5.2	Operation	15
6	Cleaning	18
6.1	Safety Instructions for Cleaning	18
6.2	Cleaning.....	19
7	Possible Malfunctions.....	31
8	Disposal.....	32



Read this instruction manual before using and keep it available at all times!

This instruction manual contains information about installation, operation and maintenance of the appliance and constitutes an important source of information and reference guide. The knowledge of all operational and safety instructions included in this manual is a prerequisite for safe and proper handling of the appliance. Additionally, accident prevention, occupational health and safety, and legal regulations in force in the area the appliance is used apply.

Before you start using the appliance, especially before turning it on, read this instruction manual in order to avoid personal injuries and property damages. Improper use may cause damage.

This instruction manual forms an integral part of the product and must be stored in an immediate vicinity of the appliance and be available at all times. The instruction manual should be transferred together with the appliance.

1 Safety

This appliance has been manufactured in accordance with technical standards currently in force. However, the appliance may be a source of hazards if used improperly or contrary to its intended purpose. All persons using the appliance must consider information included in this instruction manual and observe safety instructions.

1.1 Explanation of Signal Words

Important safety instructions and warning information are indicated in this instruction manual with appropriate signal words. You must strictly follow the instructions, to prevent accidents, personal injuries and property damages.



DANGER!

The signal word **DANGER** warns against hazards that lead to severe injuries or death if the hazards are not avoided.



WARNING!

The signal word **WARNING** warns against hazards that may lead to moderate or severe injuries or death if the hazards are not avoided.



CAUTION!

The signal word **CAUTION** warns against hazards that may lead to light or moderate injuries if the hazards are not avoided.

IMPORTANT!

The signal word **IMPORTANT** indicates possible property damages, which may occur if safety instructions are not observed.

NOTE!

The symbol **NOTE** indicates subsequent information and guidelines for the user on usage of the appliance.

1.2 Safety instructions

Electrical Current

- Too high a mains voltage or incorrect installation may cause electric shock.
- The appliance may be connected only if data on the rating plate correspond with the mains voltage.
- To avoid short-circuit, the appliance should be kept dry.
- If there are malfunctions during operation, disconnect the appliance from the power supply.
- Do not touch the appliance's plug with wet hands.
- Never take hold of the appliance if it has fallen into water. Immediately disconnect the appliance from the power supply.
- Any repairs or housing opening may be carried out by professionals and relevant workshops only.
- Do not transport the appliance, holding it by the power cord.
- Do not allow the power cord to come into contact with heat sources or sharp edges.
- Do not bend, pinch nor knot the power cord.

- Always completely unwind the power cord.
- Never place the appliance or other objects on the power cord.
- Always take hold of the plug to disconnect the appliance from the power supply.
- Check the power cord regularly for damage. Do not use the appliance if the power cord is damaged. If this cable is damaged, it must be replaced by customer service or a qualified electrician in order to avoid dangers.

Fire hazard / flammable materials hazard / explosion hazard!

- Do not use any electric devices in the appliance.
- Do not store nor use petrol or other flammable liquids and gases in the vicinity of this or any other appliance. Those gases may cause fire or explosion hazard.
- Do not put into the appliance any explosive materials, like sprays filled with flammable propellants. Contents of containers filled with flammable gases and liquids may leak in low temperatures, and the contents may catch fire from sparks generated by an electric appliance. Explosion hazard!
- In the case of coolant leakage, pull the plug from the socket. Remove all sources of ignition in the vicinity, ventilate room and contact technical service. Avoid coolant getting in contact with eyes, as it may cause serious eye damage.
- Never use any flammable liquids for cleaning the appliance or its parts. Gases released may cause fire or explosion hazard.
- In the case of fire, disconnect the appliance from the power supply before attempting adequate fire-extinguishing actions.
- Never attempt to extinguish fire with water if the appliance is connected to the power supply. Following extinction of fire, ensure sufficient fresh air inflow.
- Defrosting process may not be sped up with mechanical means or heat energy sources (candles or heaters) nor with any other means. Vapour produced may cause short-circuit and too high temperatures may damage the appliance.
- All ventilation slots should not be obstructed during operation.
- Never attempt to damage cooling installation of the appliance.

Safety

Operating personnel

- This appliance is not intended to be used by persons (including children) with limited physical, sensory or mental capabilities, nor by persons with limited experience and/or limited knowledge.
- Children should be supervised to ensure that they are not playing with or switching the appliance on.

Improper Use

- Unintended or prohibited use may cause damage to the appliance.
- The appliance may only be used when its technical condition is flawless and allows for safe operation.
- The appliance may only be used when all connections are executed according to rules of law in force.
- The appliance may only be used when it is clean.
- Use only original spare parts. Never attempt to repair the appliance on your own.
- Do not introduce any changes in the appliance nor modify it.

1.3 Intended Use

As described below, every use of the appliance for a purpose differing and/or diverging from its intended standard use, is prohibited and considered to be an unintended use.

The following is an intended use:

- Preparation of slushies and cold drinks.

1.4 Unintended Use

An unintended use may lead to personal injuries or property damages caused by hazardous voltage, fire or high temperature. The appliance may only be used to perform tasks described in this instruction manual.

2 General information

2.1 Liability and Warranty

All information and instructions in this instruction manual account for legal regulations in force, current level of technical engineering knowledge as well as our expertise and experience, developed over the years. If special models or additional options are ordered, or state-of-the-art technical solutions were implemented, the actual scope of delivery of the appliance may, in some circumstances, differ from descriptions and numerous drawings in this instruction manual.

The manufacturer is not liable for any damages nor faults stemming from:

- failure to observe instructions,
- unintended use,
- technical alterations introduced by the user,
- usage of unapproved spare parts.

We reserve the right to introduce technical modifications to the product, intended for improvement of the appliance and its performance.

2.2 Copyright Protection

This instruction manual, and texts, drawings and images included in it, as well as its other components are copyright protected. It is prohibited to reproduce this instruction manual (including its excerpts), in any form and by any means, and to use and/or transfer its content to third parties without manufacturer's written permission. Violation of the above results in obligation to pay compensation. We reserve the right to claim further damages.

EN

2.3 Declaration of Conformity

The appliance meets the currently applicable standards and guidelines of the European Union. We confirm the above in the EC Declaration of Conformity. We may provide relevant Declaration of Conformity upon request.

3 Transport, Packaging and Storage

3.1 Delivery Check

Immediately upon reception, check the delivery for completeness and possible shipping damage. In the case of visible transport damage refuse to accept the appliance or accept it conditionally. Mark and note the scope of damage in shipping documents/consignment list of the shipping company and lodge a complaint. Concealed damage must be reported immediately upon its discovery, as compensation claims may only be filed within applicable time limits.

If you find that parts or accessories missing, please contact our Customer Service Department.

3.2 Packaging

Do not dispose of the appliance cardboard box. It may be used to store the appliance when relocating or when shipping the appliance to our service point in the case of any damages.

The packaging and its elements are made of recyclable materials. Particularly, these are: plastic films and bags, cardboard box.

When disposing of the packaging, observe applicable domestic regulations. Recyclable packaging materials should be recycled.

3.3 Storage

Leave the packaging closed until installation of the appliance; observe external indications concerning method of placing and storage. Store the packaging in the following conditions only:

- in closed rooms;
- in dry and dust-free surrounding;
- away from aggressive agents;
- in a location protected against sunlight;
- in a location protected against mechanical shocks.

In the case of extended storage (over three months), make sure you check the condition of the packaging and the parts regularly. If needed, replace the packaging with a new one.

4 Technical Data

4.1 Technical Specifications

Name:	Slush machine 2120
Art. No.:	135022
Material:	stainless steel, plastic
Tank material:	polycarbonate
Spindle material:	stainless steel, plastic
Number of tanks:	2
Capacity of each tank, in l:	12
Temperature range, min.–max., in °C:	-2 - -5
Amount of coolant, in kg:	R290 / 0,162
Working time, in hours:	12
Degree of protection:	1
Connected load:	1.1 kW 220-230 V 50 Hz
Dimensions (W x D x H), in mm:	400 x 520 x 815
Weight, in kg:	39,6

We reserve the right to implement technical modifications.

Version / Design

- Temperature settings:
 - slushes
 - cold drinks / night mode
- Temperature control:
 - rocker switch
 - switched on separately
- Cooling: compressor
- Lighting:
 - on lid
 - included separately for each tank
- Drain tray(s): removable
- ON/OFF switch

4.2 Functions of the Appliance

The device is used to prepare and serve slushies and/or cold drinks at fairs, amusement parks and swimming pools, as well as in bars or discos.

Settings for both tanks can be made separately. Separately switchable lighting for both 12-litres tanks perfectly exposes colourful slushies or cocktails – for up to 12 hours of continuous use.

4.3 List of Components of the Appliance

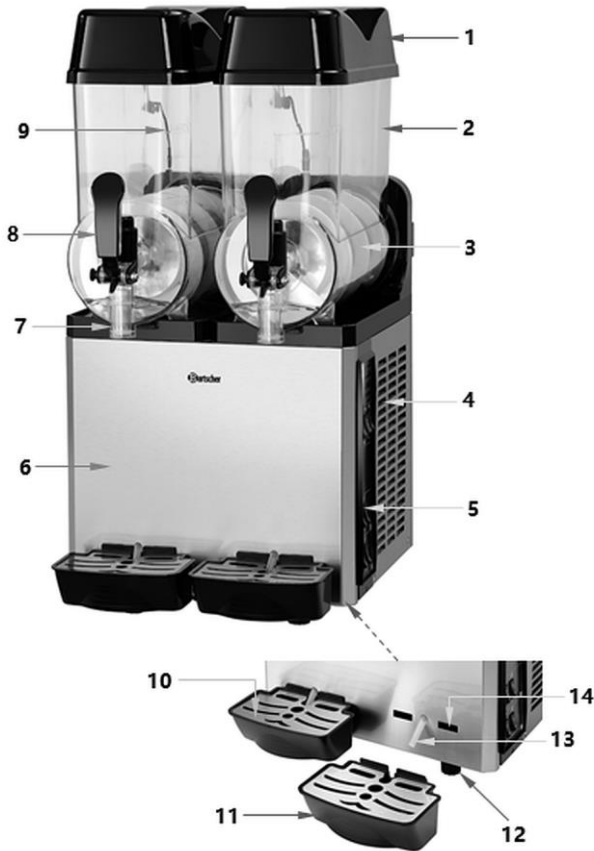

EN

- | | |
|--------------------------------|--|
| 1. Tank lid (2x) | 2. Tank (2x) |
| 3. Spindle | 4. Ventilation openings |
| 5. Control panel | 6. Housing |
| 7. Drain tube | 8. Drain tap (2x) |
| 9. LED lighting cable | 10. Drip tray (2x) |
| 11. Drip tray (2x) | 12. Foot (4 x) |
| 13. Condensate drain pipe (2x) | 14. Mounting slots for drain tray (4x) |

Fig. 1

Control elements

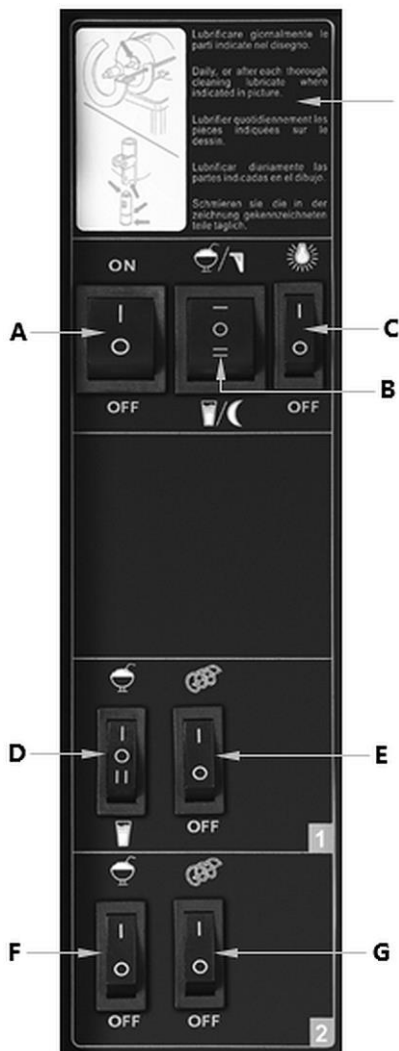

Tip for daily cleaning

Follow the instructions in section 6.2 „Daily Cleaning“.

A	Main ON/OFF switch
B	Slush / cold drink selector switch – night mode
C	LED lighting switch
D	Slush/cold drink selector switch tank 1
E	On/off switch spindle for tank 1
F	Slush/off switch Tank 2
G	On/off switch spindle for tank 2

Fig. 2

5 Installation and operation

5.1 Installation

Unpacking / Positioning

- Unpack the appliance, remove all external and internal packaging elements and shipment safeguards.



CAUTION!

Choking hazard!

Prevent children from accessing package materials, for instance: plastic bags and EPS.

- If the appliance is covered with a protective film, remove it. Remove the film slowly, so no glue residues are left. Remove any glue residues with the use of a suitable solvent.
- Be careful not to damage the rating plate and warning labels fixed on the appliance.
- **Never** place the appliance in humid or wet environment.
- Place the appliance in a way making the connections easily accessible, so that they may be quickly disconnected if such a need arises.
- The appliance should be placed on surfaces that are:
 - even, with sufficient bearing capacity, resistant to water, dry and resistant to high temperatures;
 - sufficiently large, and thus enabling usage of the appliance with no problems;
 - easily accessible;
 - well ventilated.
- Maintain sufficient clearance from table edges. The appliance might turn over and fall down.
- Do not place the appliance in direct sunlight or in the vicinity of heat sources (cooker, radiator, heating devices, etc.). Heat sources may negatively affect power consumption, and restrict functions of the appliance, too.
- The optimum ambient temperature at the installation site is 25 °C – 32 °C.
- Do not position the appliance in high humidity locations. Air relative humidity should not exceed 70%.
- In order to avoid damage to the compressor, do not tilt the appliance more than 45° when positioning or transporting it.

- Place the appliance so that sufficient air circulation is ensured. Do not obstruct nor cover ventilation openings of the appliance.
- Leave a clearance of at least 25 cm at all sides from walls and other objects.

Power supply connection

- Verify if technical data of the appliance (see rating plate) correspond with the local electric power grid specification.
- Connect the appliance to a single, properly grounded mains socket with protective contact. Do not connect the appliance to a multi-socket.
- The power cord should be laid in a way preventing anyone from threading on it or tripping against it.

5.2 Operation

Before use

1. Prior to first operation, clean the appliance and its equipment observing instructions in section **6 'Cleaning'**.
2. To end with, dry the appliance and accessories thoroughly.
3. Reattach the removed elements back in the device. Follow the instructions in section **'Installation of the device'**.

Preparation of Ingredients

1. Prepare all the products needed to prepare slushies or cold drinks.
2. Mix the ingredients in a separate tank, if it is a liquid concentrate or powder to be mixed with water, dilute exactly according to the manufacturer's instructions.

NOTE!

The sugar content must be at least 13% so that the spindle spiral does not stop. Sugar water has a lower melting point than pure water

3. Only fill the container with prepared ingredients up to the "MAX" mark.

ATTENTION!

Never start the machine with no product or only water in the tanks.

Always pay attention to the filling level in the tank, it should not be below the MIN mark.

Always fill the tank with chilled ingredients only when the fill level is between the MIN and MAX marks. In this way, customers always have frozen drinks at their disposal.

Never add hot product.

Adjusting the slushie consistency

The machine has been factory set to 'normal' for making slushies.

1. For milk or other products that require a longer time to freeze, change the setting to 'medium' or 'maximum' by turning the adjusting wheel (a) in the "+" direction as shown in Fig. 3.

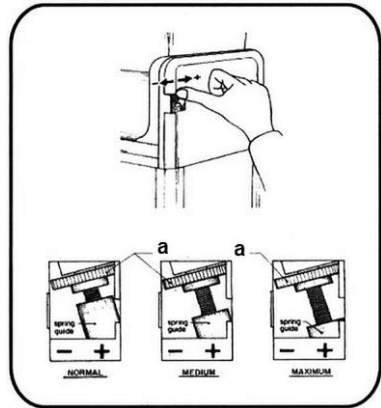

Fig. 3

Switching-On

1. Plug the device into a suitable single socket.
2. Switch the ON/OFF switch (A, Fig. 4) to the 'I' position.
3. Turn the spindle on/off switches (E) for tank 1 and (G) for tank 2 to the 'I' position.
4. Switches (B), (D) and (F) turn to the "I" position to activate the cooling/freezing mode.
5. If necessary, switch the LED lighting switch (C) to the 'I' position to illuminate the tanks.

LED lighting is located under the covers of the tanks.

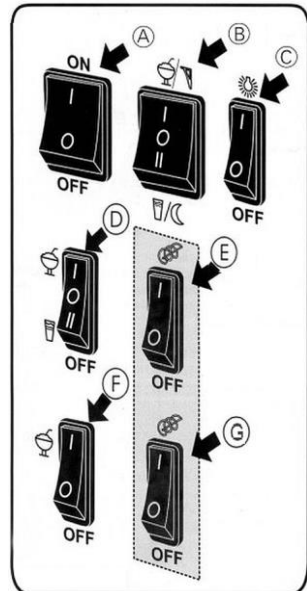

Fig. 4

Installation and operation

The slushie machine is designed to produce liquid cold drinks and slushies simultaneously in one or both tanks.

However, the left tank is for cold drinks. To prepare a cold drink in this tank, set the switch (D) to the "Cooling" position, as shown in Fig. 5.

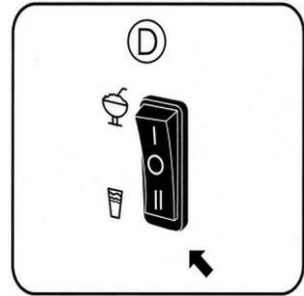

Fig. 5

Turning off the device / turning on night mode

1. To turn off the slush machine, press the main on/off switch (A) to the 'O' position.
2. If the product is to remain in the slushie machine overnight, the switch (B) must be set to the night position (fig. 6).

This setting keeps the refrigerated product in a liquid state and extends the life of the compressor.

3. Make sure that the tanks are sufficiently filled.

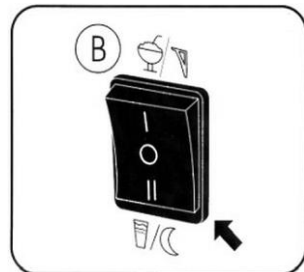

Fig. 6

Pouring slushies and cold drinks.



Fig. 7

1. Pour prepared slushies or cold beverages from the tanks as needed.
2. Hold a glass under the drain pipe and press the drain tap downwards.
3. Serve a slushie or a cold drink.

6 Cleaning

EN

6.1 Safety Instructions for Cleaning

- Before cleaning, disconnect the appliance from the power supply.
- Leave the appliance to cool down completely.
- Make sure water does not enter the appliance. Do not immerse the appliance in water or other liquids during cleaning. Do not clean the appliance with a pressurized water jet.
- Do not use any sharp or pointed, nor metal implements (knife, fork, etc.). Sharp or pointed implements may damage the appliance, and when in contact with live parts, they may cause electric shock.
- For cleaning, do not use any scouring agents that contain solvents nor corrosive cleaning agents. They may damage the surface.

ATTENTION!

Never use hot water to clean plastic parts.

6.2 Cleaning

Daily Cleaning

1. Clean the appliance thoroughly after each use.

ATTENTION!

Ensure that the tanks are completely empty before removing.

2. Drain the slushie and cold drink from the tanks through the drain tap.
3. Remove the covers from the tanks.

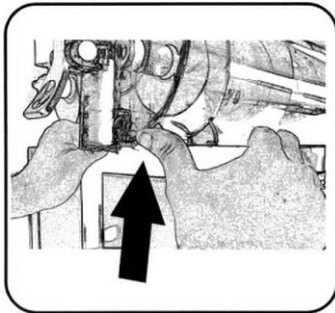

Fig. 8

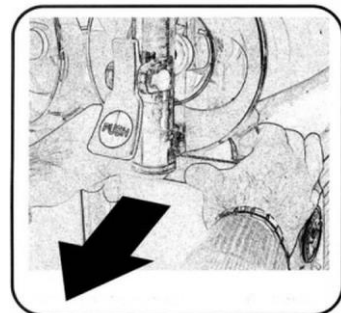

Fig. 9

4. Lift the tanks at the front until the tank feet pop out as shown in the picture above.
5. Slowly remove the tanks as shown in the picture.

6. Wash tanks with lukewarm water.

ATTENTION!

Never use dish washing liquid, it can damage the material and cause it to become cloudy.

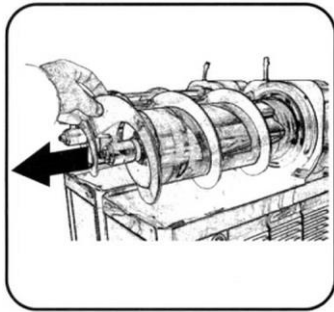

Fig. 10

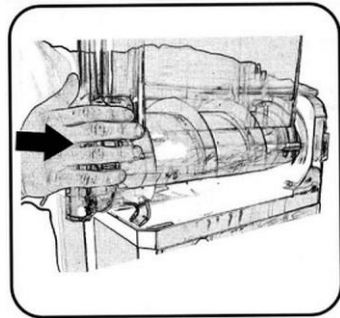

Fig. 11

7. Remove the spiral
8. Remove the large gasket on the back of the machine.
9. Clean the components with warm water and a food grade disinfectant.

10. Reinstall items:

- replace the gasket.

Make sure the gasket is seated properly and there are no gaps at the back. It is best to install the gasket starting from the bottom and pressing it up with your thumbs on each side;

- insert the spindle;
- insert the tanks: slide them on and press them against the gasket.

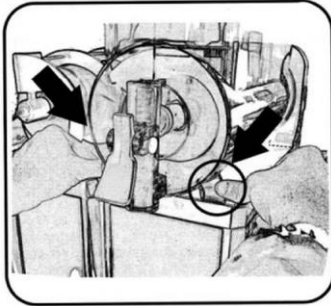

Fig. 12

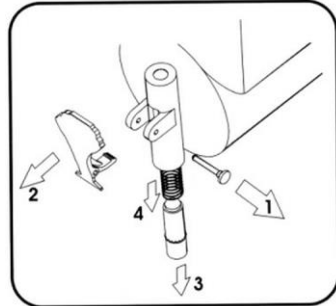

Fig. 13

11. Use your thumbs to press on both legs until they click into place.
12. Reattach the cover.

13. Remove the outlet with the drain tap in the following order:

1. Mandrel
2. Handle
3. Drain tube
4. Drain Tap Spring

14. Clean the elements of the drain cock in warm water with a disinfectant.

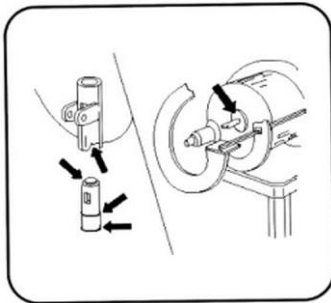

Fig. 14

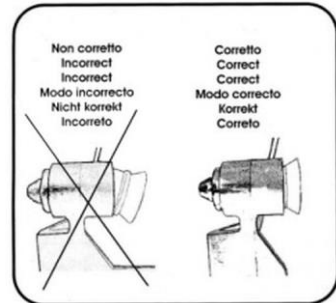

Fig. 15

15. The places marked in Fig. 14 should be moistened with water daily or after each thorough cleaning.

16. Press the suction nozzle seal deep into the spiral head. Make sure the cap seal is positioned correctly as shown in Fig. 15.

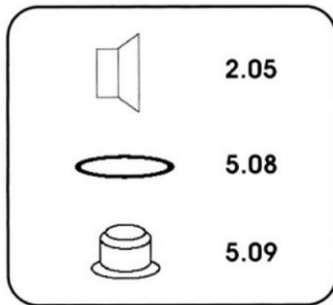

Fig. 16

17. Check the following items monthly:
- 5.08 – O-ring of the drain cock
 - 5.09 – bottom gasket of the drain tap
 - 2.05 – suction cap gasket

Disinfection

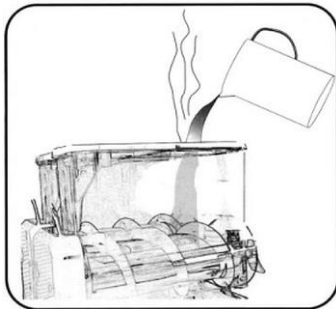
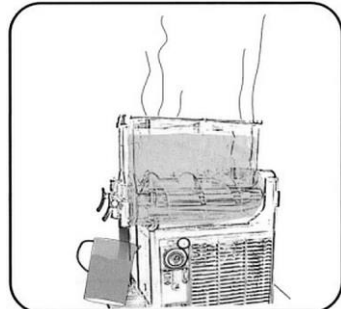

Fig. 17



1. Switch the appliance off.
2. Fill the tank with lukewarm water and empty it through the drain tap (Fig. 17, 18).
3. To make it easier to remove the tank, follow the instructions in Figures 19 and 20.

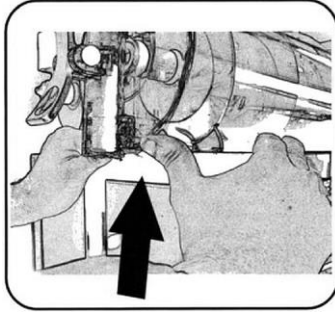

Fig. 19

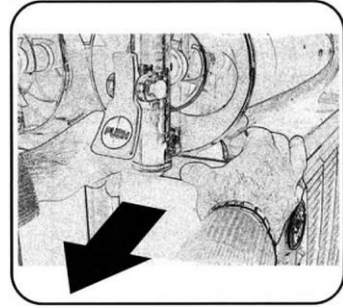

Fig. 20

4. Place your fingers under the front bottom of the tank near the drain cock and push it up until the legs pop out.
5. Place your fingers behind the tank feet and slowly pull the tank forward until it is completely removed.
6. Store all items in a safe place so that they do not get lost.
7. Wash the elements with dish washing liquid and lukewarm water. **Never use scouring agents..**

Subsequent cleaning processes

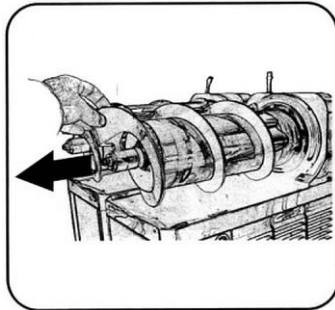

Fig. 21

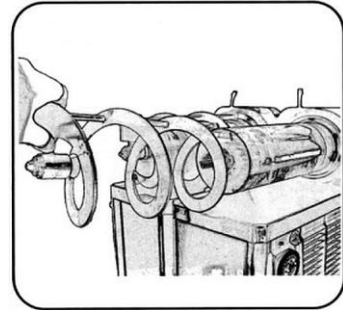

Fig. 22

1. To remove the coil, place your fingers on the coil plate and gently pull it inwards as shown in Fig. 21+22.

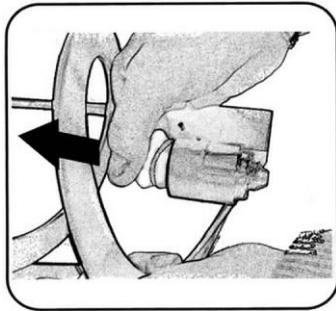

Fig. 23

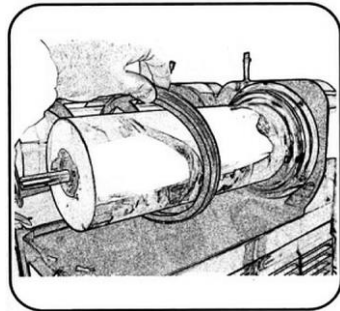

Fig. 24

2. With the scroll roll completely removed, remove the suction cap gasket from the front scroll.
3. Remove the tank gasket from the back of the evaporator tube.
4. Remove the drain tap components for cleaning as described below:

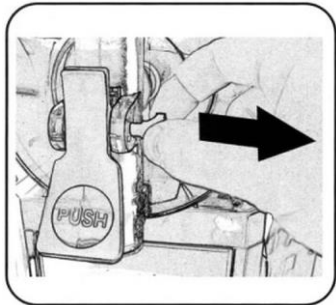

Fig. 25

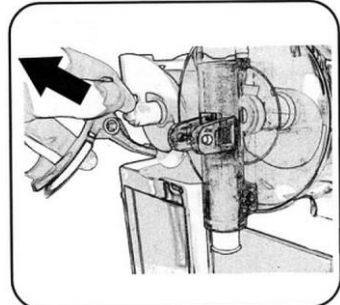

Fig. 26

- remove the handle mounting pin,
- remove the handle from its bracket,

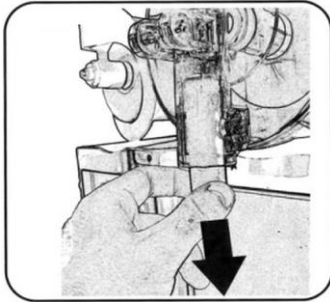

Fig. 27

- remove the main pin of the drain pin by pulling downwards,

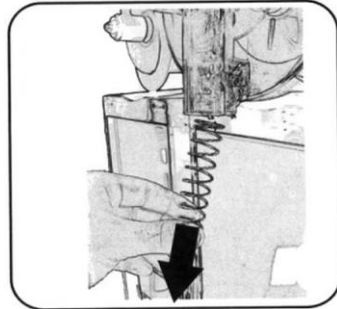

Fig. 28

- repeat the same process for the drain tap springs.

5. Wash all removed parts with warm water.

6. Use a suitable plastic dish washing brush to clean the following items:

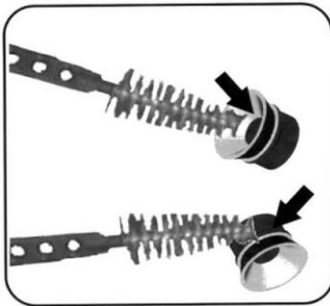

Fig. 29

- suction cap gasket

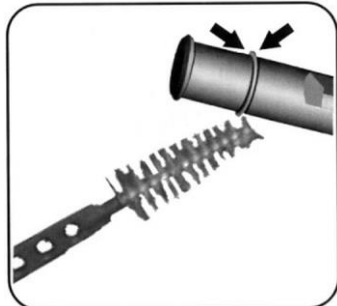

Fig. 30

- O-ring of the drain tap

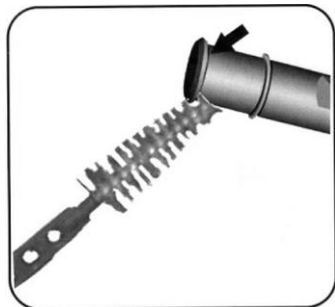

Fig. 31

- bottom gasket of the drain tap,



Fig. 32

- tank gasket.

Assembly after cleaning

1. Before assembly the components, clean the evaporator tube and drip hoses without using any scouring agents.
2. Flush the tank gasket with water before reinstalling the tank gasket to make tank reassembly easier.

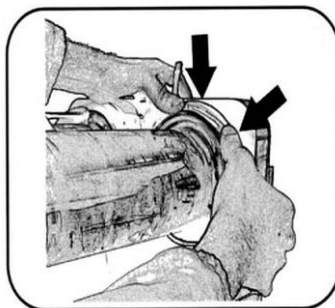

Fig. 33

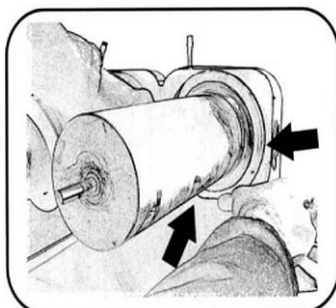

Fig. 34

3. Put the tank gasket in place on the back of the evaporator tube.
4. Once the tank gasket is in place, use your thumbs to press down on the bottom and then gradually down the top (make a circle with your fingers) until it is properly seated. (Fig. 33, 34)

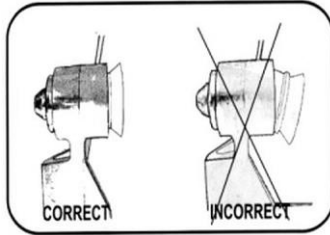

Fig. 35

5. Insert the suction cap into the space of the spiral, pressing it deeply (Fig. 35).
6. Wet the gasket with water.

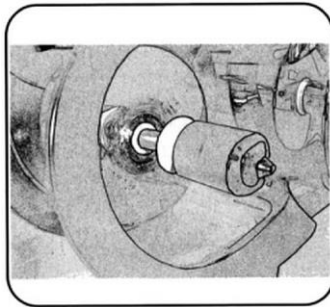

Fig. 36

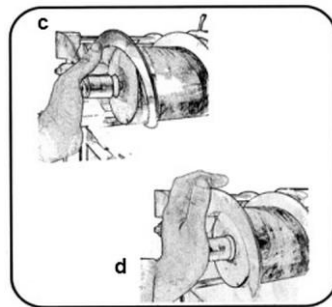

Fig. 37

7. Install the spiral by pressing gently and deeply, as shown in Fig. 36 (c and d).
8. Then moisten the spiral gaskets with water (Fig. 36)

Drain Tap Installation

1. Before assembling the components of the drain tap, wet the gaskets of the drain tap (Fig. 38) and the gaskets (Fig. 40) with water.

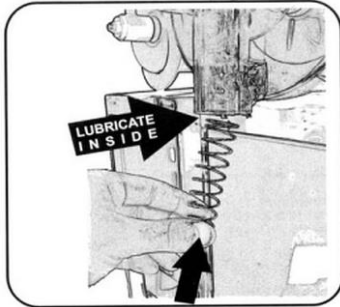

Fig. 38

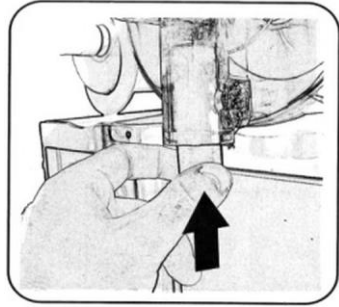

Fig. 39

2. Install the drain tap spring and pin as shown in Figures 38 and 39.

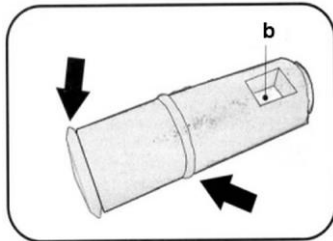

Fig. 40

3. When inserting the drain tap pin, make sure that the small hole (see Fig. 40) is directly in front of you.
4. Wet the pin of the drain cock with plenty of water before installing it.

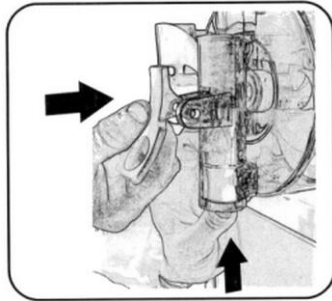

Fig. 41

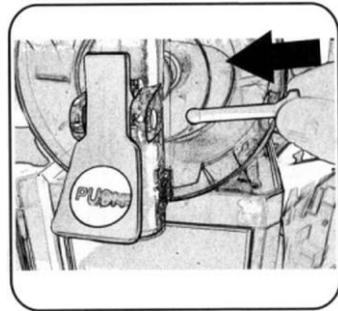

Fig. 42

5. Keep the pin of the drain tap pressed up until you can see the square hole into which the handle should be inserted (Fig. 41).
6. Insert the handle fixing pin as shown in Fig. 42.

Cleaning the drip trays

1. Remove the drain trays (11) from the device.
2. Remove the drain plates (10) from the drain trays.
3. Empty the drain tray.
4. Clean the drain trays and drain plates with warm water, a mild detergent and a soft cloth or sponge.
5. Rinse with clean water and dry the washed elements thoroughly.
6. Hang the drain trays in the mounting slots (14) provided for this purpose, while inserting the drain hoses (13) into the drain trays.



Fig. 43

Condenser cleaning

1. Remove the side pieces from the housing.
2. Clean the condenser weekly with a soft brush.

ATTENTION!

A dirty condenser can damage the compressor.

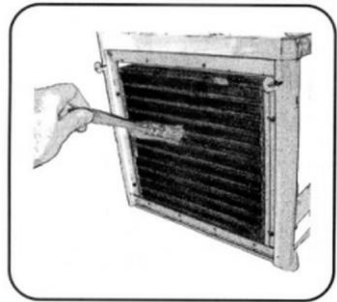

Fig. 44

7 Possible Malfunctions

The table below contains descriptions of possible causes and solutions to malfunctions or errors during operation of the appliance. When malfunction cannot be removed, contact the technical service.

In such a case, provide article number, model name and serial number. These data may be found in the rating plate.

Error	Possible Cause	Solution
No functions available	Plug improperly inserted into a socket	Remove the plug and insert it properly in the socket
	Electric power supply safety fuse damaged	Check the fuse, connect the appliance to another socket.
	No power supply	Check the electric power supply
	The main on/off switch is not turned on	Switch the appliance on with the main ON/OFF push-button.
	Damaged mains power plug	Contact the service company
The product does not freeze	Condenser obstructed with dust	Clean the condenser thoroughly
	Direct sunlight or heat sources in immediate vicinity	Move the appliance away from heat sources
	Poor air circulation around the appliance	Keep sufficient clearance from walls or other objects
The snail does not move or makes sounds	Incorrect sugar content	Note the minimum sugar content of 13%

8 Disposal

Electrical Appliance



Electric appliances are marked with this symbol. Electrical appliances must be disposed of and recycled in a correct and environmentally friendly manner. You must not dispose of electric appliances with household waste. Disconnect the appliance from the power supply and remove power cord from the appliance.

Electrical appliances should be returned to designated collection points.

Coolant

The propellant used in the appliance is flammable. It should be utilised pursuant to national regulations in force.