

Easy Slim 200



190095

Bartscher GmbH
Franz-Kleine-Str. 28
D-33154 Salzkotten
Germany

Phone: +49 5258 971-0

Fax: +49 5258 971-120

Technical Support Hotline: +49 5258 971-197

www.bartscher.com



Version: 1.0

Date of preparation: 2024-10-24

Original instruction manual

1	Safety	2
1.1	Explanation of Signal Words	2
1.2	Safety instructions.....	3
1.3	Intended Use	6
1.4	Unintended Use	6
2	General information	6
2.1	Liability and Warranty	6
2.2	Copyright Protection	7
2.3	Declaration of Conformity	7
3	Transport, Packaging and Storage	8
3.1	Delivery Check.....	8
3.2	Packaging	8
3.3	Storage	8
4	Technical Data.....	9
4.1	Technical Specifications	9
4.2	Functions of the Appliance.....	11
4.3	List of Components of the Appliance	12
5	Installation and operation	14
5.1	Installation.....	14
5.2	Operation	15
5.3	Settings.....	25
6	Cleaning and Maintenance	40
6.1	Safety Instructions for Cleaning	40
6.2	Cleaning.....	41
7	Possible Malfunctions.....	44
8	Disposal.....	48



Read these instruction manual before using the appliance and keep it available at all times!

This instruction manual contains information about installation, operation and maintenance of the appliance and constitutes an important source of information and reference guide. The knowledge of all operational and safety instructions included in this manual is a prerequisite for safe and proper handling of the appliance.

Read this instruction manual before you use the appliance and particularly before you start the appliance to prevent injury or damage. Incorrect use may cause damage.

All important information contained in the operating instructions must be available to the appropriate staff at all time. The operator shall be responsible for their availability.

In addition to the operating instructions, you must comply with the general, legal and other applicable regulations for occupational safety and environmental protection.

EN

1 Safety

This appliance has been manufactured in accordance with technical standards currently in force. However, the appliance may be a source of hazards if used improperly or contrary to its intended purpose. All persons using the appliance must consider information included in this instruction manual and observe safety instructions.

1.1 Explanation of Signal Words

Important safety instructions and warning information are indicated in this instruction manual with appropriate signal words. You must strictly follow the instructions, to prevent accidents, personal injuries and property damages.



DANGER!

The signal word **DANGER** warns against hazards that lead to severe injuries or death if the hazards are not avoided.



WARNING!

The signal word **WARNING** warns against hazards that may lead to moderate or severe injuries or death if the hazards are not avoided.



CAUTION!

The signal word **CAUTION** warns against hazards that may lead to light or moderate injuries if the hazards are not avoided.

IMPORTANT!

The signal word **IMPORTANT** indicates possible property damages, which may occur if safety instructions are not observed.

NOTE!

The symbol **NOTE** indicates subsequent information and guidelines for the user on usage of the appliance.

1.2 Safety instructions

Electrical Current

- Too high a mains voltage or incorrect installation may cause electric shock.
- The appliance may be connected only if data on the rating plate correspond with the mains voltage.
- To avoid short-circuit, the appliance should be kept dry.
- If there are malfunctions during operation, disconnect the appliance from the power supply.
- Do not touch the appliance's plug with wet hands.
- Never take hold of the appliance if it has fallen into water. Immediately disconnect the appliance from the power supply.
- Any repairs or housing opening may be carried out by professionals and relevant workshops only.
- Do not transport the appliance, holding it by the power cord.
- Do not allow the power cord to come into contact with heat sources or sharp edges.
- Do not bend, pinch nor knot the power cord.

- Always completely unwind the power cord.
- Never place the appliance or other objects on the power cord.
- Always take hold of the plug to disconnect the appliance from the power supply.
- Check the power cord regularly for damage. Do not use the appliance if the power cord is damaged. If this cable is damaged, it must be replaced by customer service or a qualified electrician in order to avoid dangers.

Flammable Materials

- Never subject the appliance to contact with high temperature sources, e.g.: oven, furnace, open flame, heat generating devices, etc.
- To avoid fire hazard, clean the appliance regularly.
- Do not cover the appliance with, e.g., aluminium foil or cloths.
- Use the appliance only with materials designated to this end and with correct temperature settings. Materials, groceries and left-overs remaining in the appliance may catch fire.
- Never use the appliance near flammable or inflammable materials, e.g.: petrol, spirit, alcohol, etc. High temperature triggers evaporation of these materials, and, as a result of contact with sources of ignition, an explosion may occur.
- In case of fire, disconnect the appliance from the power supply before attempting suitable fire-extinguishing actions.
- Never attempt to extinguish fire with water if the appliance is connected to the power supply. Following extinction of fire, ensure sufficient fresh air inflow.

Health hazard due to germs!

- The tank must be regularly emptied and disinfected to eliminate the possibility of accumulation of harmful and dangerous germs.

Operator's responsibility

The operator is responsible for complying with the currently applicable laws, regulations, ordinances and existing national regulations on accident prevention, environmental protection, as well as the internal operation, operating and safety instructions that apply at the respective installation site.

Obligations of the operator:

- Operate the appliance and its components only in a technical condition that does not raise any objections, with functional protective and safety elements.
- Prepare risk assessment at work positions.
- Provide instruction and regular staff training. Pay special attention to and observe the section concerning safety and any safety hints.
- Provide suitable personal protective equipment (PPE)
- Observe the intervals of maintenance and cleaning.
- Document training/instructions, replacement of components.

Supervised Usage only

- Only supervised appliance may be used.
- Always remain in an immediate vicinity of the appliance.

Operating Personnel

- The device can be used by children of 8 years old and older, as well as by people with reduced physical, sensory or mental abilities and those with limited experience/knowledge as long as they are under supervision or have been instructed on safe use of the device and possible risks. Children should not play with the device.
- Cleaning and user maintenance may not be performed by children.

Improper use

- Unintended or prohibited use may cause damage to the appliance.
- The appliance may only be used in a technically flawless condition, providing for safe use.
- The appliance may only be used with connections in a technically flawless condition, providing for safe use.
- The appliance may only be used clean.
- Use only original spare parts. Never attempt to repair the appliance on your own.

- Do not attempt to modify nor alter the appliance.

1.3 Intended Use

This appliance is only intended for use described in the operating instructions, with the supplied and approved components.

Any other use is considered against the intended purpose. The manufacturer shall not be liable for any damage due to unintended use. In such cases the responsible party shall only be the user/operator.

The following is an intended purpose:

- Preparation of various types of coffee beverages, for example: coffee, cappuccino, espresso, etc.

The appliance is not designed for continuous operation in industrial applications.

This appliance is intended for use in households and similar places, e.g.:

- in employee canteens in shops, offices, and similar areas;
- on farms;
- by customers in hotels, motels, and other typical accommodation establishments;
- in lodging-houses.

1.4 Unintended Use

An unintended use may lead to personal injuries or property damages caused by hazardous voltage, fire or high temperature. The appliance may only be used to perform tasks described in this instruction manual.

2 General information

2.1 Liability and Warranty

The appliance was built in accordance with the current state of the art and recognized technical safety principles. Nevertheless, during its use, there may be a threat to the health and life of the user or bystanders, or the danger of damage to the device or other assets. Warranty and liability claims for personal injury/property damage as well as defects at work are excluded if they can be attributed to one or more of the following causes:

- Use against the intended purpose
- Failure to follow/disregard the instructions and all related information

General information

- Unauthorized structural or technical changes to the device
- Engaging insufficiently trained and insufficiently qualified personnel
- Operation with defective or incorrectly installed safety and protective devices
- Inadequate maintenance or cleaning
- Faults not fixed
- Use of prohibited media, cleaning agents, etc.
- Use of unauthorised spare parts
- Errors in operation or other misuse
- Disasters caused by foreign objects or force majeure
- Destruction of the type plate and stickers relevant for operation and safety

The coffee machine contains parts that are subject to wear and tear. As a rule, with correct maintenance of the appliance, the following components that are subject to wear and tear sustain dispensing of the following amounts of beverages:

- Pump, discharge valve, grinder, gaskets: 10.000 dispensing instances
- Brew unit: 10.000 dispensing instances

Failures of these components that are subject to wear and tear after their reaching reference dispensing amounts are not considered to be coffee machine flaw.

2.2 Copyright Protection

This instruction manual, and texts, drawings and images included in it, as well as its other components are copyright protected. It is prohibited to reproduce this instruction manual (including its excerpts), in any form and by any means, and to use and/or transfer its content to third parties without manufacturer's written permission. Violation of the above results in obligation to pay compensation. We reserve the right to claim further damages.

2.3 Declaration of Conformity

The appliance meets the currently applicable standards and guidelines of the European Union. We confirm the above in the EC Declaration of Conformity. We may provide relevant Declaration of Conformity upon request.

3 Transport, Packaging and Storage

3.1 Delivery Check

Immediately upon reception, check the delivery for completeness and possible shipping damage. In the case of visible transport damage refuse to accept the appliance or accept it conditionally. Mark and note the scope of damage in shipping documents/consignment list of the shipping company and lodge a complaint. Concealed damage must be reported immediately upon its discovery, as compensation claims may only be filed within applicable time limits.

If you find that parts or accessories missing, please contact our Customer Service Department.

3.2 Packaging

Do not dispose of the appliance cardboard box. It may be used to store the appliance when relocating or when shipping the appliance to our service point in the case of any damages.

The packaging and its elements are made of recyclable materials. Particularly, these are: plastic films and bags, cardboard box.

When disposing of the packaging, observe applicable domestic regulations. Recyclable packaging materials should be recycled.

3.3 Storage

Leave the packaging closed until installation of the appliance; observe external indications concerning method of placing and storage. Store the packaging in the following conditions only:

- in closed rooms;
- in dry and dust-free surrounding;
- away from aggressive agents;
- in a location protected against sunlight;
- in a location protected against mechanical shocks.

In the case of extended storage (over three months), make sure you check the condition of the packaging and the parts regularly. If needed, replace the packaging with a new one.

4 Technical Data

4.1 Technical Specifications

Name:	Automatic coffee machine Easy Slim 200
Art. No.:	190095
Material:	plastic
Grinder material:	steel
Number of brewing unit groups:	1
Minimum brewing volume, in ml:	15
Designed for cups/day:	15
Water tank volume, in l:	1,3
Number of coffee bean containers:	1
Coffee bean container volume, in g:	200
Milk container volume, in ml:	250
Programs, pre-programmed, parameters can be changed:	15
Pump pressure, in bar:	19
Outlet, height regulation, from–to, in mm:	68 - 138
Dregs container volume, no. of cups, approx.:	10
Connected load:	1,4 kW 230 V 50 Hz
Dimensions (W x D x H), in mm:	215 x 455 x 345
Weight, in kg:	9,4

We reserve the right to implement technical modifications.

Version / Characteristics

- Version: automatic
- Control: touch
- Setting options:
 - coffee dosing
 - beverage names
 - 9 levels of grinding thickness
 - amount of milk
 - amount of water
- Milk container:
 - detachable
 - components of the milk container are dishwasher-safe
- Milk supply:
 - through the connected milk container
- Swivel milk outlet
- Detachable water tank
- Hot water function: yes
- Hot milk function: no
- Grinder: conical burr grinder
- Pressure system: piston pressure
- Milk frother: yes
- Cleaning program: yes
- Display:
 - error messages
 - key sounds
 - programs
 - status
 - Size: 2.4"
- Dregs container is dishwasher-safe
- Ground coffee option:
 - per cup
 - manually, 5–12 g
- 2 cup function: yes
- Cup counter: per program and total
- Features:

Technical Data

- high-power heater: 1 x 1,400 W
- water tank with handle
- The set includes:
 - 1 milk container with swivel outlet
 - 1 ground coffee spoon

Important hint:

- Starting with 5° d.H. (according to the German scale) of water hardness, the installation of a KV-150 water filter (Art. no. 109902) is strongly recommended.

4.2 Functions of the Appliance

Various coffee specialities such as coffee, espresso, cappuccino, latte macchiato etc. can be prepared in the coffee machine using coffee beans (or ground coffee) and cold water.

4.3 List of Components of the Appliance



Fig. 1

- | | |
|--|--|
| 1. Grinding coarseness adjustment knob | 2. Coffee container with cover |
| 3. Water tank | 4. Dregs container |
| 5. Drip grate | 6. Support for dregs container / front cover |
| 7. Drip tray | 8. Coffee outlet |
| 9. Milk container | 10. Housing |
| 11. Control panel | |

Technical Data

Control Panel

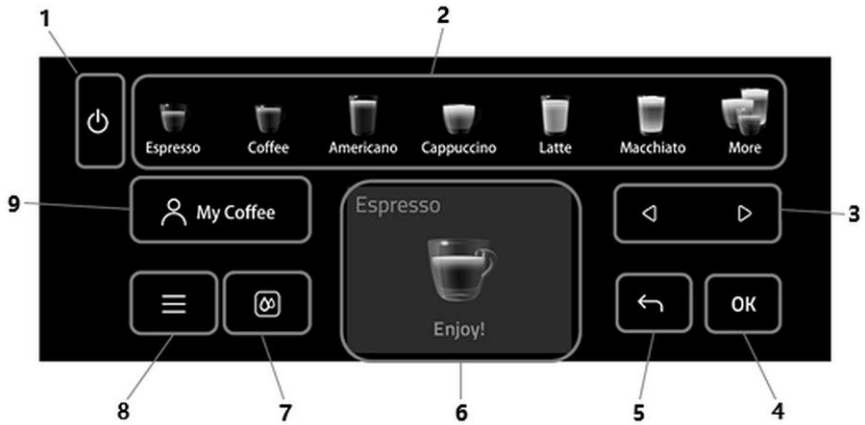

Fig. 2

- | | |
|-------------------------------|----------------------------|
| 1. ON/OFF switch | 2. Beverage selection keys |
| 3. Left/right arrow keys | 4. OK key |
| 5. Undo key | 6. Digital display |
| 7. Rinse key | 8. Menu settings key |
| 9. Key for individual recipes | |

5 Installation and operation

5.1 Installation

Unpacking / Positioning

- Unpack the appliance, remove all external and internal packaging elements and shipment safeguards.



CAUTION!

Choking hazard!

Prevent children from accessing packaging materials, for instance: plastic bags and EPS elements.

- If the appliance is covered with a protective film, remove it. Remove the film slowly, so no glue residues are left. Remove any glue residues with the use of a suitable solvent.
- Be careful not to damage the rating plate and warning labels affixed to the appliance.
- **Never** place the appliance in humid or wet environment.
- Place the appliance in a way making the connections easily accessible, so that they may be quickly disconnected if such a need arises.
- When selecting the installation site, please consider the following items:
 - The mounting surface must be even, sufficiently load-bearing, waterproof, dry and resistant to high temperatures.
 - Make sure that the designated escape routes are clear.
 - Ensure a stable position.
 - Allow sufficient space for work, maintenance and cleaning.
 - Leave the supply and exhaust air vents, if any, free.
 - Comply with applicable technical and building regulations.
- Maintain sufficient clearance from table edges. The appliance might turn over and fall down.

Installation and operation

- Mind the sufficient clearance from the walls and other flammable objects or objects that are prone to discolouration. This clearance must be at least 5 cm from the back and both sides, and 15 cm from the top. Note the fire safety provisions at the place of installation.
- When in operation, the appliance may not be installed in a cabinet.

Power supply connection

- Verify if technical data of the appliance (see rating plate) correspond with the local electric power grid specification.
- Connect the appliance to a single, properly grounded mains socket with protective contact. Do not connect the appliance to a multi-socket.
- The power cord should be laid in a way preventing anyone from threading on it or tripping against it.
- Do not use the appliance with an external timer or remote control.

5.2 Operation

Important indications

- Fill the water tank solely with fresh potable water.
- Never fill the water tank with warm/hot water, milk nor any other liquid.
- Never fill the coffee container (ground coffee container) any instant coffee, cocoa nor any other powder mixtures. The appliance might get damaged.
- Never fill the coffee container with specially prepared coffee beans (e.g. coated with cocoa or sugar), as this might cause damage to the appliance.
- The coffee container may be filled only with roasted coffee beans. Rice, soy beans, cocoa beans, nuts, sugar, spices, etc., are prohibited.
- Always store coffee beans in dry, shaded place. Humid beans may damage the grinder.
- Do not keep coffee beans in the coffee container if the appliance is not to be used for a longer period of time. Coffee beans may attract humidity and clog the grinder.

Appliance Preparation

1. Before first use, clean the appliance and all removable parts (water tank, milk container, dregs container, drip tray) as indicated in section 6 "**Cleaning**".



Fig. 3

2. Remove the water tank cover.
3. Fill the water tank with fresh, cold drinking water up to the MAX mark.
4. Install the water tank in the appliance on the right side. Pay attention to the correct position of the water tank.



Fig. 4

5. Fill the coffee bean container with properly roasted coffee beans.
6. Place the lid on the bean container.

ATTENTION!

Never fill the coffee bean container with ground coffee.

Do not pour any liquids into the coffee bean container.



Fig. 5



7. Place the dregs container in the drip tray.
8. Replace the drip grid.
9. Place the assembled components in the appliance.
10. Plug the appliance into a suitable single socket.

First Start-Up

1. Switch the appliance on with the ON/OFF key.

When the coffee machine is switched on for the first time, several settings need to be introduced.

Language Selection

1. Press  or  keys to select the desired language.
2. Confirm the selection with .

Water Hardness Setting



Once the language has been set, the digital display shows the question about the water hardness, which must be entered by the user.

NOTE!

If the hardness of water used is not known, it can be determined using test strips (optional).

1. The water hardness can also be set using the table below depending on the water source:

Degree of hardness	Water hardness
1	1~7dH
2	8~15dH
3	16~23dH
4	24~30dH

2. Use the  or  keys to select the desired degree of water hardness.
3. Press  key to confirm and proceed to the next step.

Automatic Rinsing

The coffee machine is rinsed automatically. After rinsing, the appliance is ready for use again.

CAUTION!

During the rinsing process, a small amount of hot water comes out through the coffee outlet.

Avoid contact with the outflowing hot water.

Fitting the Milk Container / Installation

1. The milk container must be fully assembled before it is placed in the appliance.
2. When assembling, follow the sequence (1–8) shown in the figure below.

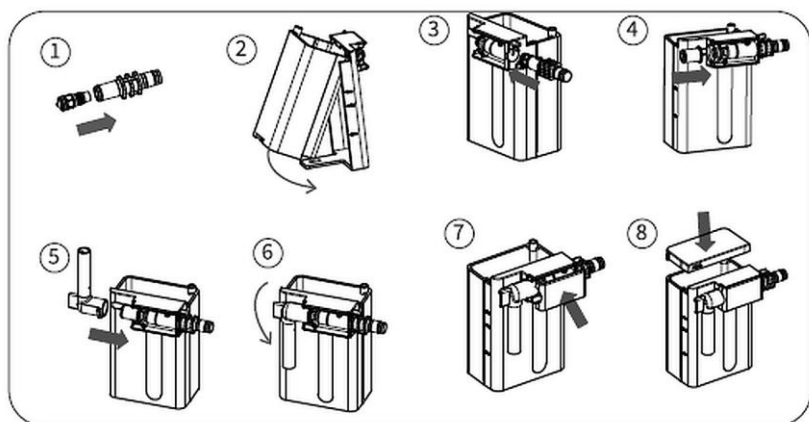

Fig. 6



Fig. 7

3. Open the milk container connection lid.
4. Fit the milk container in the front of the appliance, left-hand side.
5. If necessary, fill the milk container with milk (up to 250 ml).



Fig. 8

The milk container outlet is swivelling.

During beverage preparation, the milk is drawn from the milk container and fed into a cup.

If any milk remains in the milk container, it can be taken out of the appliance. When placed in a refrigerator, it can be used for subsequent use.

Once the milk container has been emptied, it can be removed and cleaned in a dishwasher.

Preparing Beverages

Before preparing a beverage, ensure that there is sufficient amount of water in the water tank, coffee beans in the coffee bean container and milk in the milk container. No error messages must appear on the digital display.



Fig. 9

EN

1. Place a suitable cup under the coffee outlet.
2. Adjust the coffee outlet according to the selected cup.
The adjustment range of the coffee outlet is 68–138 mm.

NOTE!

If the beverage contains a milk component, check that all parts of the milk container are correctly positioned and that there is milk in the container.

WARNING! Risk of scalding!

If there is insufficient milk in the milk container, hot steam will be pumped from the milk container.

Avoid contact with the milk container during beverage preparation.

Installation and operation

Selecting / Setting Beverage

1. Each beverage can be prepared by pressing the corresponding selection key on the control panel.
2. When the "More" icon is clicked, an extended selection of beverages opens:
Flat White / Ristretto / Americano Black / Double Espresso / Thermal Mug / Double Coffee / Hot Water / Frothed Milk
3. Once a beverage has been selected and its preparation activated, the beverage profile (short-term settings) can be edited.

The strength and volume of a beverage can be changed during the preparation process.

Example: Espresso

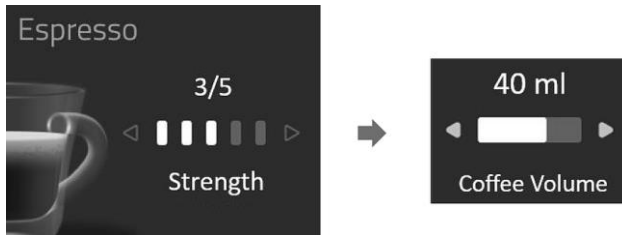







Fig. 10

EN

4. Use the  and  keys to select the beverage strength and set the volume.
5. Press  key to make the coffee a little weaker or press  key for a stronger coffee.
6. Press  key to reduce the quantity and the  key to increase the quantity.

Preparing Beverages with Milk

1. Touch one of the icons for milk beverages.

Example: Cappuccino



During the preparation of milk beverages, the digital display shows a message informing about preheating.

2. Wait until the heating process is complete.

Fig. 11

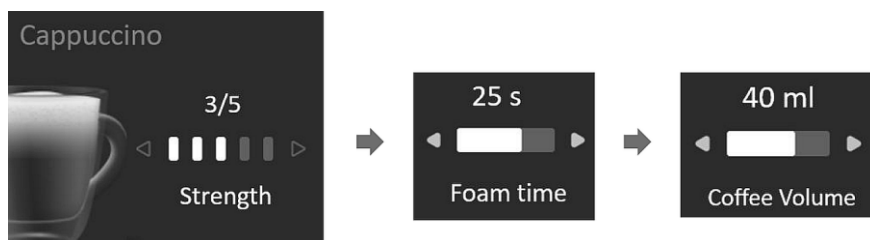

Fig. 12

3. Parameters can be set/changed during preparation.
4. Use the ◀ and ▶ keys to select the strength of the beverage, to set the quantity and time of milk frothing.

Grinding Coarseness Setting

1. The coarseness of the ground coffee must be adapted to the selected coffee beans.

NOTE:

The grinding coarseness setting is only available for coffee prepared with the use of coffee beans.

2. Remove the lid from the coffee bean container.

The grinding coarseness adjustment knob is located on the left side.

Use the adjustment knob to set the selected grinding coarseness from "very fine" (1) to "very coarse" (9).

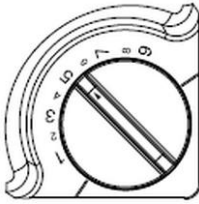

Fig. 13

3. If during preparation the coffee flows very slowly or does not flow out completely, set the grinding coarseness to 4 or 5.
4. If the ground coffee is dark, we recommend the highest coarseness grinding setting.
5. If the ground coffee is light, we recommend the finest grinding setting.

The changes to the grinding coarseness will only be noticeable after 2 or more fresh cups of coffee are brewed.

Preparing Beverages with Ground Coffee Function

The coffee machine is equipped with a function that makes it possible to prepare coffee with the use of ground coffee.



ATTENTION!

To prepare coffee using the ground coffee function, the amount of ground coffee used must be between 5–12 g.

In addition, the coffee must be coarsely ground to avoid blocking the brewing group.

EN



1. Press **More** selection key and use the  or  keys to select "Use ground coffee".
2. Press **OK** key to proceed to the next step.

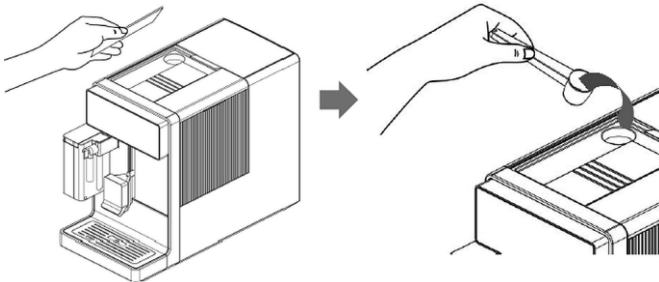



Fig. 14

3. Remove the lid from the ground coffee hopper.
4. Pour the amount of ground coffee specified above into the ground coffee hopper.

5. Confirm with the **OK** key.
 6. Use the selection keys to select the beverage to be prepared.
- The subsequent steps are the same as for preparing a beverage with coffee beans.

Preparing Beverages with "My Coffee" Function

1. Press  **My Coffee** key to enter the "My Coffee" mode for individual coffee beverage settings.

This mode has 4 free slots for saving 4 recipes for your favourite beverages.



Fig. 15

2. After selecting the storage slot (e.g., "My Coffee 1"), use the control panel to select the desired beverage.
3. During preparation, adjust the selected beverage (amount, coffee strength, frothing time, milk content).

When the beverage is ready, its settings are stored in the selected "My Coffee 1" slot.

4. As required, enter the settings for subsequent beverages in "My Coffee" mode, following the instructions above.
5. The next time a previously saved beverage is selected (through the same "My Coffee" mode), the beverage will be prepared according to the last saved recipe.

Irrespective of the settings made when preparing beverages using the "My Coffee" mode slot, the machine automatically restores the original beverage setting (beverage recipe programmed in the "Beverages" menu) when the preparation is completed.

5.3 Settings

Program Settings Menu Overview

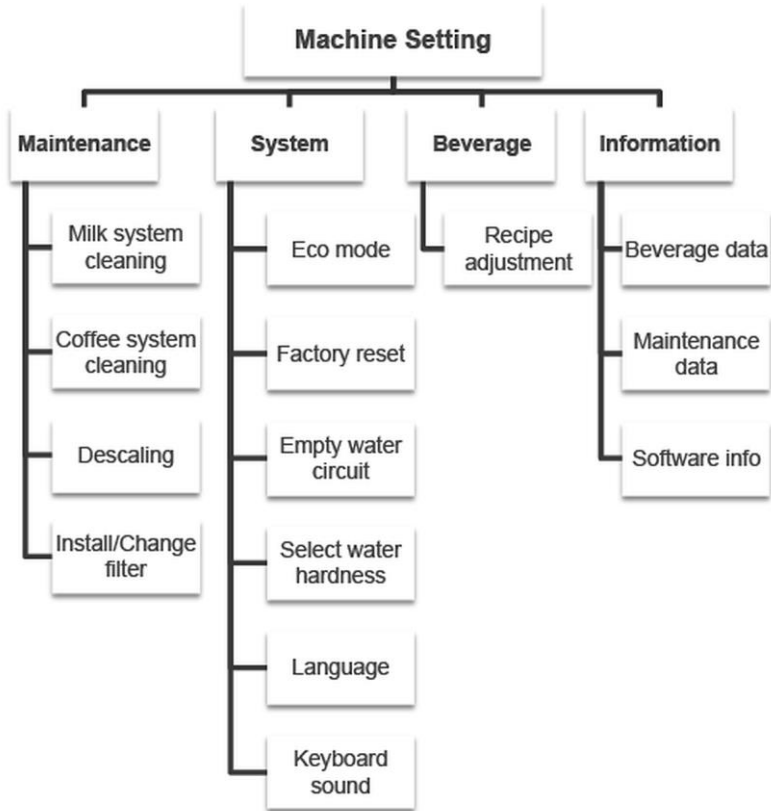





Fig. 16

1. Press  key to access the menu with program settings.
2. Select a program using the  or  keys.
3. Confirm by pressing **OK**.
4. Press  key to return to the main menu or to abort the setting.

Maintenance Menu

Milk System Cleaning

If the milk function is used to prepare beverages with milk, the milk system must be checked and cleaned daily to ensure proper operation. This process is necessary to clean the milk system of milk fat.

The cleaning time is approximately 3 minutes.

Rinsing takes place at the temperature of 58°C.

Approximately 430 ml of water is required for rinsing.

Observe the manufacturer's instructions on the cleaning agent packaging.

1. Remove the milk container from the appliance.
2. Empty the milk container and rinse it.
3. Prepare the cleaning agent solution in advance.
4. Fill the milk container with the prepared solution.
5. Place the milk container in the appliance.

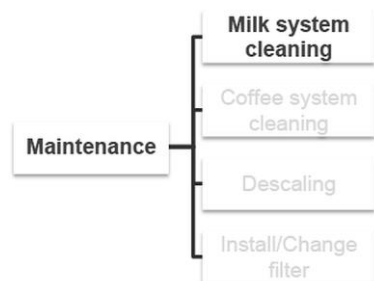

6. Select the "Milk system cleaning" function in the maintenance menu.

7. Press **OK** to start the cleaning process for the milk system.

The system heats up.

The status bar of the maintenance program lights up.

Fig. 17

8. At the end of the cleaning step 1, remove the milk container with the cleaning solution and rinse it thoroughly.
9. Fill the container with clean, fresh water.
10. Place the milk container back in the appliance to continue cleaning the milk system.
11. Cleaning of the milk system is complete when "Ready" is displayed.

The coffee machine automatically switches to beverage preparation mode.

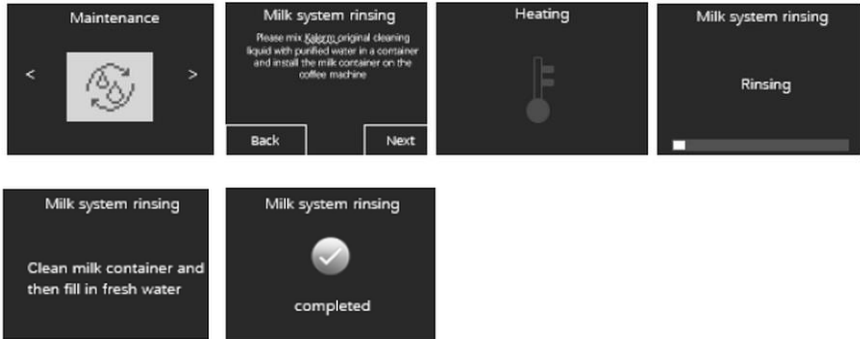

Fig. 18

12. Clean the milk container observing indications in section "**Daily Cleaning**".

Coffee System Cleaning

When the coffee machine is running, coffee oily substances are deposited on the brewing unit and inside coffee hoses.

Therefore, over time, the user is prompted to clean the coffee system. When this message appears, we recommend performing coffee system cleaning as soon as possible.

The brewing unit should be cleaned every 230 cups prepared.

The coffee system should be cleaned with a suitable coffee system cleaning agent. Observe the manufacturer's instructions on the cleaning agent packaging.

The cleaning time is approximately 20 minutes.

550 ml of water is required for cleaning.

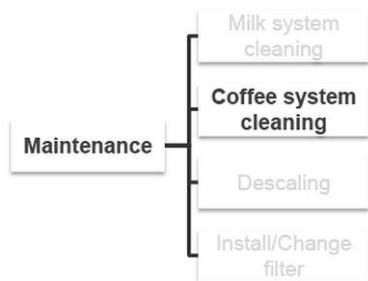

13. Select the "Coffee system cleaning" function in the maintenance menu.

14. Press **OK** to start the cleaning process for the coffee system.

Instructions for subsequent procedure will appear on the digital display.

Fig. 19

1. Empty the drip tray and dregs container according to messages shown on the digital display.
2. Re-insert the drip tray and dregs container into the machine.
3. When a message appears on the digital display, place a cleaning tablet in the ground coffee compartment.
4. Press **OK** to start the cleaning process for the coffee system.
5. Follow the instructions shown on the digital display during the cleaning process.
6. Cleaning of the coffee system is complete when "**Ready**" is displayed.

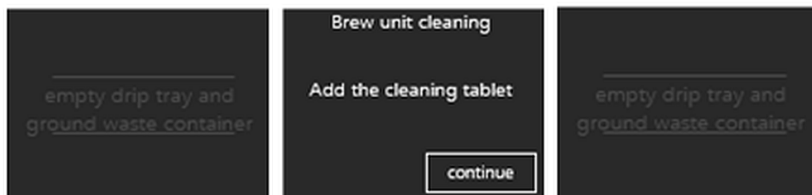

Fig. 20

Descaling

In the course of daily use of the appliance, depending on the local water hardness, limescale may build up inside the appliance components. In order to maintain the appliance in the best possible condition, and to be certain that every brewing process yields the best results, the appliance should be descaled regularly.

The descaling schedule depends on the water hardness setting.

The entire descaling process lasts approx. 30 minutes.

900 ml of cleaning solution is required for descaling.

The water temperature during descaling is 40°C.

CAUTION!

Descaling agents contain acids which can cause irritation when in contact with skin or eyes.

If, accidentally, the descaling agent comes into contact with eyes or skin, rinse them immediately with fresh water.

It is therefore essential to observe the warning notices and instructions on the manufacturer's packaging.

1. For cleaning and descaling, use only suitable cleaning and descaling agents intended for coffee machines.
2. Always execute the descaling process in full; interrupting it may cause damage to the appliance.
3. Dissolve the descaling agent in warm water before cleaning.
4. Empty the water tank.
5. Remove the filter first, if it is installed.
6. Fill the water tank with the prepared solution.
7. Cleaning will be more effective if you wait until the cleaning agent has completely dissolved.
8. Empty the drip tray and dregs container and place them back in the appliance.
9. Reinstall the water tank with the descaling solution in the appliance.

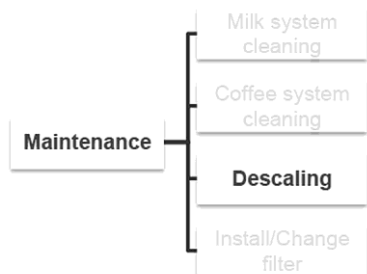

10. Select the "Descaling" program in the maintenance menu.

11. Press **OK** to start the descaling process.

Fig. 21

Instructions for subsequent procedure will appear on the digital display.

The status of the descaling process is also displayed.

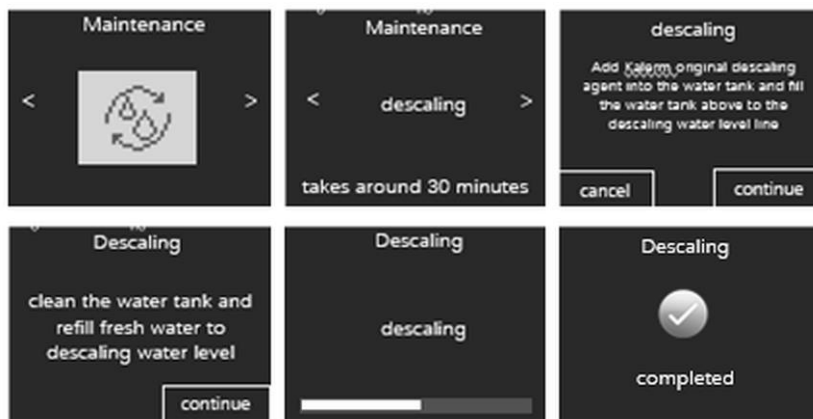

Fig. 22

12. Continue following the instructions shown on the digital display.

The descaling process is complete when **"Ready"** is displayed.

13. After descaling, clean the water tank, drip tray and dregs container thoroughly, observing instructions in section **"Daily cleaning"**.

Installation and operation

Installing Filter (Optional)

A water filter effectively purifies water and reduces the hardness of water.

We recommend the KV-150 water filter, Art. No.: 190902

1. Fill the water tank with clean, fresh drinking water.

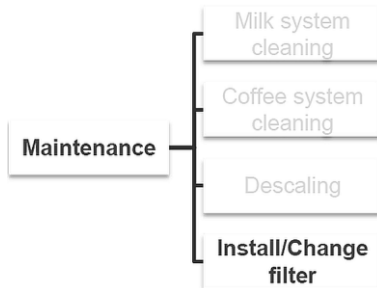

2. Select the "Install/Change filter" option in the maintenance menu.

3. Press **OK** to start the filter installation.

4. Insert the water filter into the water tank. Instructions for subsequent procedure will appear on the digital display.

Fig. 23

The filter flushing status is also displayed. Do not interrupt this process.

The filter flushing is automatically completed.

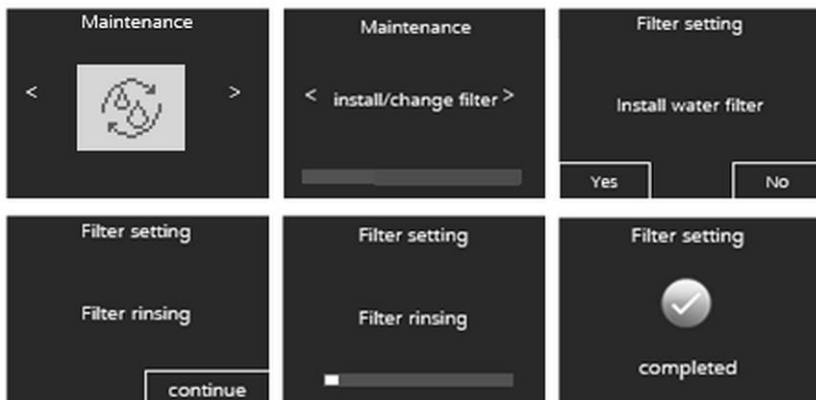

Fig. 24

5. Continue following the instructions shown on the digital display.

The installation is complete when the message **"Ready"** is shown on the digital display.

Filter Change

NOTE!

After 2 months of use, the water filter loses its properties and must be replaced.



The unit does not display any message when the filter needs to be changed.

1. Select the "Install/Change filter" option in the maintenance menu.
2. Press **OK** to start the filter change.
3. Press **OK** to confirm the message "Replace filter?" shown on the digital display to continue changing the filter.
4. Remove the used water filter from the water tank when prompted.
5. Press **OK** to continue filter replacement.
6. When prompted, place a new water filter in the water tank.
7. Press **OK** to start flushing the filter.

Filter flushing is in progress. A small amount of water will flow into the drip tray. The filter flushing is automatically completed.

EN

Deactivating Filter

1. Select the "Install/Change filter" option in the maintenance menu.
 2. Press **OK** to enter the setting.
 3. With the message "Replace filter?" shown in the digital display, press  to deactivate the water filter.
 4. Press "Back/Cancel" key to deactivate the filter.
 5. With the message "Deactivate filter?" press **OK** to confirm the selection.
 6. To exit the programming menu, press  twice.
- "Ready" message appears on the digital display.

System Menu

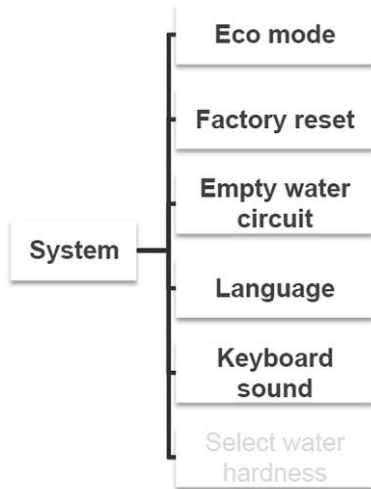









1. Press  key to access the menu with program settings.
2. Use  or  keys to select System menu
3. Press  to enter/confirm.
4. Press  key to return to the main menu or to abort the setting.

Fig. 25

Automatic Switch-Off

1. Program the time at which the appliance should automatically switch off.
2. The coffee machine can be set to switch automatically off at intervals of 15 minutes, 30 minutes and between 1–8 hours.

In the range of 1–8 hours, the time can be set in 1-hour intervals using  or  keys.



3. Press  to enter/confirm.

By default, the unit is set to switch automatically off after 30 minutes.

ECO Mode (Energy Saving Mode)

In this program, you can select whether to continue heating after the beverage has been prepared:

- when the energy saving mode is set to "ECO ON", the coffee machine needs approx. 30 seconds to heat up the system before preparing a beverage;
- when the setting is "ECO OFF", the coffee machine prepares the selected beverage without preheating.

1. Use  or  keys to select the desired setting ("ECO ON" or "ECO OFF").
2. To confirm your selection, press .

By default, the appliance is set to "ECO OFF" (no energy saving mode).

Factory Settings Reset

You can use this function to restore factory settings. In doing so, the previously entered menu and beverage settings will be deleted.

The information settings (number of beverages prepared and number of maintenance programs carried out) will not be reset.

1. Press  to confirm the reset to factory settings.

The following message appears on the digital display: "**Secured**".

The appliance will switch automatically off.

The next time the appliance is started up, the following settings must be introduced again as at the first start-up:

- language;
- degree of hardness of the water used;
- installation of water filter (yes or no).

EN

Emptying Water Circuit



The water circuit must be emptied if the appliance is to be transported or not used for a long time.

1. Make sure that the water tank and tray are emptied of water and coffee dregs before transporting.

WARNING! Risk of scalding!

When emptying the coffee machine, hot steam escapes from the coffee outlet.

Avoid contact with the coffee outlet.

2. To empty the water circuit, proceed as follows:
3. Select the "Empty water circuit" setting in the system menu.
4. Press  to start the water system emptying process.
5. Remove the water tank and empty it.
6. Press  to continue the water system emptying process.

The water system emptying process is in progress and the status bar on the digital display shows the progress of the process.



Installation and operation

The appliance switches off when the water system has been emptied.



7. Remove the drip tray with the dregs container.
8. Clean them observing instructions in section "Daily Cleaning".
9. Thoroughly dry all cleaned elements.
10. Reinstall the drip tray and dregs container in the appliance.

The appliance can now be transported or stored.

Language



1. Select the "Language" setting in the system menu.
2. Use  or  keys to select the language.
3. Press  to confirm the setting.

Key Sound



1. In the system menu, select the "Keyboard sound" setting.
2. Use  or  keys to select whether the key sound is to be switched on or off.
3. Press  to confirm the selected setting.

EN

Water Hardness

1. In the system menu, select the "Select water hardness" setting.
2. Select the desired degree of hardness using  or  keys.
3. Follow instructions in section "**First Start-Up**".
4. Press  to confirm the selected degree of hardness.

Beverage Menu

In the "Beverage settings" menu, you can use  or  keys to change/adjust the beverage recipe (strength, amount of coffee, amount of water, frothing time, waiting time, coffee temperature).

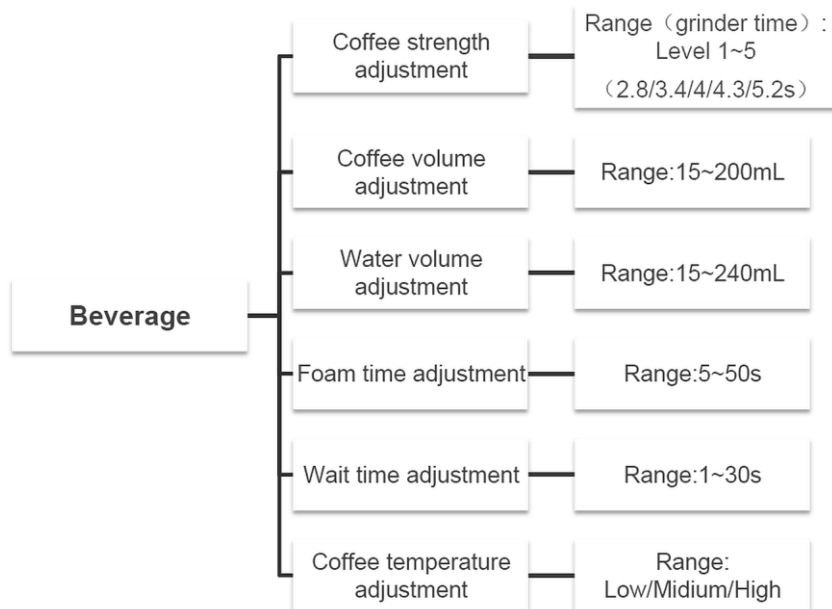







Fig. 26

1. Press  key to enter the settings interface.
2. Use  or  keys to select "Beverage" menu.
3. Press  to enter/confirm.
4. Select the desired options for a given beverage recipe.
5. Press  to enter/confirm the values entered.
6. Press  key to return to the main menu or to abort the setting.

Installation and operation

The following table shows options for beverage settings.

Beverage	Recipe	Temperature setting	Coffee strength
Ristretto	Coffee amount: 15–200 ml	Low / Medium / High	5 levels can be set
Espresso	Coffee amount: 15–200 ml	Low / Medium / High	5 levels can be set
Coffee	Coffee amount: 15–200 ml	Low / Medium / High	5 levels can be set
Lungo	Coffee amount: 15–200 ml	Low / Medium / High	5 levels can be set
Double Espresso	Coffee amount: 15–200 ml	Low / Medium / High	5 levels can be set
Double coffee	Coffee amount: 15–200 ml	Low / Medium / High	5 levels can be set
Americano	Coffee amount: 15–200 ml Hot water volume: 15–240 ml	Low / Medium / High	5 levels can be set
Americano Black	Coffee amount: 15–200 ml Hot water volume: 15–240 ml	Low / Medium / High	5 levels can be set
Latte	Milk frothing time: 5–50 sec. Coffee amount: 15–200 ml	Low / Medium / High	5 levels can be set
Cappuccino	Milk frothing time: 5–50 sec. Coffee amount: 15–200 ml	Low / Medium / High	5 levels can be set
Flat White	Milk frothing time: 5–50 sec. Coffee amount: 15–200 ml	Low / Medium / High	5 levels can be set

Beverage	Recipe	Temperature Setting	Coffee strength
Macchiato	Milk frothing time: 5–50 sec. Coffee amount: 15–200 ml Waiting time: 30 sec.	Low / Medium / High	5 levels can be set
Mug to-go	2 brewing processes Volume of coffee: 15–200 ml per brewing process	Low / Medium / High	5 levels can be set
Hot water	Hot water volume: 15–240 ml	Low / Medium / High	-
Froth	Milk frothing time: 5–50 sec.	-	-

Information Menu

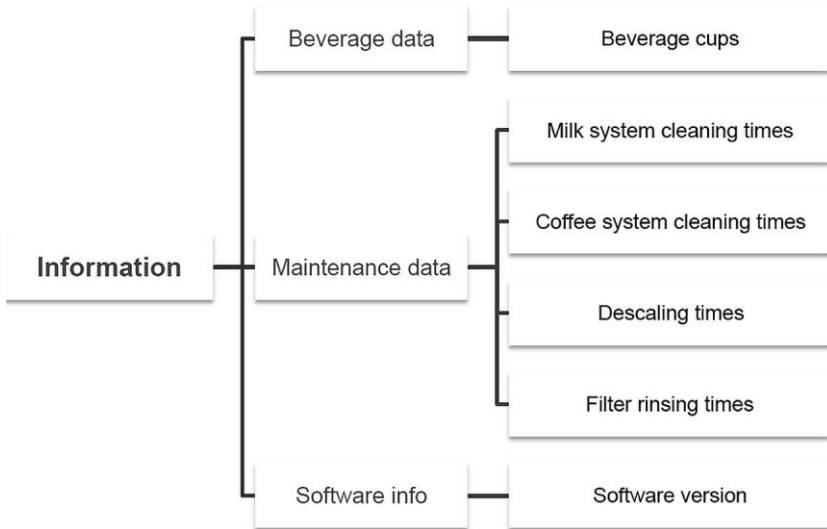





Fig. 27

1. Press  key to access the menu with program settings.
2. Use  or  keys to select "Information" menu.

You can view the following information:

- number of beverages prepared
- performed milk system cleaning processes
- performed coffee system cleaning processes
- performed descaling processes
- performed water filter rinsing processes
- software version.

6 Cleaning and Maintenance

The operator must ensure that the device and its safety components are kept in good condition. Control and safety systems should be checked for their effectiveness.

Maintenance, cleaning and repairs must only be carried out by suitably trained and specialised personnel.

If the safety devices need to be removed for maintenance, cleaning and repair, they should be reinstalled immediately after completion and their function should be checked.

All maintenance and cleaning work must be carried out in accordance with the operating instructions at the specified intervals.

6.1 Safety Instructions for Cleaning

- Before cleaning, disconnect the appliance from the power supply.
- Leave the appliance to cool down completely.
- Make sure water does not enter the appliance. Do not immerse the appliance in water or other liquids during cleaning. Do not clean the appliance with a pressurized water jet.
- Do not use any sharp or pointed, nor metal implements (knife, fork, etc.). Sharp or pointed implements may damage the appliance, and when in contact with live parts, they may cause electric shock.
- For cleaning, do not use any scouring agents that contain solvents nor corrosive cleaning agents. They may damage the surface.

6.2 Cleaning

Daily Cleaning

To ensure high quality coffee beverages and to maintain the functionality of the appliance, the following should be carried out daily:

- emptying and cleaning the dregs container;
- emptying and cleaning the drip tray;
- cleaning the drip grid;
- cleaning the water tank;
- rinsing the coffee outlet;
- cleaning the milk container and its components;
- cleaning the control panel.

Coffee Outlet Cleaning

Important!

The milk container must be removed from the machine.

1. Press  key to start rinsing the coffee outlet.

The system is heated and rinsed.

CAUTION!

Hot water flows from the coffee outlet during rinsing.

Be very careful and avoid contact with the coffee outlet to avoid scalding.

Milk System Cleaning

After the milk container is inserted and the beverage is prepared on the base, the milk system is rinsed.

Milk Container Cleaning / Manual Removal

1. Carefully separate the milk container from the coffee machine and disassemble it as shown in the figures below.

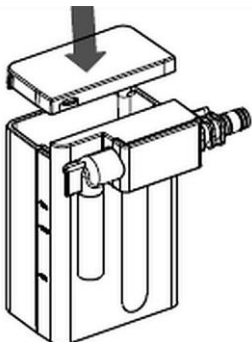

2. Remove the protective cover from the milk container.

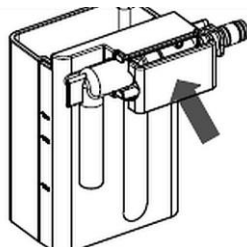

3. Pull the cover of the milk system internal components towards you to remove it.

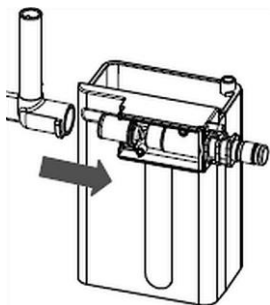

4. Turn the milk outlet upwards and pull it off.

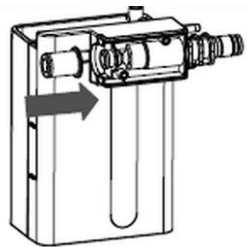

5. Remove the rubber seal.

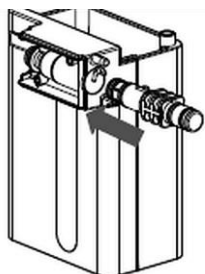

6. Remove the milk container connection spigot from the milk container.

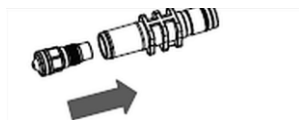

7. Unscrew the nozzle from the milk container connection.

Cleaning and Maintenance

8. Rinse all components thoroughly under warm running water with the use of a mild cleaning agent.
9. Rinse the cleaned elements in fresh water and dry.
10. Reassemble the milk container. Observe the sequence shown in Fig. 6.
11. Reassemble the milk container into the machine if necessary.

Subsequent Cleaning Steps

1. Pull out the drip tray with dregs container and drip grid.
2. Empty the drip tray and dregs container.
3. Clean the drip tray, dregs container, support and also the drip grid under warm running water with mild cleaning agent, using a sponge or soft cloth.
4. Rinse cleaned elements in fresh water.
5. Dry all parts thoroughly.
6. Wash the water tank with warm water and a mild cleaning agent.
7. Rinse with fresh water and use a lint-free cloth to dry the water tank.
8. Refit the removed elements back in the appliance.
9. Wipe the housing and control panel with a soft, damp cloth.
10. Dry all cleaned surfaces thoroughly.
11. Wipe the power cord and plug only with a slightly damp cloth.

7 Possible Malfunctions

The table below contains descriptions of possible causes and solutions to malfunctions or errors during operation of the appliance. The works may only be performed by suitably qualified technical personnel.

When malfunction cannot be removed, contact the technical service. In such a case, provide article number, model and serial number. You will find this information on the rating plate.

Malfunction	Cause	Solution
Milk gushes out of the milk container when preparing frothed milk	Milk leaks	Fill the milk container with milk
	The milk system is clogged	Clean the milk system
	The milk container is not correctly installed	Place the milk container correctly
Coffee temperature is low	The set temperature is too low	Increase the temperature in the beverage setting
	Clogging inside the appliance due to limescale build-up	Perform descaling process

Possible Malfunctions







Malfunction	Cause	Solution
The dregs container cannot be removed together with the drip tray Drip tray and dregs container cannot be reinserted into the machine	The brewing group inside the machine interferes with the dregs container	First remove the dregs container by hand, then place only the drip tray back in the appliance until the coffee is prepared again Remove the drip tray, then place the drip tray together with the dregs container in the machine
Coffee does not dispense or flows slowly	Ground coffee is too fine	Increase grinding coarseness
	Clogging in the coffee system	Clean the coffee system
	Clogging in the coffee outlet	Clean the coffee outlet
	Clogging inside the appliance due to limescale build-up	Perform descaling process
"System empty" message on the digital display	No water flowing in the dispenser	Touch OK ; the system pumps the water automatically
"Brewing error" message is displayed	This happens when preparing beverages with the ground coffee function: The system recognises more than 12 g of ground coffee	Touch OK ; and add less ground coffee for next cup
	Faults in the internal components of the machine	Touch OK to switch the appliance off directly. If the error still occurs after restarting, contact the service department

Malfunction	Cause	Solution
"NTC error" message	Defective internal components	Touch OK to switch the appliance off directly. If the error still occurs after restarting, contact the service department
"Multi-way valve error" message		
"Thermoblock error" message		
"Pump or flow meter error" message		
"Grinding error" message		
"High temperature in thermoblock or low temperature in thermoblock" message		

Messages on the digital display

Messages	Possible causes and solutions
Fill the water tank	Water tank is empty. The beverage function is not available. Fill the tank with fresh potable water.
Fill with coffee beans	The coffee bean container is empty. The beverage function is not available. Fill the coffee bean container with suitable coffee beans.
Empty the dregs container	The dregs container is full. The beverage function is not available. Empty the dregs container and reinstall in the appliance.
Fit drip tray and dregs container.	The beverage function is not available. Reinstall the drip tray and dregs container.
Reinstall the milk container	Reinstall the milk container and continue preparing beverages.
Empty the drip tray	This message appears during the descaling process. Empty the drip tray and reinstall it in the appliance.
Empty the drip tray and dregs container	This message appears when the coffee system is being cleaned. Empty the drip tray and dregs container.

Possible Malfunctions

Rinse the milk container	Touch  key to rinse the milk container.
Rinse the milk container	This message appears while the milk system is being cleaned. Rinse the milk container thoroughly with the cleaning solution, fill with fresh water. Reinstall the milk container in the machine. Continue cleaning the milk system.
Rinse the brewing unit	Touch  key to start rinsing.
Clean the brewing unit	The brewing unit needs to be cleaned. Touch  key to start cleaning the brewing unit from oily substances.
Descaling required	Carry out the descaling process. Touch  key to start the descaling process.
Replace the water filter	Install a new water filter in the water tank. Touch  key to activate the water filter.
Note on cleaning the coffee system	Clean the coffee system. Touch  key to clean the coffee system.
Note on cleaning the milk system	Clean the milk system. Touch  key to clean the milk system.
Rinsing	This message appears when the coffee machine is switched off and the rinsing process starts automatically.

8 Disposal

Electrical Appliance



Electric appliances are marked with this symbol. Electrical appliances must be disposed of and recycled in a correct and environmentally friendly manner. You must not dispose of electric appliances with household waste. Disconnect the appliance from the power supply and remove power cord from the appliance.

Electrical appliances should be returned to designated collection points.