



150151

ENGLISH
Translation
of the original instruction manual

Table of contents

1. Safety 18
1.1 Safety instructions 18
1.2 Key to symbols 19
1.3 Hazard sources 20
1.4 Proper use 22

2. General information 23
2.1 Liability and Warrantees 23
2.2 Copyright protection 23
2.3 Declaration of conformity 23

3. Transport, packaging and storage 24
3.1 Delivery check 24
3.2 Packaging 24
3.3 Storage 24

4. Technical data 25
4.1 Overview of parts 25
4.2 Technical specification 26

5. Installation and operation 27
5.1 Installation 27
5.2 Operation 28

6. Cleaning 30

7. Possible Malfunctions 31

8. Waste disposal 32

Bartscher GmbH
Franz-Kleine-Str. 28
D-33154 Salzkotten
Germany

phone: +49 (0) 5258 971-0
fax: +49 (0) 5258 971-120



Read this instruction manual before using and keep them available at all times!

This instruction manual contains information about the installation, operation and maintenance of the device and should be consulted as an important source of information and reference guide.

Awareness of the safety instructions and instructions for use in this manual will ensure the safe and correct use of the device.

In addition to the information given here, you should comply with any local Health and safety Controls and generally applicable safety regulations.

The instruction manual forms part of the product and should be kept near the device and easily accessible for anyone carrying out the installation, servicing, maintenance or cleaning.

1. Safety

This device is designed in accordance with the presently applicable technological standards. However, the device can pose a danger if handled improperly and inappropriately.

All persons using the device must follow the recommendations and instructions in this instruction manual.

1.1 Safety instructions

- Please keep these instructions and give them to future owners of the device.
- Do not use the device in case it does not function properly, has been damaged or dropped.
- The unit is not intended for use by individuals (including children) with physical or mental disabilities, insufficient experience, and/or insufficient knowledge unless such persons are under the care of a person responsible for their safety or have received instructions regarding appropriate use of the unit.
- Children should be observed to ensure that they are not playing with the unit.
- Only a qualified technician and using original spare parts and accessories should carry out repairs and maintenance of the device. **Do not attempt to repair the device yourself.**
- Do not use any accessory or spare parts that have not been recommended by the manufacturer. These can be dangerous for the user or lead to damages of the device or personal injury, and further, the warranty expires.

- To prevent hazards and to ensure optimum efficiency, no modifications or alterations to the device that are not explicitly approved by the manufacturer may be undertaken.
- Never allow the power cable to come into contact with heat sources or sharp edges. The power cable should not hang over the side of the working surface. Ensure that no one can step on or trip over the cable.
- The power cable must not be folded, bent or tangled, and must always remain fully unrolled.
- Never place the device or other objects on the power cable.
- Do not lay the cable over carpets or heat insulations. Do not cover the cable. Keep away the cable from operating range and do not dunk it into water.
- Inspect the power cable regularly for damage. Never use the device if the cable is damaged. If the power cable is damaged, have an authorised service center or qualified electrician replace it.
- The device is not adapted for use with an external timer or remote control.
- **Never** leave the device unattended when in use.
- Do not move or tilt the device when in operation.
- Only use the device indoors.

1.2 Key to symbols

In this manual, symbols are used to highlight important safety instructions and any advice relating to the device. The instructions should be followed very carefully to avoid any risk of accident, personal injury or material damage.



WARNING!

This symbol highlights hazards which could lead to injury.

- To avoid them please follow the instructions very carefully and proceed with particular attention in these cases.



WARNING!

This symbol highlights dangerous situations which could lead to injury or death.

- To avoid them please follow the instructions very carefully and proceed with particular attention in these cases.



CAUTION!

This symbol highlights dangerous situations which could lead to light injuries, or damage, malfunction, and/or destruction of the device.

- To avoid them please follow the instructions very carefully and proceed with particular attention in these cases.



NOTE!

This symbol highlights recommendations and information aimed for effective and trouble-free device operation.

1.3 Hazard sources



DANGER!

Electric shock hazard!

To avoid the hazard results please follow the safety instructions below.

- Do not use the device in case of incorrect operation, damages or dropping on the floor. When the cable is damaged it should be replaced by the service company or qualified electrician in order to avoid the hazards.
- The supply cable must be disconnected from the socket only by pulling the plug.
- Never carry or lift the device by the supply cable.
- In any case do not open the device housing. In case of electrical or mechanical modifications the electric shock hazard will occur.
- Never immerse the plug in water or other liquids.
- Do not use any acid agents and make sure no water ingresses the device.
- Never operate the device with moist hands or standing on wet floor.
- Remove the plug from its socket:
 - when the device is not used,
 - in case of anomalies during operation,
 - before cleaning.



DANGER!

Suffocation hazard!

- Prevent access of children to the package materials like plastic bags and foamed polystyrene elements.



WARNING!

Injury hazard!

To avoid the hazard results please follow the safety instructions below.

- **Never** place your hands, spoons, or other kitchen utensils in the blending tumbler during the device operation. They may be caught by the knives leading to lacerations, fractures, or other injuries.
- The device must be always activated after closing the lid.
- The knife in the tumbler is very sharp, so it is required to maintain caution during emptying, washing, or inspecting the knife.
- When there are hot ingredients in the blending tumbler, it should be grabbed by the handle, using the protective gloves when required.



CAUTION!

In order to avoid any damages of the device follow the instructions below.

- In order to avoid the damages of the motor block, blending tumbler, and the knife system do not move or shake the device during its operation.
- When the device is supposed to stop the operation before 1 minute, deactivate it with use of **ON/OFF** button, remove the tumbler from the motor block, release the protective clamps, and remove the lid. Use the rubber spatula to carefully move the tumbler content towards the knife. Refit the tumbler to the motor block, close the lid, and restart the blending process.
- **Never** wash the device or its elements in the dishwasher.
- Inspect the blending tumbler and knife every day. Never use the damaged or cracked tumbler.
- Inspect knife for wear and damages of the cutting blades. Never use the damaged knife. In case of damages contact the vendor and replace the tumbler with the knife system.

1.4 Proper use

The operational safety of the device is assured only in case of proper use, according to the operation manual.

All technical activities like installation and maintenance must be performed by the qualified service personnel only.

The multi-blender is designed only for blending, preparing shakes, puree, or drinks.



CAUTION!

Any use going beyond the intended purpose and/or any different use of the device is forbidden and is not considered as conventional.

Any claims against the manufacturer or his authorized representative as a consequence of experiencing damages resulting from unconventional use are impossible.

The operator is liable for all damages resulting from inappropriate use.

2. General information

2.1 Liability and Warrantees

All the information and instructions in this manual take into account standard safety regulations, current levels of technical engineering as well as the expertise and experience we have developed over the years.

The instruction manual was translated with all due care and attention. However, we do not accept liability for any translation errors. The German version of this instruction manual is definitive.

If the delivery consists of a special model, the actual scope of delivery may differ from the descriptions and illustrations in this manual. This is also the case for special orders or when the device has been modified in line with new technology.



CAUTION!

Read this manual carefully and thoroughly before any operation of the device, and especially before turning it on!

Manufacturer **is not liable** for any damages or faults caused by:

- violation of advice concerning operation and cleaning;
- use other than designed;
- alterations made by user;
- use of inadequate spare parts.

We reserve the right to make technical changes for purposes of developing and improving the useful properties.

2.2 Copyright protection

The instruction manual including any texts, drawings, images or other illustrations is copyright. No part of this publication may be reproduced, transmitted or used in any form or by any means without permission in writing from the manufacturer. Any person who commits any unauthorized act in relation to this publication shall be liable to claims for damages. All rights reserved.



NOTE!

The contents, texts, drawings, pictures and any other illustrations are copyright and subject to other protection rights. Any person unlawfully using this publication is liable to criminal prosecution.

2.3 Declaration of conformity



The device complies with the current standards and directives of the EU. We certify this in the EC declaration of conformity. If required we will be glad to send you the according declaration of conformity.

3. Transport, packaging and storage

3.1 Delivery check

Please check the delivery upon completeness and transport damage immediately after receipt. In case of visible damage do not accept or accept the delivery with reservation only.

Note the extent of damage on the carrier's bill of delivery. Trigger off the complaint.

Hidden damages should be reclaimed immediately after notice, as claims for damages can only be asserted within the effective period for complaints.

3.2 Packaging

Please do not throw away the covering carton of your device as it might be useful for storage purposes, when moving or, in case of damages, when the device must be sent back to a repair center. The outer and inner packing material should be removed completely from the device before installation.



NOTE!

If you liked to dispose the packing, consider the regulations applicable in your country. Supply re-usable packing materials to the recycling.

Please inspect the device upon completeness. In case any part is missing please contact our customer service center immediately.

3.3 Storage

Keep the package closed until installation and under consideration of the outside indicated positioning- and storage markings.

Packages should be stored under consideration of the following:

- Do not store outdoors.
- Keep it dry and dust-free.
- Do not expose it to aggressive media.
- Do not expose it to direct sunlight.
- Avoid mechanical shocks and vibration.
- In case of longer storage (> 3 months) make sure you check the state of the packaging and the parts regularly.
If required refresh or renew.

4. Technical data

4.1 Overview of parts



- | | |
|---------------------------------|-------------------------|
| ① Blending tumbler | ⑦ Transmission coupling |
| ② Lid | ⑧ Sensor |
| ③ Blending tumbler handle | ⑨ Control panel |
| ④ Protective clamps | ⑩ Motor block |
| ⑤ Spout with transparent plug | ⑪ Rubber feet |
| ⑥ Knife (installed permanently) | |

Control panel / functions of buttons



ON/OFF button

for starting and stopping the device



Speed levels:

1 – low speed

2 – medium speed

3 – high speed



PULSE button

used when the ingredients are supposed to be blended shortly:

1 second – operation, 1 second – pause

4.2 Technical specification

Name	Multi-blender
Code-no.:	150151
Material:	housing: stainless steel, plastic; blending tumbler: plastic, nickel-chrome steel 18/10
Speed levels:	3 + pulse function
Power supply:	1000 W / 220-240 V 50 Hz
Blending tumbler:	volume: 3200 ml, filling capacity: max. 2150 ml
Dimensions:	W 215 x D 215 x H 460 mm
Weight:	3.05 kg

We reserve the right to make technical changes!

Protective devices

Protective function

That function is designed for assuring that the device may be activated **only after correct placing of the tumbler** on the motor block (contact with the sensor) and after **closing both lid clamps**.

Overload/overheating protection

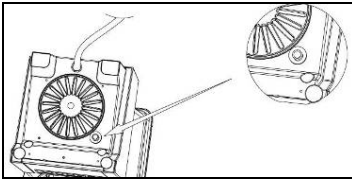

That protection is activated automatically in case of motor overheating due too long operation or overloading. Wait for the device to cool down and press **RESET** button in the bottom (drawing on the left). Then the blender may be used again.

5. Installation and operation

5.1 Installation

Positioning

- Unpack the device and remove all packing material.



CAUTION!

- **Never** remove the rating plate and any warning signs from the device.
- Place the device on top of an even, stable, and water-resistant surface which supports the weight of the device and is not heat sensitive. Moreover the surface should be smooth and dry so the front suction cups may be properly attached.
- **Never** place the device on the table edge to avoid tilting or drop.
- The operating surface must be easily accessible and large enough. In order to assure comfortable operation and proper air circulation leave at least 15 cm of space on the sides and back and 50 cm on the front and top from the walls, cabinets, etc.
- **Never** place the device in humid or wet environment.
- **Never** place the device on the flammable surfaces.
- **Never** place the device in the vicinity of open fire, electric ovens, heating furnaces, or other heat sources.

Connection



DANGER! Electric shock hazard!

The device can cause injuries due to improper installation!

Before installation and connecting the local power grid specification should be compared with that of the device (see rating plate). Connect the device only in case of compliance!

Connect the device only to properly installed single socket with protective terminal.

Do not disconnect the supply cable by pulling it, always pull the plug.

- The electrical circuit in the socket must be secured to at least 16A. Only connect the device directly to the wall socket; do not use any extension cords or power strips.
- Place the device so that the plug is easily accessible and can be quickly removed from its socket in case of necessity.

5.2 Operation

- Before the device operation clean it according to the instructions in section 6 “Cleaning”.
- Place the motor block on the even and stable surface.
- Put the blending tumbler on the motor block and rotate it clockwise to fix it (see below). There are the following fixing possibilities:

for right hand

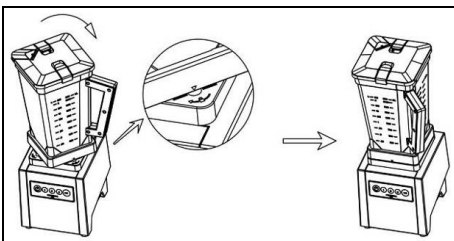

for left hand

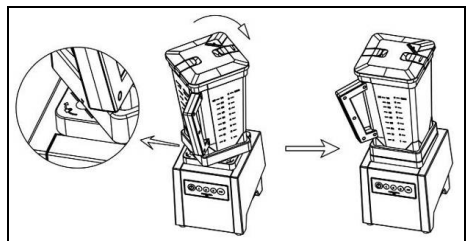

NOTE!

Keep in mind that after fixing the blending tumbler its handle must be positioned in the front on the right or left side, as it is the only way to assure contact with the sensor.

- Prepare the food products for blending and put the in the tumbler.
- **The maximum operating capacity** of the tumbler is **2150 ml**.
- Do not overfill the tumbler, the filling level may be determined according to the marks on the tumbler. During processing of hot or foaming roducts and during work at high speed fill the blending tumbler only up to 2/3 of the maximum operating capacity of 2150 ml.



CAUTION!

Do not process the liquids or food products of temperature above 80°C in the blending tumbler. Injury hazard!

- Put the lid on the tumbler and fix it with two protective clamps.
- Before start close the spout with the transparent plug.



- Connect the device to the single grounded socket.
- Start the device with use of **ON/OFF** switch.
- Use appropriate button to select one of the speed levels (1, 2 or 3). Level 3 is the highest one. The buttons descriptions are illuminated in blue colour and the selected button flashes during the operation.
- The **continuous work time** for levels 1 – 3 is **1 minute**. The device processes the ingredients very quickly. After that time the device turns off automatically. Check the consistence of processed ingredients and after the cooling phase start the device again when required.
- Observe the device during work and allow it to cool down after each blending process.
- When the ingredients are supposed to be blended shortly, use the **PULSE** function with the appropriate button. That function is especially useful for ice disintegration. When it is used the device operates for 1 second and stops for 1 second alternately. While using that function the device is not turned off automatically and should be stopped with use of **ON/OFF** button when the ingredients are sufficiently processed.
- The ingredients may be added through the spout during the operation when required. To do this open the transparent plug which should be closed before starting the blender again.

- Do not process too much of hard or frozen products in one batch. For better results process them in smaller amount.
- When the knife is blocked and the motor operates irregularly stop the device at once, pull the plug from the socket, and remove some ingredients from the blending tumbler. Then continue the blending process.



WARNING! Injury hazard!

Never place your hands or any objects in the blending tumbler during the device operation!

Never use any auxiliary means for pressing the ingredients during the device operation. They may be caught by the knife and cause the operator's injuries or the damages!

- When the required consistence of the ingredients is obtained stop the device (press the **ON/OFF** button) and disconnect the blending tumbler from the motor block by rotating it counterclockwise. Empty the tumbler through the spout.
- After use disconnect the device from the socket (pull the plug!).

6. Cleaning



CAUTION!

Disconnect the unit from the power supply (unplug!) before cleaning.

The unit is not designed to be rinsed with running water.

Do not use a pressure washer to clean the device!

Be careful and do not let the water into the unit.

- Clean the device thoroughly after each use.
- Disconnect the tumbler from the motor block by rotating it counterclockwise. Release the lid clamps and remove the lid. Empty the blending tumbler.
- Wash the lid and tumbler in the running water with the gentle washing agent and plastic brush. Maintain special caution during washing the tumbler: the knife installed in the bottom is very sharp. There is the **injury hazard!**
- Then rinse the washed parts in clean water and leave them for drying or dry the thoroughly with the cloth; then they may be reinstalled in the device.



CAUTION!

Never immerse the motor block in water or other liquids, do not wash it in the running water or dishwasher.

- Wipe the motor block and the supply cable with soft, moistened cloth. Protect the device from the water penetration. Dry the device thoroughly with soft, dry cloth.
- Always use the soft cloth only, **never** use any abrasive cleaning agents which may damage the device surfaces.
- In case of longer inactivity period clean the device according to the description above and store in dry and clean place, protected from frost, sunlight, and out of reach of children.
- Do not place any heavy objects on the device.

7. Possible Malfunctions

In case of anomalies use the table below before calling the service company or informing the vendor.

Problem	Cause	Solution
The device is connected to the power supply but the ON/OFF button lamp is not working	<ul style="list-style-type: none"> • Plug improperly inserted into socket. • The ON/OFF button is not pressed. • The overload / overheating protection was triggered. 	<ul style="list-style-type: none"> • Remove the plug and insert it properly into the socket. • Press the ON/OFF button • Press RESET button located in the device bottom. (See fig. in page 27)
The ON/OFF button lamp illuminates, the speed level is selected but the device is not working.	<ul style="list-style-type: none"> • The device worked for too long and turned off automatically. 	<ul style="list-style-type: none"> • Remove the plug and leave the device for cooling down before reactivation. If the protection is triggered again contact the vendor.

When the anomalies cannot be removed:

- disconnect the device from the socket (pull the plug!)
- **do not** open the housing
- contact the vendor.

8. Waste disposal

Discarding old devices

At the end of its service life the discarded device has to be disposed in accordance with the national regulations. It is advisable to contact a company which is specialized in waste disposal, or just contact the local disposal service in your community.



WARNING!

To exclude any abuse and the dangers involved make the waste device unfit for use before disposal. For that purpose disconnect device from mains supply and remove mains connection cable from the device.



CAUTION!



For the disposal of the device please consider and act according to the national and local rules and regulations.