

- EN** Operating Instructions
- DE** Gebrauchsanleitung
- FR** Mode d'emploi
- NL** Gebruiksaanwijzing
- IT** Istruzioni per l'uso
- ES** Manual de instrucciones
- PT** Instruções de funcionamento
- PL** Instrukcja obsługi
- DK** Brugervejledning
- CN** 使用说明
- JP** 操作ガイド
- KR** 작동 지침

 **BRITA**



## AquaAroma Crema

- EN** Water Filter Cartridge for Coffee and Espresso Machines
- DE** Wasserfilterkartusche für Kaffee- und Espressomaschinen
- FR** Cartouche filtrante pour machines à café et expresso
- NL** Filterpatroon voor koffiemachines en espressoapparaten
- IT** Cartuccia filtrante per macchine da caffè
- ES** Cartucho de filtro de agua para cafeteras y cafeteras exprés
- PT** Cartucho filtrante de água para máquinas de café e máquinas de café expresso
- PL** Wkład filtrujący do przepływowych i ciśnieniowych ekspresów do kawy
- DK** Vandfilterpatron til kaffe- og espressomaskiner
- CN** 用于咖啡机和浓缩咖啡机的过滤滤芯
- JP** コーヒー及びエスプレッソマシンのためのフィルターカートリッジ
- KR** 커피 및 카페 엑스프레스 머신용 정수 카트리지

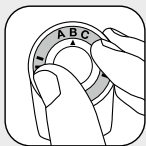

**A**

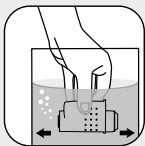

**B**

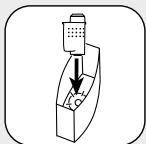

**C**

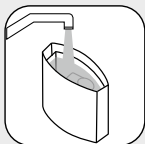

**D**

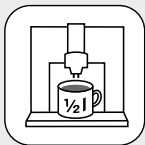

**E**

**Date field**

Day	Month	Year
-----	-------	------

**F**

**Aroma stage**

**G**



This AquaAroma Crema cartridge is Tested and Certified by NSF International against NSF/ANSI Standard 42 for material requirements only.



## 1 General Information on the Functioning

The BRITA AquaAroma Crema Water Filter Cartridge reduces the limescale content in drinking water, in order to protect espresso machines and coffee machines against scale build up. Calcium, magnesium and metal ions are selectively removed from the drinking water using the flow method.

The filter material not only reduces cloudiness and organic pollutants, but also the level of substances that impair the smell and taste, such as chlorine residues in the filtrate and in the bypass water. This dramatically improves the taste of the coffee.

The filter capacity of the AquaAroma Crema is adjusted to the local carbonate hardness with the Aroma Ring. This means that the aroma and crema of the coffee are optimised.

## 2 Commissioning and Changing the Interchangeable Filter Cartridge

### 2.1 Setting the Aroma Ring

The Aroma Ring on the bottom of the AquaAroma Crema adjusts the filter performance perfectly to the water conditions at the location where the coffee machine is installed in accordance with the following table.

Aroma Ring setting	Colour scale	Application	Hardness level
A	red to yellow	for soft water	up to 8.5 °dH
B	yellow to yellowish green	for medium hard water	8.5 – 13.5 °dH
C	dark green	for hard water	from 13.5 °dH

**Note:** The factory setting for the Aroma Ring is level "B". The water hardness can be determined by using a test strip or by asking the local water provider. The specified colour scale can be used to determine the best setting for the Aroma Ring.

- Dip the reaction field of the test strip in a glass of tap water for 1 second.
- After 1 minute compare the colour of the reaction field with the colour scale and read off the Aroma Ring setting.
- Make a note of the correct Aroma Ring setting in the aroma stage field (G), so that you can set the same setting the next time you change the filter

### 2.2 Commissioning the Water Filter Cartridge

**A** Turn the Aroma Ring on the bottom of the AquaAroma Crema to the left or right and set the arrow to the required stage. (see Chapter 2.1).

**B** Press the water filter cartridge under cold water and wet it by moving it backwards and forwards until all of the air bubbles have escaped.

**C** Remove the water tank from the coffee machine and insert the water filter cartridge vertically on the cartridge seat in or on the water tank. Make sure that the water filter cartridge audibly engages. **Note:** Only a completely engaged cartridge provides the full filter capacity.

**D** Fill the tank with cold drinking water and replace it in the coffee machine.

**E** The AquaAroma Crema Water Filter Cartridge must be flushed with water before the first coffee or espresso is made. If the coffee machine does not display or implement this automatically, rinse the water filter cartridge with half a litre of tap water. **Note:** Please consult the coffee machine Operating Instructions.

**F** If the coffee machine does not have an electronic filter change display, note the date of commissioning (if changing the filter: date of change) in the date field.

### 2.3 Changing the Water Filter Cartridge

A necessary AquaAroma Crema filter exchange is usually displayed in the electronic filter change display on the coffee machine. **Note:** If the coffee machine does not have an electronic filter change display, the AquaAroma Crema Water Filter Cartridge must be changed according to the capacity table below or after 6 months at the latest. BRITA furthermore recommends a regular cleaning of the water tank.

#### Capacity table

Aroma Ring setting	Capacity in litres	No. of cups at 35ml	No. of cups at 150ml
A	220	6,300	1,470
B	150	4,300	1,000
C	80	2,300	540

When changing the AquaAroma Crema Water Filter Cartridge, repeat the steps in Chapter 2.2.

### 3 Operating and Safety Information

- Store replacement filter cartridges in a cool and dry place in their original, sealed packaging.
- Only cold water of drinking water quality may be used as intake water for the AquaAroma Crema Water Filter Cartridge. No microbiologically impaired water or water of unknown microbiological quality may be used without appropriate sterilisation.
- When choosing the material for parts that come into contact with water after the BRITA filter system, it is important to remember that, due to the process, decarbonised water contains free carbon dioxide. For this reason, only materials that are compatible with free carbon dioxide must be used.
- If there are official instructions to boil tap water, BRITA filtered water must also be boiled. After the end of the requirement to boil water, the entire appliance must be cleaned and the water filter cartridge changed.
- Clean the water tank regularly.
- It is generally recommended to boil tap water for certain groups of people (e.g. people with weakened immune systems, babies). This also applies to filtered water.
- Note for people with kidney disease or dialysis patients: during the filter process, the potassium content may be increased slightly. If you suffer from kidney disease and/or have to stick to a special potassium diet, we recommend prior agreement with your doctor.
- As water is a foodstuff, the water in the tank must be used up within 1 to 2 days. The water in the tank must be changed after a maximum of 2 days.
- If the coffee machine is not in use for a longer period, we recommend that the water filter cartridge be left in the water tank and the unfiltered water be poured out. Before using the coffee machine again, remove the water filter cartridge from the water tank, clean it and repeat the stages in Chapter 2.2.
- These Operating Instructions must be understood as part of the product and stored with the coffee machine or espresso machine operating instructions.
- The BRITA AquaAroma Crema Water Filter Cartridge must be commissioned and changed in accordance with these Operating Instructions. BRITA shall not be liable for any damage, including subsequent damage, resulting from the incorrect use of the product.

**BRITA SE**  
Heinz-Hankammer-Strasse 1  
65232 Taunusstein  
Germany  
Tel. +49 6128 746-5765  
professional@brita.net  
www.brita.net

**BRITA Wasser-  
Filter-Systeme AG**  
Gassmatt 6  
6025 Neudorf / LU  
Switzerland  
Tel. +41 41 932-4230  
info-ppd@brita.net  
www.brita.ch

**BRITA Water  
Filter Systems Ltd.**  
BRITA House|9 Granville Way  
Bicester|Oxfordshire OX26 4JT  
United Kingdom  
Tel. +44 844 742-4990  
UK001\_clientservices@brita.net  
www.brita.co.uk

**BRITA France SARL**  
52 Boulevard de l'Yerres  
91030 ÉVRY cedex  
France  
Tél. +33 1 69 11 36 40  
infopro@brita.net  
www.brita.fr

**BRITA Benelux B.V.**  
High Tech Campus 5  
5656 AE Eindhoven  
Netherlands  
Tel. +31 40 281 39 59  
sales.professional@brita.net  
www.brita.nl

**BRITA Belux B.V.**  
De Keyserlei 58  
2018 Antwerpen  
Belgium  
Tel. +31 40 281 39 59  
sales.professional@brita.net  
www.brita.be

**BRITA Italia S.r.l.**  
Via Zanica, 19K  
24050 Grassobbio (BG)  
Italy  
Tel. +39 35 1996-4639  
Fax +39 35 1996-2256  
professionalitalia@brita.net  
www.brita.it



**BRITA Iberia, S.L.U.**  
C / Valencia 307 2<sup>a</sup>-4<sup>a</sup>  
08009 Barcelona  
Spain  
Tel. +34 93 342 75 70  
Fax +34 93 342 75 71  
csbrita@brita.net  
www.brita.es

**BRITA Polska Sp. z o.o.**  
Ołtarzew, ul. Domaniewska 6  
05 - 850 Ożarów Mazowiecki  
Poland  
Tel. +48 22 721-2420  
Fax +48 22 721-2449  
bok@brita.net  
www.brita.pl

**生产企业名称:**  
碧然德欧洲股份公司(BRITA SE)  
**生产企业地址:**  
Heinz-Hankammer-Strasse 1,  
65232 Taunusstein, Germany  
**在华责任单位名称:**  
碧然德净水系统(上海)有限公司  
**在华责任单位地址:**  
中国(上海)自由贸易试验区世纪  
大道1196号世纪汇二座8层01-02  
& 05-08单元  
**邮编:** 200122  
**电话:** 021- 68980333  
professionalfilterinquiry@brita.cn  
www.brita.cn

**Manufacturer:** BRITA SE  
**Address:**  
Heinz-Hankammer-Strasse 1,  
65232 Taunusstein, Germany  
**Responsible Unit in China:**  
BRITA China Co., Ltd.  
**Address:** Suite 01-02 & 05-08,  
8th Floor, Tower Two, Century Link,  
1196 Century Avenue, China  
(Shanghai), Pilot Free Trade Zone.  
**Postcode:** 200122  
**Telephone:** 021- 68980333  
professionalfilterinquiry@brita.cn  
www.brita.cn