

E500 LPR



110510

Abb. 1 - ALLGEMEINE ABMESSUNGEN UND ZULEITUNGEN (mm)

Fig. 1 – GENERAL DIMENSIONS AND POWER CORDS (mm)

Des. 1 - DIMENSIONS GÉNÉRALES ET CÂBLES D'ALIMENTATION

Fig. 1 – DIMENSIONI GENERALI E CONDOTTE DI ALIMENTAZIONE (mm)

Dib. 1 - DIMENSIONES GENERALES Y CABLES DE ALIMENTACIÓN (mm)

Des. 1 – DIMENSÕES GERAIS E CABOS DE ALIMENTAÇÃO (mm)

Afb. 1 – ALGEMENE AFMETINGEN EN TOEVOERCIRCUITS (mm)

Fig. 1 – GENERELLE DIMENSIONER OG STRØMKABLER

Рис. 1 - ОБЩИЕ РАЗМЕРЫ И ПОДСОЕДИНЕНИЯ (мм)

Resim 1 - GENEL EBATLAR VE ELEKTRİK TESİSATI (mm)

Rys. 1 - OGÓLNE WYMIARY I PRZEWODY ZASILAJĄCE (mm)

Obr 1 - OBECNÉ ROZMĚRY A NAPÁJECÍ KABELY (mm)

Crtež. 1 – OPĆENITE DMENZIJE I NAPOJNI VODOVI (mm)

1. ábr. ÁLTALÁNOS MÉRETEK ÉS HÁLÓZATI KÁBELEK (mm)

Εικ. 1 - ΓΕΝΙΚΕΣ ΔΙΑΣΤΑΣΕΙΣ ΚΑΙ ΚΑΛΩΔΙΑ ΤΡΟΦΟΔΟΣΙΑΣ (mm)

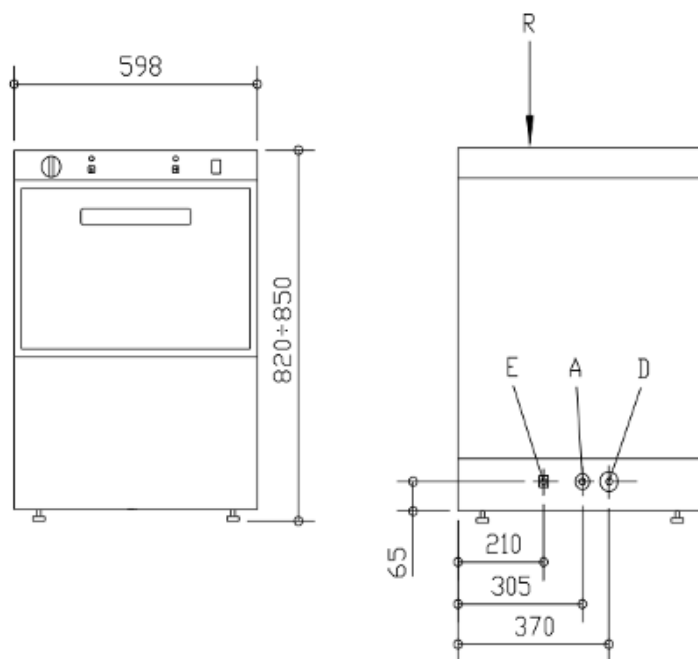

A	D	E	R
Wasseranschluss	Wasserablauf	Anschlusskabel	Anschlussleiste
Water connection	Water drain	Power cord	Connection module
Raccordement d'eau	Évacuation d'eau	Câble d'alimentation	Connecteur
Allacciamento dell'acqua	Scarico dell'acqua	Cavo di alimentazione	Raccordo
Conexión del agua	Salida de agua:	Cable de alimentación	Regleta de bornes
Conexões de água	Drenagem de água	Cabo de alimentação	Conector
Wateraansluiting	Waterafvoer	Aansluitkabel	Aansluitblok
Vandtilslutning	Vandbortledning	Strømkabel	Kobling
Подключение воды	Слив воды	Провод питания	Панель подключения
Su bağlantısı	Su çıkışı	Elektrik kablosu	Terminal bloğu
Przyłącze wody	Odpływ wody	Przewód zasilający	Łączówka
Připojení vody	Odtok vody	Napájecí kabel	Spojka
Priključak vode	Odvod vode	Mrežni kabel	Spojnica
Víz csatlakozás	Vízlefolyó	Hálózati kábel	Csatlakozó
Σύνδεση νερού	Απορροή νερού	Καλώδιο τροφοδοσίας	Ηλεκτρικός σύνδεσμος

Fig. 2

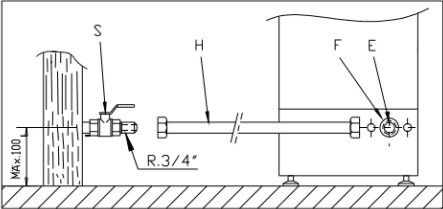

Fig. 3

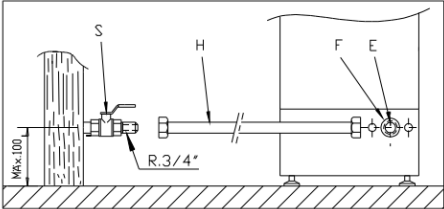

Fig. 4

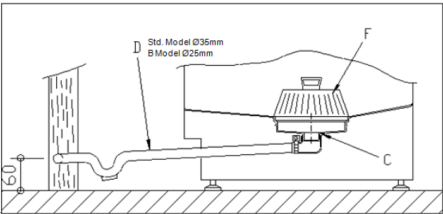

Fig. 5

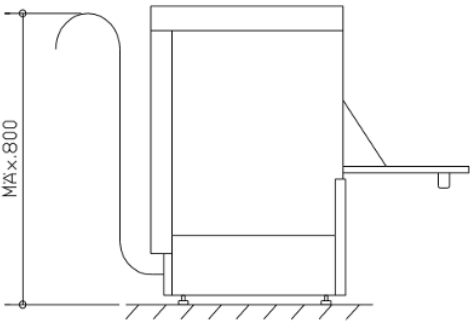
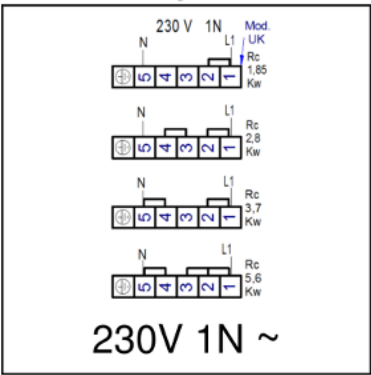

Fig. 6



ENGLISH**Table of contents**

1. Safety.....	28
1.1. Key to symbols.....	28
1.2. 1.2 Safety instructions.....	29
1.3. Proper use	32
2. General information	33
2.1 Liability and Warrantees	33
2.2 Copyright protection.....	33
2.3 Declaration of conformity	33
3. Transport, packaging and storage.....	34
3.1 Delivery check.....	34
3.2 Packaging.....	34
3.3 Storage	34
4. Technical data.....	35
4.1 Technical specification.....	35
4.2 Overview of parts	36
5. Installation instructions	37
5.1 Unpacking.....	37
5.2 Positioning and levelling	38
5.3 Electrical connection	39
5.4 Water connection	40
5.5 Drain connection.....	41
5.6 Cleaning agent dosing pump	41
5.7 Rinse aid dosing pump	42
6. Operation and maintenance instructions	43
6.1 Operation	43
6.1.1 Operating elements	43
6.1.2 Starting the device.....	44
6.1.3 Filling and heating process.....	44
6.1.4 Preparation of dishes.....	45
6.1.5 Starting the washing process	45
6.1.6 Interrupting and finishing the washing process.....	45
6.1.7 Draining the device.....	46
6.1.8 Turning the device off.....	46
6.1.9 Cleaning at the end of the working day	46
6.2 Advice and tips.....	47
6.2.1 Cleaning and maintenance.....	47
6.2.2 Softener and cleaning agent.....	47
6.2.3 Compliance with hygiene regulations	48
6.2.4 Optimum results	48
6.2.5 Interruptions in device operation.....	48
7. Malfunction and alarms.....	49
8. Waste disposal	52



Read this instruction manual before using and keep them available at all times!

This instruction manual contains information about the installation, operation and maintenance of the device and should be consulted as an important source of information and reference guide.

Awareness of the safety instructions and instructions for use in this manual will ensure the safe and correct use of the device.

In addition to the information given here, you should comply with any local Health and safety Controls and generally applicable safety regulations.

The instruction manual forms part of the product and should be kept near the device and easily accessible for anyone carrying out the installation, servicing, maintenance or cleaning.

Please keep these instructions and give them to future owners of the device.

1. Safety

This device is designed in accordance with the presently applicable technological standards. However, the device can pose a danger if handled improperly and inappropriately.

All persons using the device must follow the recommendations and instructions in this instruction manual.

1.1. Key to symbols

In this manual, symbols are used to highlight important safety instructions and any advice relating to the device. The instructions should be followed very carefully to avoid any risk of accident, personal injury or material damage.



DANGER!

This symbol highlights hazards which could lead to injury.



WARNING!

This symbol highlights dangerous situations which could lead to injury or death.



CAUTION!

This symbol highlights dangerous situations which could lead to light injuries, or damage, malfunction, and/or destruction of the device.



NOTE!

This symbol highlights recommendations and information aimed for effective and trouble-free device operation.

1.2. 1.2 Safety instructions

- The device is not intended for use by individuals (including children) with physical or mental disabilities, insufficient experience, and/or insufficient knowledge unless such persons are under the care of a person responsible for their safety or have received instructions regarding appropriate use of the device.
- Children should be observed to ensure that they are not playing with or starting the device.
- Only use the device indoors.
- The device must be operated in correct and safe technical condition only. In case of operational problems disconnect the device from the power supply (pull the plug from the socket) and contact the service company.
- Prevent access of children to the package materials like plastic bags and foamed polystyrene elements. **Suffocation hazard!**

- Only a qualified technician and using original spare parts and accessories should carry out repairs and maintenance of the device. **Do not attempt to repair the device yourself.**
- Do not use any accessory or spare parts that have not been recommended by the manufacturer. These can be dangerous for the user or lead to damages of the device or personal injury, and further, the warranty expires.
- To prevent hazards and to ensure optimum efficiency, no modifications or alterations to the device that are not explicitly approved by the manufacturer may be undertaken.



DANGER! Electric shock hazard!

To avoid the hazard results please follow the safety instructions below.

- Never allow the power cable to come into contact with heat sources or sharp edges. The power cable should not hang over the side of the working surface. Ensure that no one can step on or trip over the cable.
- The power cable must not be folded, bent or tangled, and must always remain fully unrolled. Never place the device or other objects on the power cable.
- Do not cover the cable. Keep away the cable from operating range and do not immerse it into water.
- Check the power cord regularly for damage. Do not use the device if the power cord is damaged. If this cable is damaged, it must be replaced by customer service or a qualified electrician in order to avoid dangers.

- The supply cable must be disconnected from the socket only by pulling the plug.
- Never carry or lift the device by the supply cable.
- In any case do not open the device housing. In case of electrical or mechanical modifications the **electric shock hazard** will occur.
- Do not use any acid agents and make sure no water ingresses the device.
- **Never** operate the device with moist hands or standing on wet floor.
- Remove the plug from its socket:
 - when the device is not used,
 - in case of anomalies during operation,
 - before cleaning.



CAUTION!

In order to avoid any damages to the device follow the instructions below:

- To clean the device, **NEVER** use cleaning agents, such as acids, solvents or chlorine-based washing fluids, to avoid damaging components of the washing machine.
- The device is designed for operation at temperatures from 5 °C to 40 °C, which needs to be considered when selecting a place of installation.
- Use only dishwasher baskets, cleaning agents and rinse aids recommended by the manufacturer.

1.3. Proper use



CAUTION!

The device has been designed and built for commercial use and should be operated only by qualified personnel in kitchen facilities.

The operational safety of the device is assured only in case of proper use, according to the operation manual.

All technical activities like installation and maintenance must be performed by the qualified service personnel only.

The dishwasher is designed only for washing plates, glasses and cooking ware (pots, pans, etc.).

Cleaning of other objects which were not mentioned above is strictly forbidden.



CAUTION!

Any use going beyond the intended purpose and/or any different use of the device is forbidden and is not considered as conventional.

Any claims against the manufacturer or his authorized representative as a consequence of experiencing damages resulting from unconventional use are impossible.

The operator is liable for all damages resulting from inappropriate use.

2. General information

2.1 Liability and Warrantees

All the information and instructions in this manual take into account standard safety regulations, current levels of technical engineering as well as the expertise and experience we have developed over the years.

The instruction manual was translated with all due care and attention. However, we do not accept liability for any translation errors. The German version of this instruction manual is definitive.

If the delivery consists of a special model, the actual scope of delivery may differ from the descriptions and illustrations in this manual. This is also the case for special orders or when the device has been modified in line with new technology.



CAUTION!

Read this manual carefully and thoroughly before any operation of the device, and especially before turning it on!

Manufacturer **is not liable** for any damages or faults caused by:

- violation of advice concerning operation and cleaning;
- use other than designed;
- alterations made by user;
- use of inadequate spare parts.

We reserve the right to make technical changes for purposes of developing and improving the useful properties.

2.2 Copyright protection

The instruction manual including any texts, drawings, images or other illustrations is copyright. No part of this publication may be reproduced, transmitted or used in any form or by any means without permission in writing from the manufacturer. Any person who commits any unauthorized act in relation to this publication shall be liable to claims for damages. All rights reserved.



NOTE!

The contents, texts, drawings, pictures and any other illustrations are copyright and subject to other protection rights. Any person unlawfully using this publication is liable to criminal prosecution.

2.3 Declaration of conformity



The device complies with the current standards and directives of the EU. We certify this in the EC declaration of conformity. If required we will be glad to send you the according declaration of conformity.

3. Transport, packaging and storage

3.1 Delivery check

Please check the delivery upon completeness and transport damage immediately after receipt. In case of visible damage do not accept or accept the delivery with reservation only.

Note the extent of damage on the carrier's bill of delivery. Trigger off the complaint.

Hidden damages should be reclaimed immediately after notice, as claims for damages can only be asserted within the effective period for complaints.

3.2 Packaging

Please do not throw away the covering carton of your device as it might be useful for storage purposes, when moving or, in case of damages, when the device must be sent back to a repair center. The outer and inner packing material should be removed completely from the device before installation.



If you liked to dispose the packing, consider the regulations applicable in your country. Supply re-usable packing materials to the recycling.

Please inspect the device upon completeness. In case any part is missing please contact our customer service center immediately.

3.3 Storage

Keep the package closed until installation and under consideration of the outside indicated positioning- and storage markings.

Packages should be stored under consideration of the following:

- do not store outdoors,
- keep it dry and dust-free,
- do not expose it to aggressive media,
- do not expose it to direct sunlight,
- avoid mechanical shocks and vibration,
- in case of longer storage (> 3 months) make sure you check the state of the packaging and the parts regularly, if required refresh or renew.

4. Technical data

4.1 Technical specification

Description	Dishwasher E500 LPR
Code-No.:	110510
Material:	Stainless steel
Model:	<ul style="list-style-type: none">▪ Run-time: 120 seconds▪ Output / hour: max. 30 baskets▪ Number of washing programs: 1▪ Tank volume: 25 litres▪ Water consumptions at 2 bars: 2.7 litres▪ Water pressure: 2 – 3.5 bar▪ Water supply: G 3/4"▪ Maximum water temperature at the inlet: 60 °C▪ Water outlet: Ø 20 mm▪ Tank heater: 2.8 kW▪ Boiler heater: 2.8 kW▪ Drain pump equipped with damping mat▪ Non-return valve▪ Cleaning agent dosing pump▪ Rinse aid dosing pump▪ Double-walled door▪ Possibility to built-in▪ Dry-run protection▪ Safety thermostat▪ Door contact switch▪ Device connection: Ready to plug in▪ ON/OFF switch▪ Indicator lights: On/Off, heating
Power supply:	3.4 kW / 220-230 V 50 Hz
Dimensions:	W 600 x D 640 x H 820 mm
Weight:	53.6 kg
Accessories:	<ul style="list-style-type: none">▪ 1 plate holder (W 500 x D 500 x H 110 mm)▪ 1 universal basket (W 500 x D 500 x H 110 mm)▪ 1 cutlery holder (W 105 x D 105 x H 130 mm)

We reserve the right to implement the technical modifications!

4.2 Overview of parts

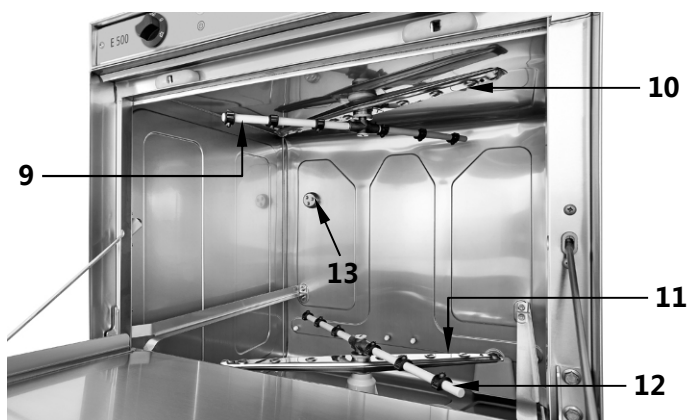
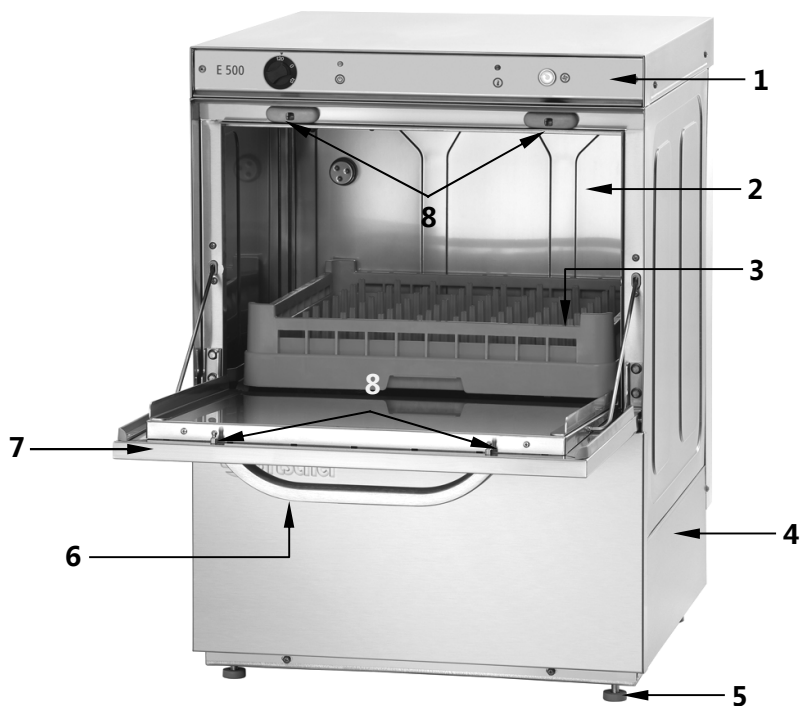

Fig. 7

Description of drawings on page 36

- | | |
|--------------------------|--------------------|
| 1 Control panel | 8 Door lock |
| 2 Wash-tank | 9 Upper rinse arm |
| 3 Dishwasher basket | 10 Upper wash arm |
| 4 Housing | 11 Lower wash arm |
| 5 Height-adjustable feet | 12 Lower rinse arm |
| 6 Door handle | 13 DVGW valve |
| 7 Device door | |

5. Installation instructions



CAUTION!

Positioning and installation, as well as repairs or fitting can be performed only by the authorised technical service in compliance with the applicable national law.

Incorrect installation, setting, operation, maintenance or misuse of the device may lead to personal injury or property damage.

5.1 Unpacking

- Unpack the device and make sure it was not damaged during the transport. Otherwise, immediately notify the supplier and forwarding agent about the identified damage.
In case of any doubts, do not use the device until the extent of damage is determined.



CAUTION!

Keep all packaging material (plastic, Styrofoam, clamps, etc.) outside the reach of children as this may be a potential source of danger.

- The device can be moved only with the use of a fork lift or similar equipment to avoid damaging the device's structure. Place the device at the installation site and unpack there.
- Place all packaging material which is fully recyclable in appropriate waste containers.

5.2 Positioning and levelling



CAUTION!

Before the device's installation, carefully check the conditions of the place in which the device is to be placed to exclude any subsequent damages which may appear during operation.

- Put the device on an even, stable, dry and waterproof surface which is resistant to high temperature.
- **Never** place the device on an inflammable surface.
- Do not place the device near open flame, electric heaters or other heat source.
- **Never** put the device in a moist or wet area.
- Place the device so that the plug is easily accessible so as to quickly disconnect the device if the need arises.
- Before the first use, remove the protective foil from the device. Remove the foil slowly not to leave glue residues. Remove possible glue residues with appropriate solvent.



CAUTION!

Never remove the nameplate and warning signs from the device.

The device is equipped with height-adjustable feet. The desired height can be achieved by rotating the feet.

Correct levelling is necessary to ensure optimum performance of the device.

Bearing capacity of the floor on which the device is placed must be sufficient for the weight of the device.

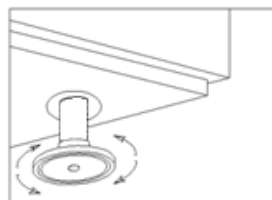

Fig. 8

5.3 Electrical connection



DANGER! Electric shock hazard!

Incorrect installation of the device may cause injury!

Before the installation, compare current parameters of the local power grid with the device's power supply parameters (see the rating plate). Connect the device only if the above mentioned parameters are consistent with each other!

- The device can be connected to the power supply only by a certified professional installer, while taking into account the applicable standards in the country of installation.
- The device is ready for installation and equipped with a power cord of 1.3 m in length.
- A multipolar switch with at least 3 mm opening should be connected near the device, and should be easily accessible. This device is designed for switching the device off in case of installation, repair, cleaning or maintenance work conducted on the device. This switch must be equipped with fuses adjusted for the rated voltage of the device. A properly selected magnetic thermal switch may be an alternative to the above mentioned switch.
- The device must be properly connected to the equipotential bonding circuit. The manufacturer shall not be liable for any damages caused by failure to meet this obligation.
- The power supply circuit with the socket must be protected by the fuse of at least 16A. Connect the device only to the single wall socket with ground contact; do not use any extension cords or power strips.



CAUTION!

The manufacturer shall not be liable for any personal injury or device damage in case of failure to comply with provided factory specifications or incorrect installation.

5.4 Water connection

Use only hoses supplied with the device (never use second-hand hoses).

Before connecting the device to the water supply system, the analysis of water quality should be performed. Manufacturer recommends the following parameters of water quality:

Water temperature (T):	max. 60	Total water hardness:	5 - 10 °fH (French degrees)
pH value:	6.5 – 7.5		7 - 14 °fH (English degrees)
Physical contamination:	Ø < 0.08 mm		9 - 18 °fH (German degrees)
Chlorides:	max. 150 mg/l	Conductivity:	400 – 1,000 µS/cm
Chlorine:	0.2 – 0.5 mg/l		

If the water hardness exceeds 9 - 18 °dH (German degrees of hardness), the use of water softener is required.

Furthermore, when checking the water quality, the pressure of water supply network must be taken into account. This parameter determines the correct operation of the device.

Water pressure should correspond to the following values:

Water pressure	MIN				MAX.			
	bar	kPa	kg/cm ²	psi	bar	kPa	kg/cm ²	psi
	2	200	2,03	29	3.5	350	3.56	50.76

If the water pressure is above the recommended value, it is required to install the reducing valve between the water supply network and the water connection of the device (**fig. 2 at the beginning of the operating manual**).

If the water pressure is below the recommended value, it is required to install a booster pump between the water supply network and the water connection of the device (**fig. 3**).

Fig. 2. Direct connection of the hose to the water supply installation.

Fig. 3 Connection of the booster pump

S	Shut-off valve	H	Hose
E	Solenoid valve	B	Booster pump
F	Filter		

To properly install the device, please follow the instructions below:

- water connection must be equipped with a shut-off valve to block the water supply;
- pressure in the water supply network must be within the range of recommended values;
- in order to optimize the device operation, the manufacturer recommends that the temperature at the water inlet to the device should be within the ranges provided in the following table;

Cold water	Hot water
5 °C - 25 °C	40 °C - 60 °C

- in case of using hot water, the water temperature cannot exceed 60 °C;
- the device is equipped with a threaded connection ($\frac{3}{4}$ ").

5.5 Drain connection

The water must be drained freely from the device. Due to this, the drain hose must be located below the device in a way which makes the draining of water possible (**Fig. 4**).

The device is equipped with a drain pump, which pumps out the water after washing when setting the control knob **(A)** to **(G)** position (fig. 9 page 43).

In such a case, the height of 800 mm cannot be exceeded (**Fig. 5**).

Fig. 4. Drain mounting.

Fig. 5. Setting of the drain height through the drain pump.

5.6 Cleaning agent dosing pump

The device is equipped with a cleaning agent dosing pump. Thanks to his dosing device the appropriate quantity of cleaning agent is added to the wash-tank each time.

Operation: a cleaning agent dosing pump is activated when the device collects water during the filling process.

Setting: a quantity of cleaning agent should be set up during the installation, because only this way the user may use all washing features in an optimum way from the very beginning.



CAUTION!

A selection of the cleaning agent and setting of the cleaning agent dosing pump should be entrusted to the qualified technician who has experience with chemical products, to achieve the most efficient washing effects.

5.7 Rinse aid dosing pump

The device is equipped with the rinse aid dosing pump. Thanks to this dosing device, the appropriate quantity of rinse aid is added to the wash-tank each time.

Operation: Thanks to this dosing device, the liquid rinse aid is absorbed as soon as the programmer issues a command for rinsing. A SEPARATE TANK is filled with liquid rinse aid which is then mixed with rinsing water flowing from the boiler.

Setting: this dosing device should be set up during the installation, because only this way the user may use all washing features in an optimum way from the very beginning. The setting must be properly adjusted depending on the selected rinse aid and hardness of the available water.



CAUTION!

A selection of the rinse aid and setting of the rinse aid dosing pump should be entrusted to the qualified technician who has experience with chemical products, to achieve the most efficient washing effects.

6. Operation and maintenance instructions



CAUTION!

Before the first use, read this operating manual carefully, because it includes instructions regarding safety and use of the device.

Store this operating manual at an easily accessible place near the device.

The defective installation, operation errors and maintenance and cleaning mistakes as well as any modifications may cause the incorrect operation, damages and injuries.

6.1 Operation

6.1.1 Operating elements

Fig. 9

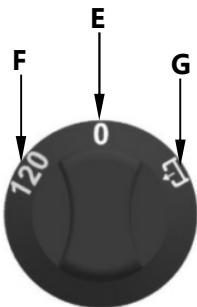

- A** Control knob
- B** ON indicator light (blue)
- C** Standby indicator light (green)
- D** START button with an indicator light
- E** OFF position
- F** Setting of the 120 sec washing cycle
- G** Setting the draining function

6.1.2 Starting the device

Before switching the device on make sure that the following conditions are met:

- Water shut-off valve is open.
- Water supply is ensured.
- All filters are installed in the intended places.
- Overflow is in the right place.
- Device door is closed.

To switch the device on, turn the control knob **(A)** from “**0**“ **(E)** position to “**F**“ position. (Fig. 9, page 43). ON indicator light (blue) comes on.

6.1.3 Filling and heating process

Filling process begins after starting the device. First the rinsing boiler is filled in, and then the wash-tank. Filling process may take up to a few minutes. As soon as the wash-tank is filled in, the heating process of both the boiler and the wash-tank starts.

Although it would be now possible to start the washing process, the manufacturer does not recommend this, because the water inside the device has not reached the optimum temperature yet. As soon as the device reaches the optimum temperature for appropriate dish washing, the user is informed about it by standby indicator light (green) coming on **(C)**.

The device must reach the temperature of 85 °C in the rinsing boiler and 60 °C in the wash-tank. It is recommended that the water in the device should be changed every 40/50 washing cycles or twice a day.



**To start the filling process, the device door must be fully closed.
Due to safety reasons, the device cannot be filled in with open door.**

The device is equipped with a safety thermostat inside the boiler and another safety thermostat inside the wash-tank. In case of the failure of any of the main thermostats, the heating process is stopped.



NOTE!

After a longer break in the device operation, during the first heating process on a given day, values of temperatures for the device may exceed the previously provided values, which is quite normal. However, if during the heating process the water vapour is coming out of the rinse arm nozzle, please contact the technical service.

6.1.4 Preparation of dishes

Dishes to be washed must be prepared in the following way:

- Before placing the dishes in the basket, remove bigger food remains from the dishes.
- Wash glasses first.
- Always place glasses face down.
- Place the plates in plate holders in the dishwasher basket.
- Place the cutlery in the cutlery holder with handles facing down. Cutlery of various sized should be mixed.
- Insert the cutlery holders to the basic dishwasher baskets.

When filling the dishwasher baskets pay attention to the following:

Max. glass height: 280 mm, max. plate height: 320 mm

6.1.5 Starting the washing process

Before starting the washing process, slide the appropriate basket with dishes into the device. To start the washing process, turn the control knob **(A)** to “F” position, Fig. 9, page 43 (120 sec washing cycle).

Close the door of the device and to start the washing cycle press the START button **(D)**.

6.1.6 Interrupting and finishing the washing process

The washing process may be interrupted in one of the following two ways:

- Switch the device off (turn the control knob **(A)** to OFF “0” position) → The washing process is fully interrupted.
- Open the device door → the washing process is interrupted; in order to continue the washing process close the door and press the START button **(D)**.

After finishing the washing process, the basket with dishes may be removed.

Dishes are dried by evaporation. Remove dishes from the basket only with clean hands. Makes sure not to burn your hands, because the dishes are still hot.

6.1.7 Draining the device

The device is equipped with the drain pump. Perform the following steps to drain the device with the use of a drain pump:

- Remove the overflow.
- Using the control knob **(A)** select the drain function (G) (Fig. 9, page 43).
- Close the dishwasher door and press the START button **(D)** (Fig. 9, page 43) to start the cycle; the draining process starts automatically.
- When the draining process ends (duration ca. 160 seconds), the device may be switched off.



To ensure that the draining process proceeds correctly with the use of a drain pump, the drain hose must be located at the appropriate height (not higher than 800 mm).

6.1.8 Turning the device off

To switch the device off, turn the control knob **(A)** to OFF “0” position.

Do not switch the device off during the washing process, because the dishes inside the dishwasher will not be washed properly.

6.1.9 Cleaning at the end of the working day

At the end of the working day, thoroughly clean filters, wash arms, rinse arms, as well as other accessories.

Thorough cleaning is the most important condition for maintaining long service life of the device. Proper cleaning and disinfection of the dishwasher is the prerequisite for effective washing of dishes.

6.2 Advice and tips

To take advantage of all the features offered by the dishwasher, carefully read the following advice and tips and follow them.

6.2.1 Cleaning and maintenance

To ensure long service life of the device, clean it regularly.

- At the end of the working day always remove all food residues from the device.
- Never use abrasive, corrosive or caustic cleaning agents, or solvents and cleaning agents based on chlorine or petrol derivatives.
- Do not clean the dishwasher with water jets.
- Wash only dishes, glasses or pots and pans etc.
- Check the wash / rinse arms to make sure they rotate correctly.
- Before starting the washing process, always check the salt, rinse aid and cleaning agent levels.

Twice a year, a technical service should carry out the following inspections:

- water filters cleaning;
- descaling of heating resistors;
- checking of gaskets condition;
- checking of condition of all other components;
- setting of dosing devices;
- checking of the clamps of dosing devices;
- checking of the power cord. To prevent hazards, a defective power cord may be replaced only by the qualified electrician while observing all safety measures.

Descaling

Add appropriate quantity of the descaling agent to the wash-tank (per 25 litres of water) and run 1-2 washing cycles.

Drain the device (Chapter. 6.1.7).

Refill the wash-tank with water, and then run 2-3 washing cycles without any dishes. Finally, pump out all the water to remove all residues of the descaling agent.

6.2.2 Softener and cleaning agent

Use only special cleaning agents designed for dishwashers for dishes intended for industrial use. Do not use any foaming cleaning agents. Never use cleaning agents designed for household use.

When replacing the rinsing aid or cleaning agent, new setting must be entered which may be performed only by a qualified technician.



WARNING!

While using the chemical substances, follow relevant safety instructions. Wear protective clothes, gloves and glasses. Do not mix any cleaning agents with one another.

6.2.3 Compliance with hygiene regulations

- Do not touch clean dishes with dirty or greasy hands to avoid contaminating dishes.
- To fully dry the dishes, use clean, sterilized kitchen towels.
- It is recommended using the device always after reaching an optimum temperature to ensure that washing and disinfection also produce optimum results.
- Empty the wash-tank at least twice a day or every 40/50 washing cycles.

6.2.4 Optimum results

To achieve optimum results when washing dishes, follow the instructions presented below:

- Wash dishes only when the device is ready for work.
- Dosing devices must be properly set.
- Always keep the dishwasher clean.

6.2.5 Interruptions in device operation

If the device is not used for any lengthy periods (holidays, interruptions at work etc.), follow the instructions presented below:

- Fully drain the device, including the boiler.
- Thoroughly clean the device.
- Leave the dishwasher door open.
- Close the water shut-off valve.
- Switch off the main ON/OFF switch.
- If there is a risk of temperature going down below zero degrees centigrade, ask the technical service to secure the device against frost.

7. Malfunction and alarms



WARNING!

Never interfere with the electrical components when they are energized and there is a shock hazard.

In case of malfunction, immediately disconnect the device from the power supply. Before contacting the customer service department or vendor check the troubleshooting table below.

Problem	Possible reason	Solution
The device cannot be turned on	No power supply from the mains.	Check whether the automatic safety device has not been triggered.
	Melted fuses.	Contact the service company.
	The device is not switched on through the main switch.	Close the main switch.
The device does not absorb water.	Water supply valve closed.	Open the water supply valve.
	Rinse arm nozzles clogged.	Clean the arms and check the rinse arms for limestone.
	Solenoid valve filter clogged.	Contact the cleaning service.
	Rinse pump failure.	Contact the service company.
	Pressure switch error.	Contact the service company.
Washing results are not satisfactory.	Wash arms are clogged.	Thoroughly clean the wash arms.
	Not enough washing agent added.	Contact the service company to order new setting of dosing devices.
	Filters are dirty.	Thoroughly clean the filters

Problem	Possible reason	Solution
Washing results are not satisfactory.	Foaming.	Inappropriate cleaning agent.
		Contact the service company for help to select correct cleaning.
	Temperature in the wash-tank is below 50 °C.	Thermostat failure or thermostat is not set correctly. Contact the service company to request the repair.
	Washing cycle is too short for the heavily soiled dishes.	Select a longer washing cycle.
	Washing water is very dirty.	Drain the wash-tank and fill in with clean water.
Dishes (pots, pans, etc.) are not properly dried.	No rinse aid	Add the liquid rinse aid to the tank.
	Not enough liquid rinse aid	Contact the service company to repair the rinse aid dosing pump.
	Dishes stayed too long in the dishwasher.	Remove the dishes from the dishwasher immediately after the completed washing cycle and leave them for drying in the air.
	Rinsing temperature is below 80 °C.	Contact the service company to fix the problem.
Streaks and spots on dishes.	Too much rinse aid.	Contact the service company to request setting of the rinse air dosing pump.
	Too hard water.	Check the hardness of water and if possible immediately run the regenerative cycle.

Problem	Possible reason	Solution
The device stops during operation.	Power supply overload.	Contact the service company to request proper adjustment of the electrical connection.
	Dishwasher's safety devices has been triggered.	Activate the safety device again and if it triggers again, contact the service company.
The device stops during the washing and starts refilling water.	Clogged pressure switch.	Drain and thoroughly clean the wash tank.
	Pressure switch failure.	Contact the service company to order the replacement.
	Overflow incorrectly installed.	Install the overflow correctly.
The washing cycle does not start.	Incorrectly closed dishwasher door.	Close the door. Contact the service company if the door cannot be closed properly, and then correctly set the tensioning device.
	Door micro switch failure.	Contact the service company to order the replacement.
Draining of the device cannot be successfully completed.	The device is not set properly.	Set the device properly, contact the service company in case of any doubts.
	Pressure switch failure.	Contact the service company to order the replacement.

If you cannot remove the malfunctions:

- do not open the body,
- notify the customer service point or contact the sales agent, while providing the following information:
 - type of malfunction;
 - article and serial number (rating plate at the rear of the device).

8. Waste disposal

Discarding old devices

At the end of its service life the discarded device has to be disposed in accordance with the national regulations. It is advisable to contact a company which is specialized in waste disposal, or just contact the local disposal service in your community.



WARNING!

To exclude any abuse and the dangers involved make the waste device unfit for use before disposal.

For that purpose disconnect device from mains supply and remove mains connection cable from the device.



CAUTION!



For the disposal of the device please consider and act according to the national and local rules and regulations.